

City of Ipswich

# Indigenous Culture Interpretative Sign Types

May 2016

# Foreword

This manual describes the signage system to be implemented throughout the City of Ipswich.

The aim of this signage system is to ensure that external signs meet quality standards of aesthetic appeal, uniformity and simplicity, while being highly functional in providing the information necessary and in accordance with current BCA regulations and Australian Standards.

This manual is controlled by the City of Ipswich and serves to ensure consistent use when implementing new Indigenous Culture signage throughout the city.

Due to the future development plans for Ipswich, this manual will be reviewed periodically to maintain accuracy and to capture changing signage needs.



# Contents

City of Ipswich, Indigenous Culture Signage Manual

<b>Introduction</b>	<b>2</b>
<b>Signage Ordering Process</b>	<b>3</b>
<b>Graphic Standards</b>	<b>8</b>
Using the Council Logo and Totem	
Colour Palettes	
Typography	
Graphic Elements	
<b>Indigenous Culture Sign Types</b>	<b>12</b>
IC-1 Signage Shelter – 4 Bays	
IC-2 Signage Shelter – 1 Panel	
IC-3a Major Interpretation Sign	
IC-3b Minor Interpretation Sign	
IC-4 Dedication Sign	
<b>Appendices</b>	<b>22</b>
Appendix – A. General Structural Specification	
Appendix – B. Form 15	

# Introduction

The purpose of the Indigenous Culture Signage Manual is to provide specific guidance to both Council staff and external suppliers (such as graphic designers and printers) on the use of the City of Ipswich Indigenous Culture Signage. This includes its visual elements, the application and use of these elements, and the provided templates. The Indigenous Culture Signage Manual is a stand-alone document to address signage exclusively with Council's city areas.

This Manual and the examples shown within have been designed as a model and follow the accepted corporate graphics standards. When followed properly, a consistent and successful style will be preserved — a style which provides a distinct visual identity for all signage within the City of Ipswich.

## Amendments to the Manual

It is understood that this Manual is by nature a living document. It will necessarily evolve to meet new, unforeseen circumstances and contexts. To this end, should the rules specified in the current edition of the Manual not address a particular circumstance or user need, specific guidance should be sought from the Chief Operating Officer of the Works, Parks & Recreation Department. A new rule would as a result, be created.

## Update Register

May 2016      First release

## Scale

Sign diagrams shown in this Manual may not be to scale, unless otherwise specified.

# Sign Ordering Process

# Signage Order Form

City of Ipswich, Indigenous Culture – Page 1 of 2

## Details

Contact Name	Phone
Project Description	Fax
Job Code	Email
Sign Location	<input type="radio"/> Quote <input type="radio"/> Order

## Level of Signage

Citywide (Level 1)  District (Level 2)  Local (Level 3)

*(Select sign type over page in consultation with ICC signage department)*

## Purpose

Interpretative

## Support Information

Sponsor / partner logo *(specify)*

Sponsor / partner message *(write)*

## Maps

Maps Required

## Images

Images Required

**Message** - List details or attach separate page / Word format document

<b>panel i.</b>	Headline	Sub Head
	Body Text <i>(please attach any extra text)</i>	

<b>panel ii.</b>	Headline	Sub Head
	Body Text <i>(please attach any extra text)</i>	

<b>panel iii.</b>	Headline	Sub Head
	Body Text <i>(please attach any extra text)</i>	

# Signage Order Form

City of Ipswich, Indigenous Culture – Page 2 of 2

Please select the required sign type with a tick in the circle

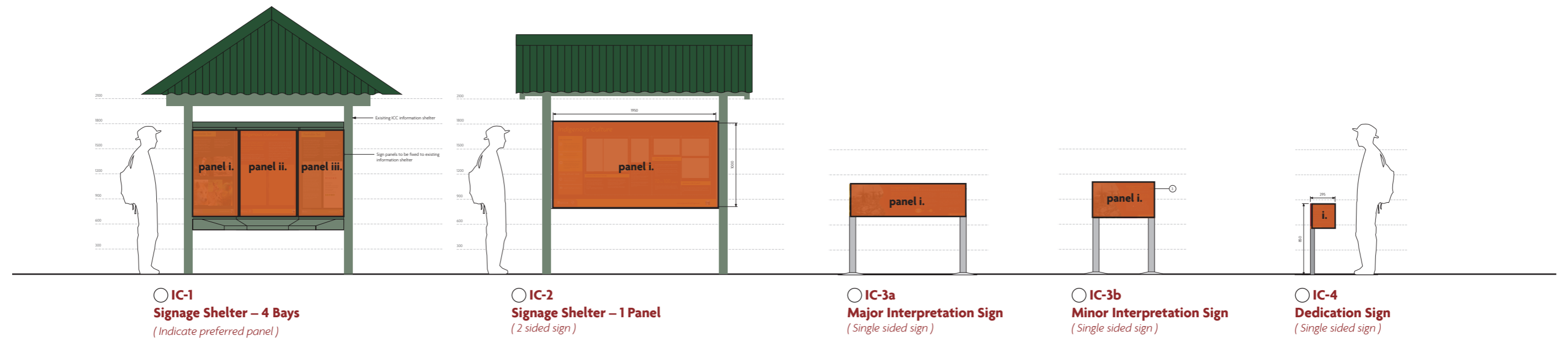

# Graphic Standards



# Graphic Standards

Indigenous Culture Colour Palette and  
Using the Council Logo and Totem Tab Device

## City of Ipswich Logo and Totem Tab

The combined Logo and Totem Tab device is to be used only for ICC Indigenous Culture signage purposes. The Tab is applied to all Indigenous Culture signage.

## ICC Totem

The ICC Totem is to appear as per layouts contained in this manual. Where uncertainty as to the placement of Totem occurs, final signoff is to be sought from the ICC Indigenous Land Use Partnerships Coordinator.

## Proportions

It is important to retain a consistent relationship between the size of the Logo and Totem Tab and the overall sign.

## Field Requirements

Always allow generous space around the Logo and Totem Tab in all signage applications. No text is to encroach on the space as specified above.

## Alignment

Wherever possible, the Logo and Totem Tab is to always be positioned on the lower left base of identification signage. However, in certain instances of interpretative signage, it may be deemed that a right alignment of the Logo and Totem Tab is more appropriate to the overall design, with the curved corner reflected accordingly.

Furthermore, in extreme circumstances where the logo would otherwise be obscured by structural elements such as rivets, it is permissible to extend the Tab to avoid logo obstruction.

## Colour Selection

The colour of the Logo and Totem Tab is to be consistent with the Indigenous Culture palette, which has been adapted from Ipswich's local Indigenous murals.



## Ipswich Mural Reference

Nathanael Bonner (Jagera)  
Colleges Crossing Recreation Reserve



ICC Logo and Totem to be present on all Indigenous Culture signage, as per procedure.

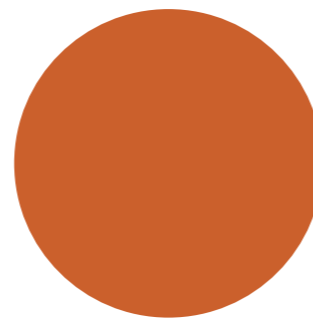

### Pantone 7583 C

Paint = Dulux Orangest  
Vinyl = Arlon Calon 2100 -  
Terra Cotta 280  
CMYK = 0 - 69 - 98 - 12

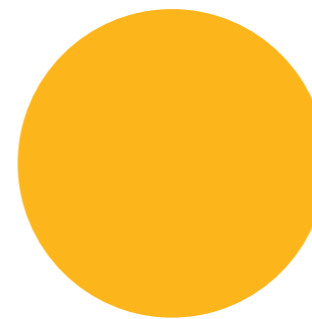

### Pantone 1235 C

Paint = Dulux Gold Rush  
Vinyl = Arlon Calon 2100 -  
Yellow 06  
CMYK = 0 - 19 - 79 - 0

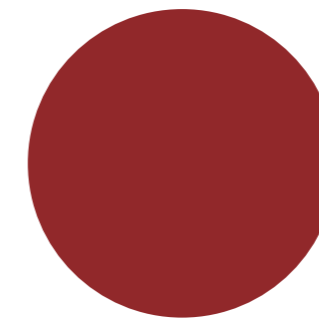

### Pantone 7623 C

Paint = Dulux Red Blooded  
Vinyl = Arlon Calon 2100 -  
Cardinal Red 42  
CMYK = 0 - 97 - 87 - 53

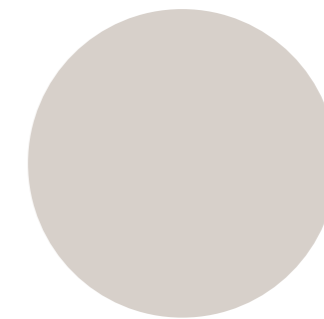

### Warm Gray 1 C

Paint = Dulux Subdue  
Vinyl = Arlon Calon 2100 -  
Palm Oyster Gray 70  
CMYK = 3 - 3 - 6 - 7

## Graphic Standards

Indigenous Culture Typography and  
Using the Indigenous Culture Logotype

### Headings/Titles

Agenda Medium is a robust sans serif font which ensures a high degree of legibility across various applications. It is the primary font for City of Ipswich Indigenous Culture signage.

### Body Copy

Agenda Light is to only be used in instances where large areas of text is necessary i.e. paragraphs of text on interpretative signage.

The above typefaces are also available as italic versions. The Indigenous Culture interpretative signage uses Agenda Medium Italic for its logotype and body text introduction. It is recommended to use italics sparingly for optimum legibility.

### Deciding Text Size

All text should be scaled to suit the application. Use your discretion when deciding upon appropriate sizing. The minimum size at which the fonts are to be used is 10pt. The size is only to be used in select instances where there is a large amount of information displayed within a small area such as the details on interpretative maps.

### Line Spacing/Leading

For optimum legibility, it is advised that ample line space/leading be left between each line of text. All titling text on identification signage must retain a 1:1 X-height to leading ratio i.e. text with a size of 200 pt must be spaced with 200 pt leading. The leading for large areas of body text may be more generous, with a X-height to leading ratio that is greater than 1:1. i.e. this paragraph.

### Tracking/Letter Spacing

For optimum legibility, it is advised that tracking/letter spacing be added for all signage applications.

ABCDEFGHIJKLMNOPQRSTUVWXYZ  
abcdefghijklmnopqrstuvwxyz  
1234567890

Agenda Medium Italic

---

*Indigenous  
Culture*

Stacked Logotype ( *portrait sign panel formats* )

---

*Indigenous Culture*

Inline Logotype ( *landscape sign panel formats* )

---

# Graphic Standards

## Indigenous Culture Graphic Elements

### Dot Divide

Adapted from the Natural Areas Signage dividing line style, the oversized *Dot Divide* references Ipswich's local indigenous murals, and provides a distinctive element to separate the heading logotype from the sign panel body copy.

The weight and style should be adapted to suit the sign panel dimensions. The sign type *IC-3a* uses a 20 pt rounded stroke weight, and 40 pt dash gap.

### Flow Wave — *ICC\_IC\_Flow-Wave.eps*

Adapted from Ipswich's local indigenous murals, the *Flow Wave* should be used as an image framing element to soften any hard vertical edges, with a reduced opacity to suit the sign panel's content and image context.

### Hand Stencil — *ICC\_IC\_Hand-Stencil.eps*

Adapted from Ipswich's local indigenous murals, the *Hand Stencil* should be kept life-size where possible, and aligned to the top right of the sign panel.

Used primarily as a background support to the sign panel content, the opacity should always be reduced when complex text and graphics are overlaid.



1.

2.

3.

Ipswich Mural Reference



Dot Divide



Flow Wave



Hand Stencil

### 1. Dot Divide

Lesley Kanofski (Ugarapul) and Evelyn Dodds (Ugarapul)  
Bob Gamble Park — River Heart Parklands

### 2. Flow Wave

Nathanael Bonner (Jagera)  
Colleges Crossing Recreation Reserve

### 3. Hand Stencil

Rory Bonner (Jagera)  
Bob Gamble Park — River Heart Parklands

# Sign Types

## Indigenous Culture

### Interpretation Signs

- IC-1 Signage Shelter – 4 Bays
- IC-2 Signage Shelter – 1 Panel
- IC-3a Major Interpretation Sign
- IC-3b Minor Interpretation Sign
- IC-4 Dedication Sign

Unless otherwise noted all dimensions in millimetres. Use figured dimensions in preference to scaling. Contractor to confirm all dimensions and details on site prior to manufacture.

Attention  
Due to this reproduction process the colours shown in this drawing may not exactly represent the final product colour.

REFERENCE DOCUMENTS  
This drawing must be read in conjunction with the following documents:  
- Sign Location Plan  
- Specification  
Contact ICC Project Manager for details.

GENERAL CONSTRUCTION NOTES  
• Drawings show design intent. Any changes to specification which affects design intent must be approved by ICC.  
  
• All structural members, fixings and/or footings to be confirmed by sign maker's engineer.

Construction Details  
1. 1.6mm thick aluminium sign panels. To be primed and all visible edges painted to match DULUX Red Blooded. 3mm radius on all corners. Fixing points to be pre drilled.

2. Full colour digital print onto external grade 5-7 year polymeric vinyl with anti graffiti polyvinyl fluoride film over. Cut vinyl to match fixing points to prevent damage to print.

3. Sign panel fixed to column shelter stainless steel, security style, button head machine screws.

All construction details to be coordinated with signage shelter details.

Graphics Detail  
FONT  
Agenda - Medium Italic  
Agenda - Light

SIZE  
Panel Heading = 37mm X cap height  
Body Copy = 11mm X cap height

COLOUR  
Refer to graphic standards for details



Typical Elevation

Scale 1:20



Graphic Layout

Scale 1:10

Unless otherwise noted all dimensions in millimetres. Use figured dimensions in preference to scaling. Contractor to confirm all dimensions and details on site prior to manufacture.

**Attention**

Due to this reproduction process the colours shown in this drawing may not exactly represent the final product colour.

**REFERENCE DOCUMENTS**

This drawing must be read in conjunction with the following documents:

- Sign Location Plan
- Specification

Contact ICC Project Manager for details.

**GENERAL CONSTRUCTION NOTES**

- Drawings show design intent. Any changes to specification which affects design intent must be approved by ICC.

- All structural members, fixings and/or footings to be confirmed by sign maker's engineer.

**Construction Details**

1. 1.6mm thick aluminium sign panels. To be primed and all visible edges painted to match DULUX Red Blooded. 3mm radius on all corners. Fixing points to be pre drilled.

2. Full colour digital print onto external grade 5-7 year polymeric vinyl with anti graffiti polyvinyl fluoride film over. Cut vinyl to match fixing points to prevent damage to print.

3. Sign panel fixed to column shelter stainless steel, security style, button head machine screws.

All construction details to be coordinated with signage shelter details.

**Graphics Detail**

**FONT**

Agenda - Medium Italic  
Agenda - Light

**SIZE**

As shown

**COLOUR**

Refer to graphic standards for details



Typical Elevation

Scale 1:20

Unless otherwise noted all dimensions in millimetres. Use figured dimensions in preference to scaling. Contractor to confirm all dimensions and details on site prior to manufacture.

**Attention**  
Due to this reproduction process the colours shown in this drawing may not exactly represent the final product colour.

**REFERENCE DOCUMENTS**  
This drawing must be read in conjunction with the following documents:  
- Sign Location Plan  
- Specification  
Contact ICC Project Manager for details.

**GENERAL CONSTRUCTION NOTES**  
• Drawings show design intent. Any changes to specification which affects design intent must be approved by ICC.

• All structural members, fixings and/or footings to be confirmed by sign maker's engineer.

**Construction Details**  
1. 1.6 mm thick aluminium sign panels. To be primed and all visible edges painted to match DULUX Red Blooded. 3mm radius on all corners. Fixing points to be pre drilled.

2. Full colour digital print onto external grade 5-7 year polymeric vinyl with anti graffiti polyvinyl fluoride film over. Cut vinyl to match fixing points to prevent damage to print.

3. Sign panel fixed to column shelter stainless steel, security style, button head machine screws.

All construction details to be coordinated with signage shelter details.

**Graphics Detail**  
FONT  
Agenda - Medium Italic  
Agenda - Light

SIZE  
As shown

COLOUR  
Refer to graphic standards for details

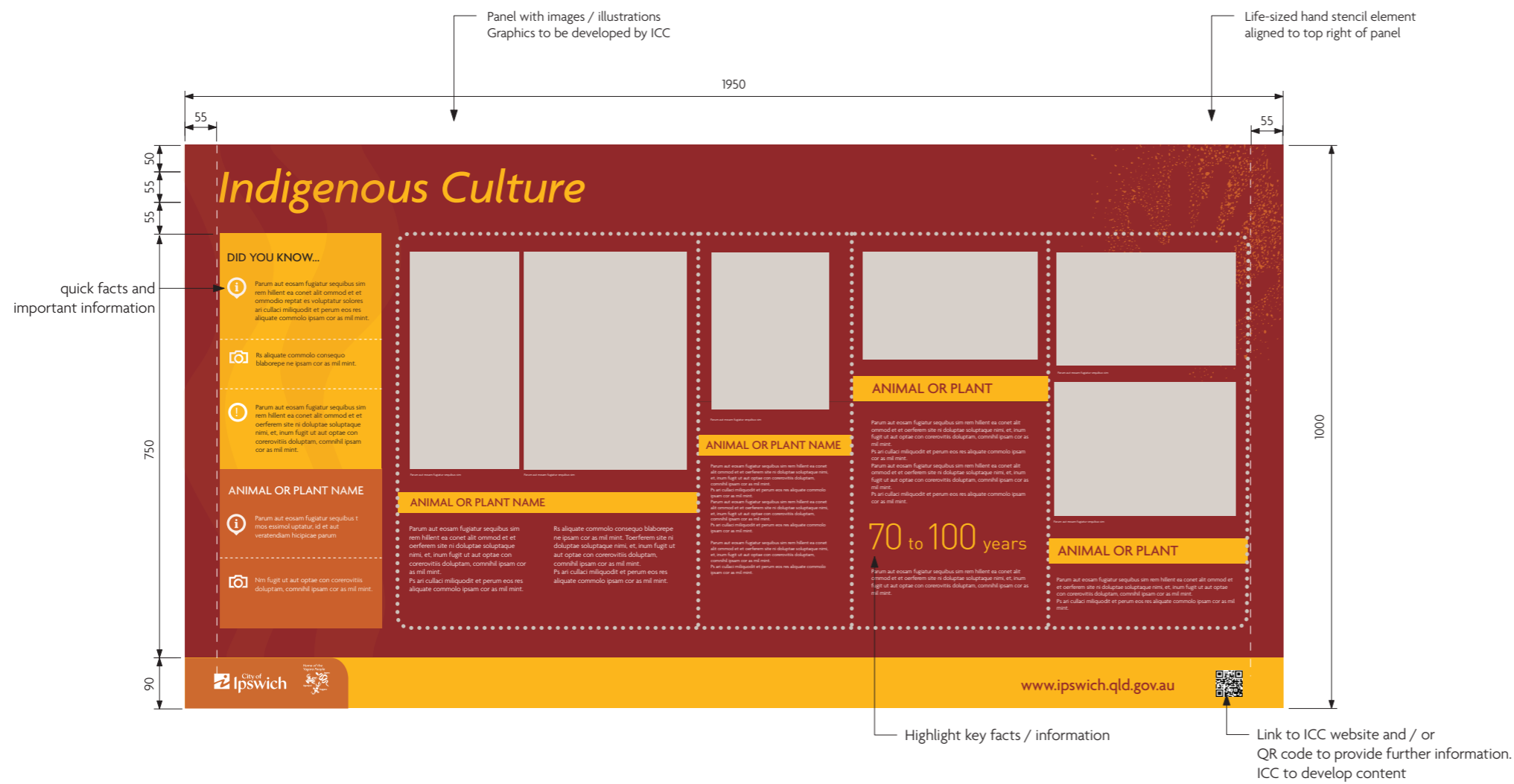

**Graphic Layout**

Scale 1:10



Unless otherwise noted all dimensions in millimetres. Use figured dimensions in preference to scaling. Contractor to confirm all dimensions and details on site prior to manufacture.

**Attention**  
Due to this reproduction process the colours shown in this drawing may not exactly represent the final product colour.

**REFERENCE DOCUMENTS**  
This drawing must be read in conjunction with the following documents:  
- Sign Location Plan  
- Specification  
Contact ICC Project Manager for details.

**GENERAL CONSTRUCTION NOTES**  
• Drawings show design intent. Any changes to specification which affects design intent must be approved by ICC.

• All structural members, fixings and/or footings to be confirmed by sign maker's engineer.

**Construction Details**  
Refer to page 2 of 2 for construction details.

**Graphics Detail**  
FONT  
Agenda - Medium Italic  
Agenda - Light

SIZE  
Panel Heading = 28mm X cap height  
Body Copy = 9mm X cap height

COLOUR  
Refer to graphic standards for details.

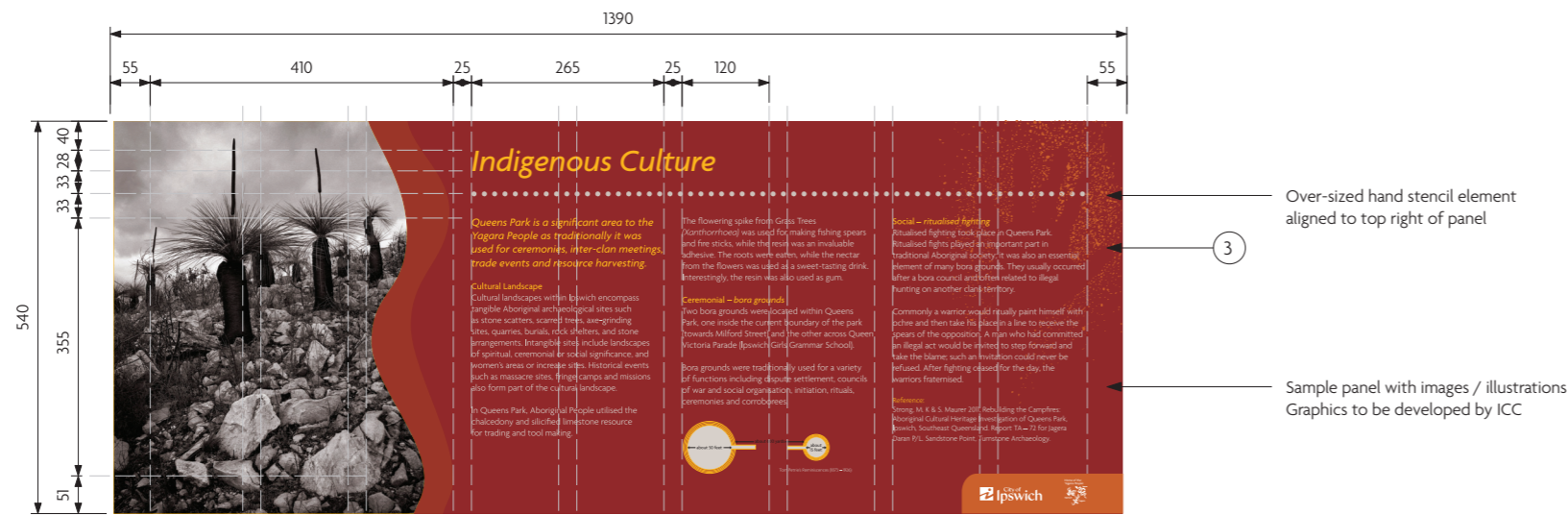

Graphic Layout  
Scale 1:10

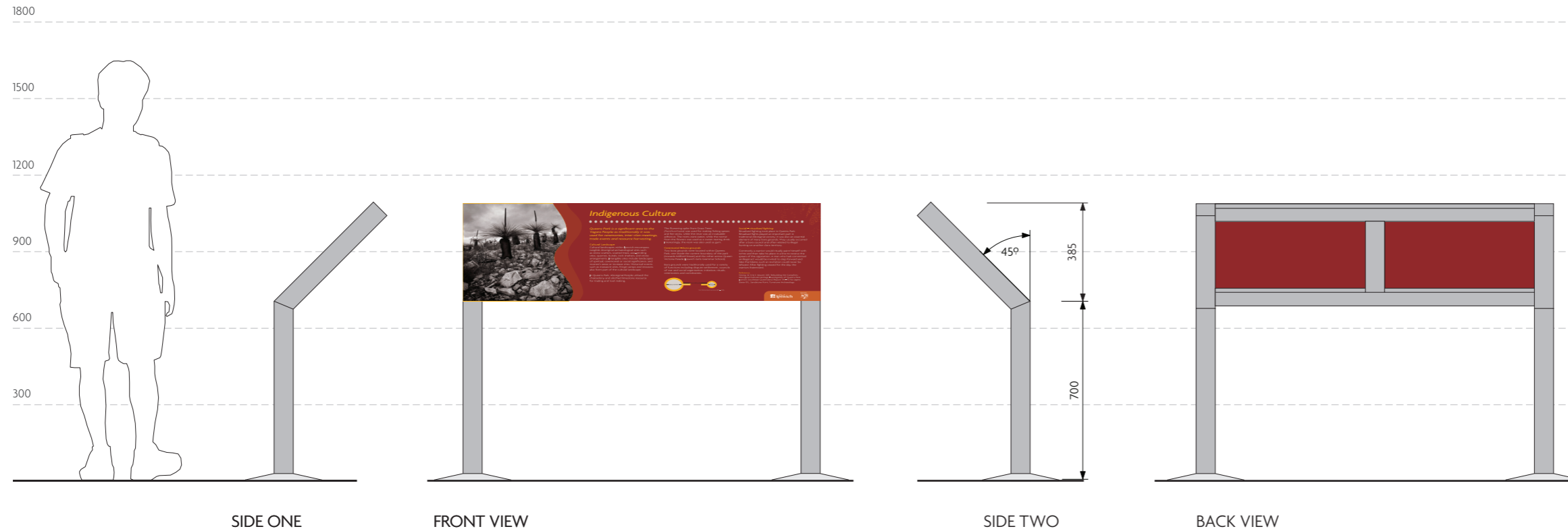

Typical Elevations  
Scale 1:20



Unless otherwise noted all dimensions in millimetres. Use figured dimensions in preference to scaling. Contractor to confirm all dimensions and details on site prior to manufacture.

**Attention**  
Due to this reproduction process the colours shown in this drawing may not exactly represent the final product colour.

**REFERENCE DOCUMENTS**  
This drawing must be read in conjunction with the following documents:  
- Sign Location Plan  
- Specification  
Contact ICC Project Manager for details.

**GENERAL CONSTRUCTION NOTES**  
• Drawings show design intent. Any changes to specification which affects design intent must be approved by ICC.

• Refer to General Construction Specification Appendix A

• All structural members, fixings and/or footings to be confirmed by sign maker's engineer.

**Construction Details**  
1. Fabricated sign frame. Galvanised steel 75mm SHS posts with 25mm x 75mm RHS cross members. 3mm welded cap to SHS post as required.

2. 3mm thick aluminium sign panels. To be primed and all visible edges painted to match DULUX Red Blooded. 3mm radius on all corners. Fixing points to be pre drilled.

3. Full colour digital print onto external grade 5-7 year polymeric vinyl with anti graffiti polyvinyl fluoride film over. Cut vinyl to match fixing points to prevent damage to print. Vinyl to wrap edges of panel to provide barrier between panels. Cut vinyl to suit corner detail on sign panel.

4. Sign panel fixed to column with stainless steel pop rivits.

**Footings**  
5. Unreinforced concrete footing. All concrete footings shall finish above finished ground level with a 25mm domed crown. Re-instate / make good paving, pavement or ground surface, with no changes of level and no gradients steeper than 1:40. Embed concrete footings a minimum of 500mm.

All steelwork to be hot dipped galvanised.

**Graphics Detail**  
Refer to page 1 of 2 for graphics detail.

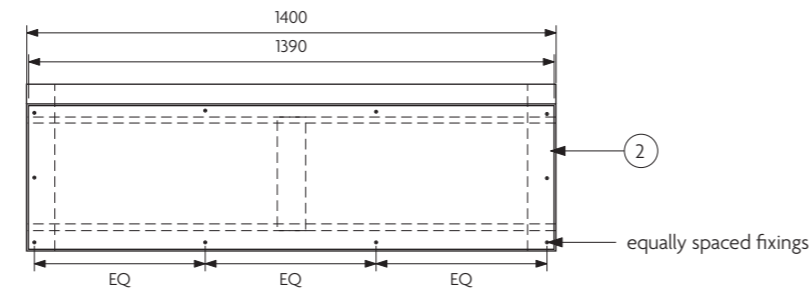

TOP VIEW

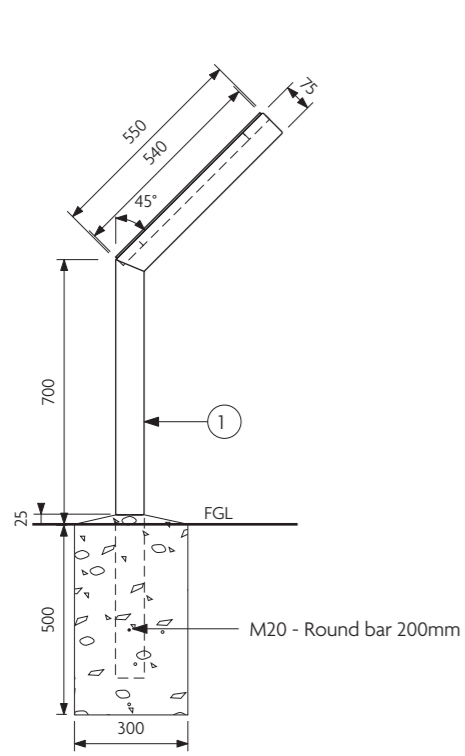

SIDE VIEW

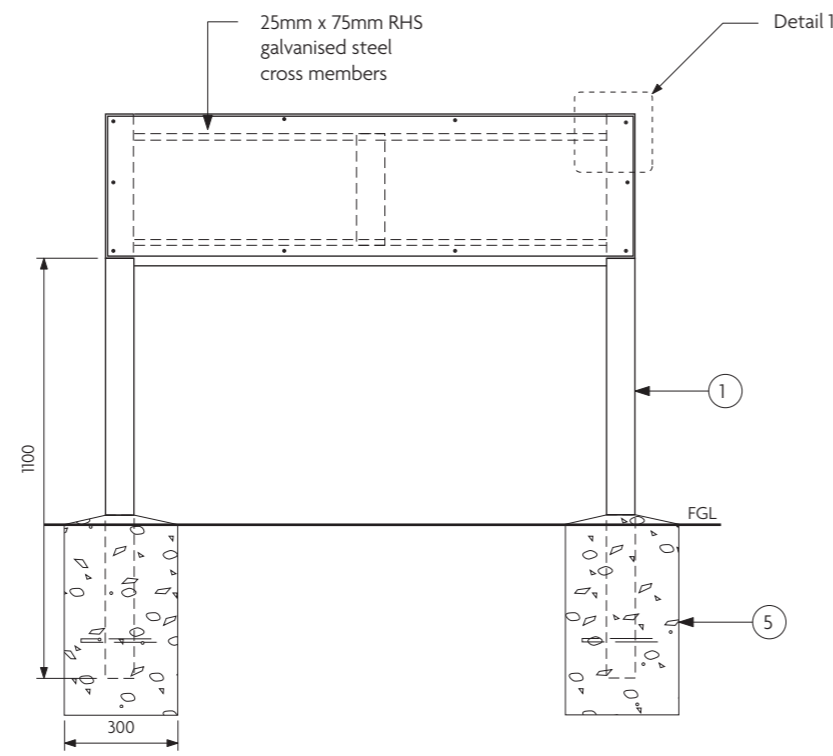

FRONT VIEW

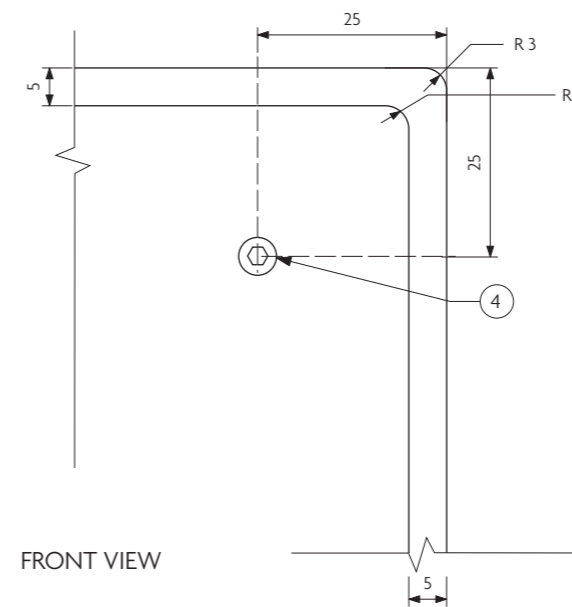

FRONT VIEW

Detail 1

Scale 1:1

**Graphic Layout**

Scale 1:20

Unless otherwise noted all dimensions in millimetres. Use figured dimensions in preference to scaling. Contractor to confirm all dimensions and details on site prior to manufacture.

**Attention**  
Due to this reproduction process the colours shown in this drawing may not exactly represent the final product colour.

**REFERENCE DOCUMENTS**  
This drawing must be read in conjunction with the following documents:  
- Sign Location Plan  
- Specification  
Contact ICC Project Manager for details.

**GENERAL CONSTRUCTION NOTES**  
• Drawings show design intent. Any changes to specification which affects design intent must be approved by ICC.

• All structural members, fixings and/or footings to be confirmed by sign maker's engineer.

**Construction Details**  
Refer to page 2 of 2 for construction details.

**Graphics Detail**  
**FONT**  
Agenda - Medium Italic  
Agenda - Light

**SIZE**  
Panel Heading = 28mm X cap height  
Body Copy = 9mm X cap height

**COLOUR**  
Refer to graphic standards for details.

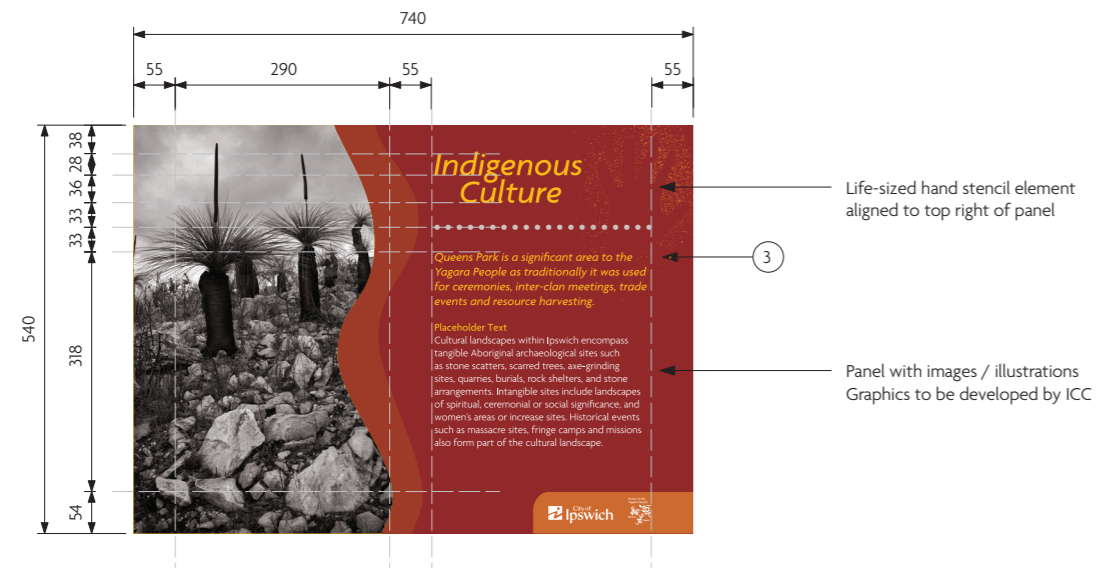

**Graphic Layout**  
Scale 1:10

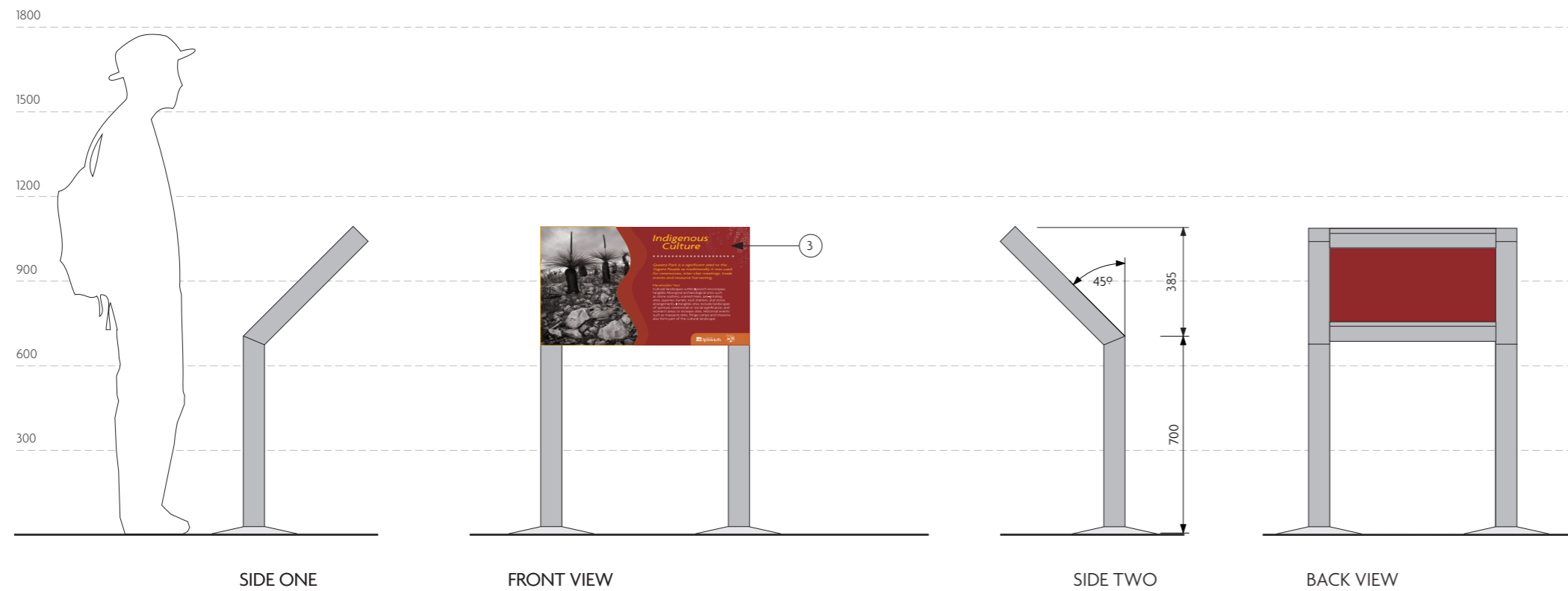

**Typical Elevations**  
Scale 1:20

Unless otherwise noted all dimensions in millimetres. Use figured dimensions in preference to scaling. Contractor to confirm all dimensions and details on site prior to manufacture.

**Attention**  
Due to this reproduction process the colours shown in this drawing may not exactly represent the final product colour.

**REFERENCE DOCUMENTS**  
This drawing must be read in conjunction with the following documents:  
- Sign Location Plan  
- Specification  
Contact ICC Project Manager for details.

**GENERAL CONSTRUCTION NOTES**  
• Drawings show design intent. Any changes to specification which affects design intent must be approved by ICC.  
  
• Refer to General Construction Specification Appendix A  
  
• All structural members, fixings and/or footings to be confirmed by sign maker's engineer.

**Construction Details**  
1. Fabricated sign frame. Galvanised steel 75mm SHS posts with 25mm x 75mm x 3.0mm RHS cross members. 3mm welded cap to SHS post as required.

2. 3mm thick aluminium sign panels. To be primed and all visible edges painted to match DULUX Red Blooded. 3mm radius on all corners. Fixing points to be pre drilled.

3. Full colour digital print onto external grade 5-7 year polymeric vinyl with anti graffiti polyvinyl fluoride film over. Cut vinyl to match fixing points to prevent damage to print. Vinyl to wrap edges of panel to provide barrier between panels. Cut vinyl to suit corner detail on sign panel.

4. Sign panel fixed to column with stainless steel pop rivits.

**Footings**  
5. Unreinforced concrete footing. All concrete footings shall finish above finished ground level with a 25mm domed crown. Re-instate / make good paving, pavement or ground surface, with no changes of level and no gradients steeper than 1:40. Embed concrete footings a minimum of 500mm.

All steelwork to be hot dipped galvanised.

**Graphics Detail**  
Refer to page 1 of 2 for graphics detail.

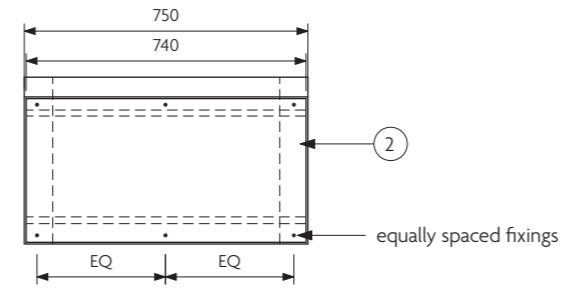

TOP VIEW

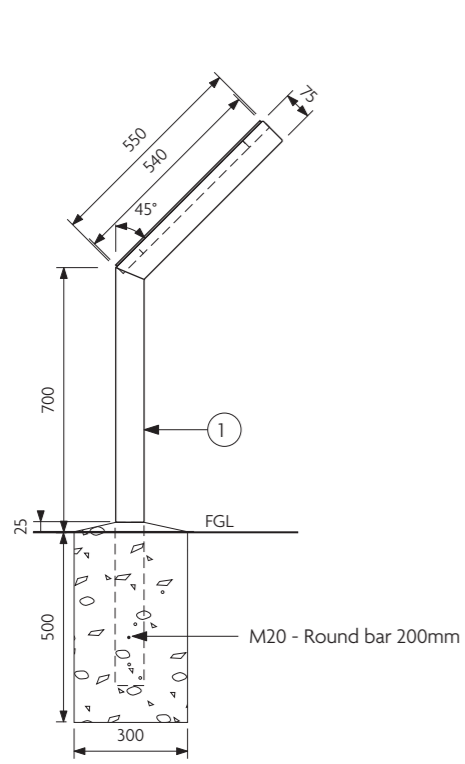

SIDE VIEW

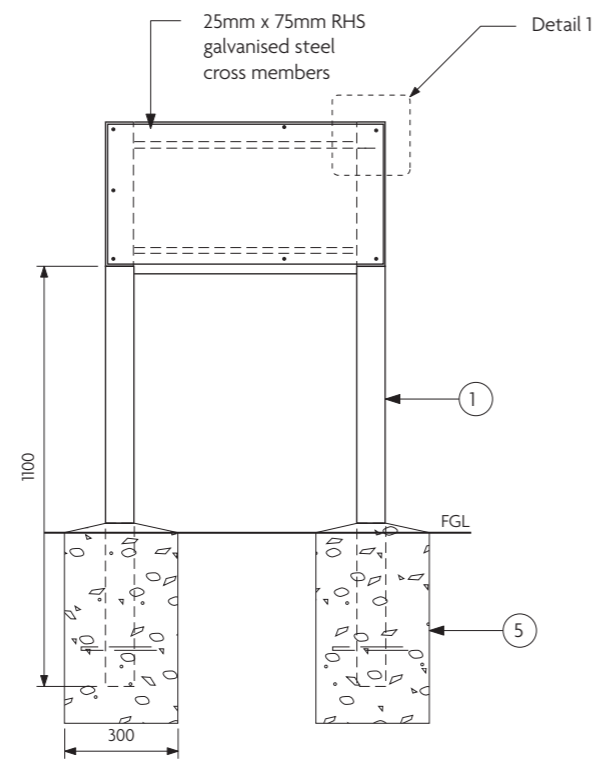

FRONT VIEW

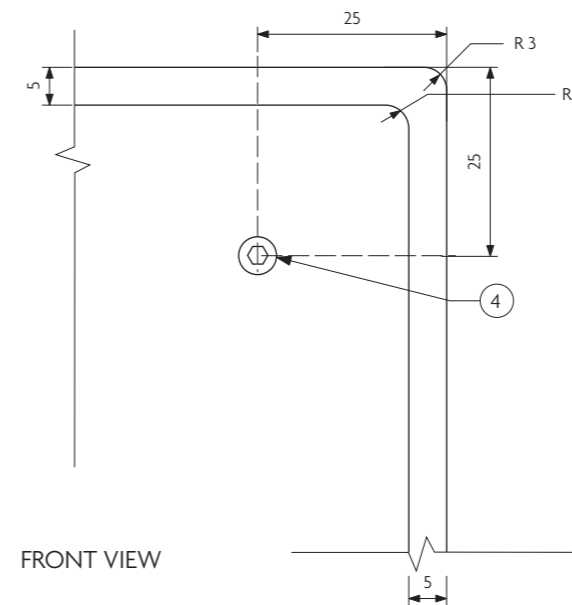

FRONT VIEW

**Detail 1**  
Scale 1:1

**Construction Details**  
Scale 1:20

Unless otherwise noted all dimensions in millimetres. Use figured dimensions in preference to scaling. Contractor to confirm all dimensions and details on site prior to manufacture.

**Attention**

Due to this reproduction process the colours shown in this drawing may not exactly represent the final product colour.

**REFERENCE DOCUMENTS**

This drawing must be read in conjunction with the following documents:  
 - Sign Location Plan  
 - Specification  
 Contact ICC Project Manager for details.

**GENERAL CONSTRUCTION NOTES**

• Drawings show design intent. Any changes to specification which affects design intent must be approved by ICC.

• All structural members, fixings and/or footings to be confirmed by sign maker's engineer.

**Construction Details**

Refer to page 2 of 2 for construction details.

**Graphics Detail**

FONT  
 Agenda - Medium Italic  
 Agenda - Light

SIZE  
 As shown

COLOUR  
 Refer to graphic standards for details.

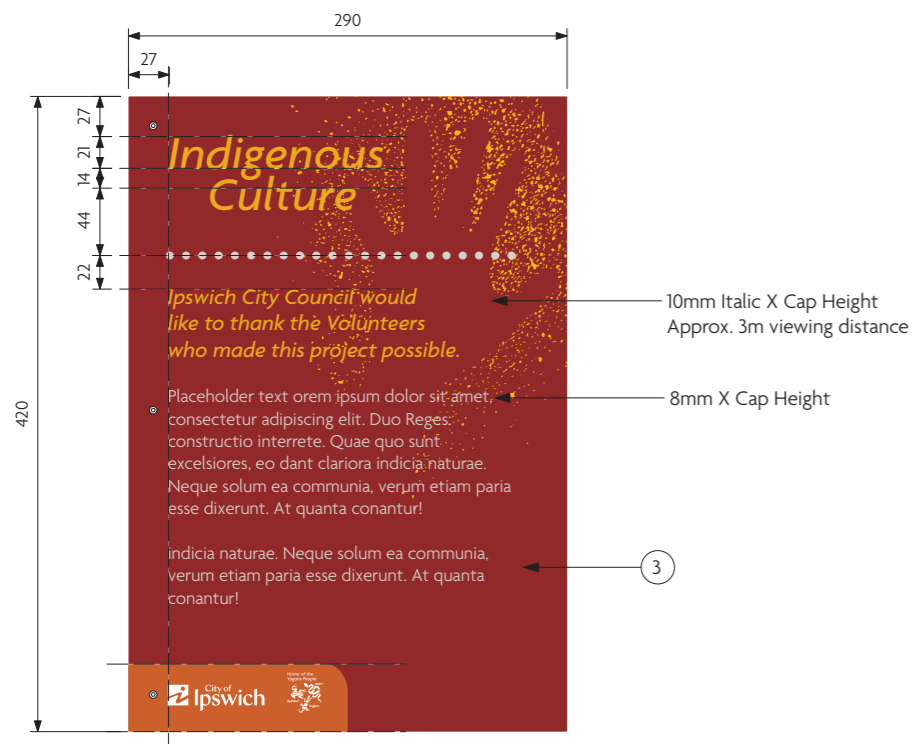

**Graphic Layout**

Scale 1:5

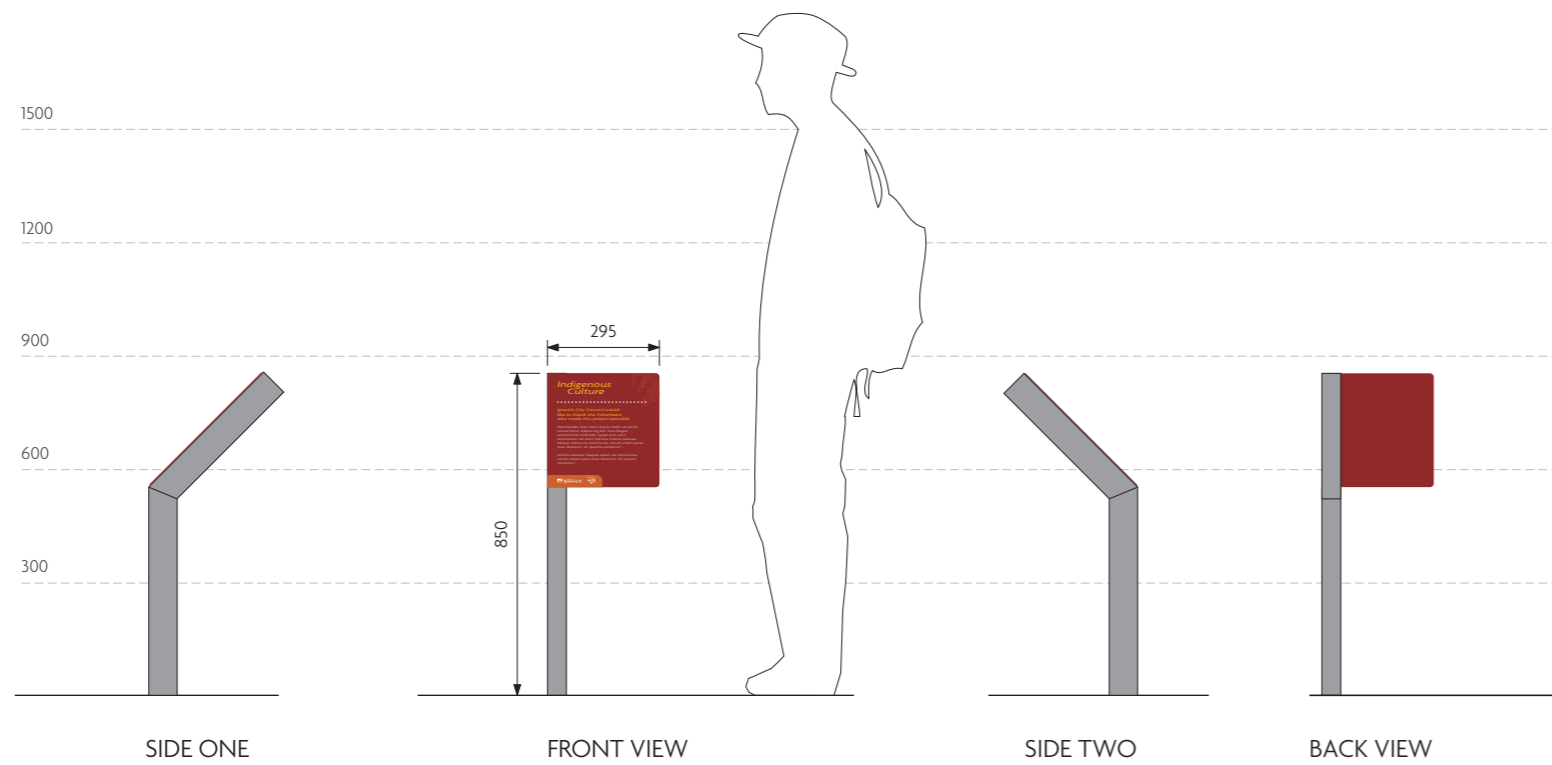

**Typical Elevations**

Scale 1:20

Unless otherwise noted all dimensions in millimetres. Use figured dimensions in preference to scaling. Contractor to confirm all dimensions and details on site prior to manufacture.

**Attention**  
Due to this reproduction process the colours shown in this drawing may not exactly represent the final product colour.

**REFERENCE DOCUMENTS**  
This drawing must be read in conjunction with the following documents:  
- Sign Location Plan  
- Specification  
Contact ICC Project Manager for details.

**GENERAL CONSTRUCTION NOTES**  
• Drawings show design intent. Any changes to specification which affects design intent must be approved by ICC.  
  
• All structural members, fixings and/or footings to be confirmed by sign maker's engineer.

**Construction Details**  
1. Fabricated 50mm x 75mm RHS galvanised steel sign post. 3mm welded cap to RHS post as required.

2. 5mm thick aluminium sign panels. To be primed and all visible edges painted to match DULUX Red Blooded. 3mm radius on all corners. Fixing points to be pre drilled.

3. Full colour digital print onto external grade 5-7 year polymeric vinyl with anti graffiti polyvinyl fluoride film over. Cut vinyl to match fixing points to prevent damage to print. Vinyl to wrap edges of panel to provide barrier between panels. Cut vinyl to suit corner detail on sign panel.

4. Sign panel fixed to column with stainless steel pop rivits.

**Footings**  
5. Unreinforced concrete footing. All concrete footings shall finish above finished ground level with a 25mm domed crown. Re-instate / make good paving, pavement or ground surface, with no changes of level and no gradients steeper than 1:40. Embed concrete footings a minimum of 500mm.

All steelwork to be hot dipped galvanised.

**Graphics Detail**  
Refer to page 1 of 2 for graphics detail.

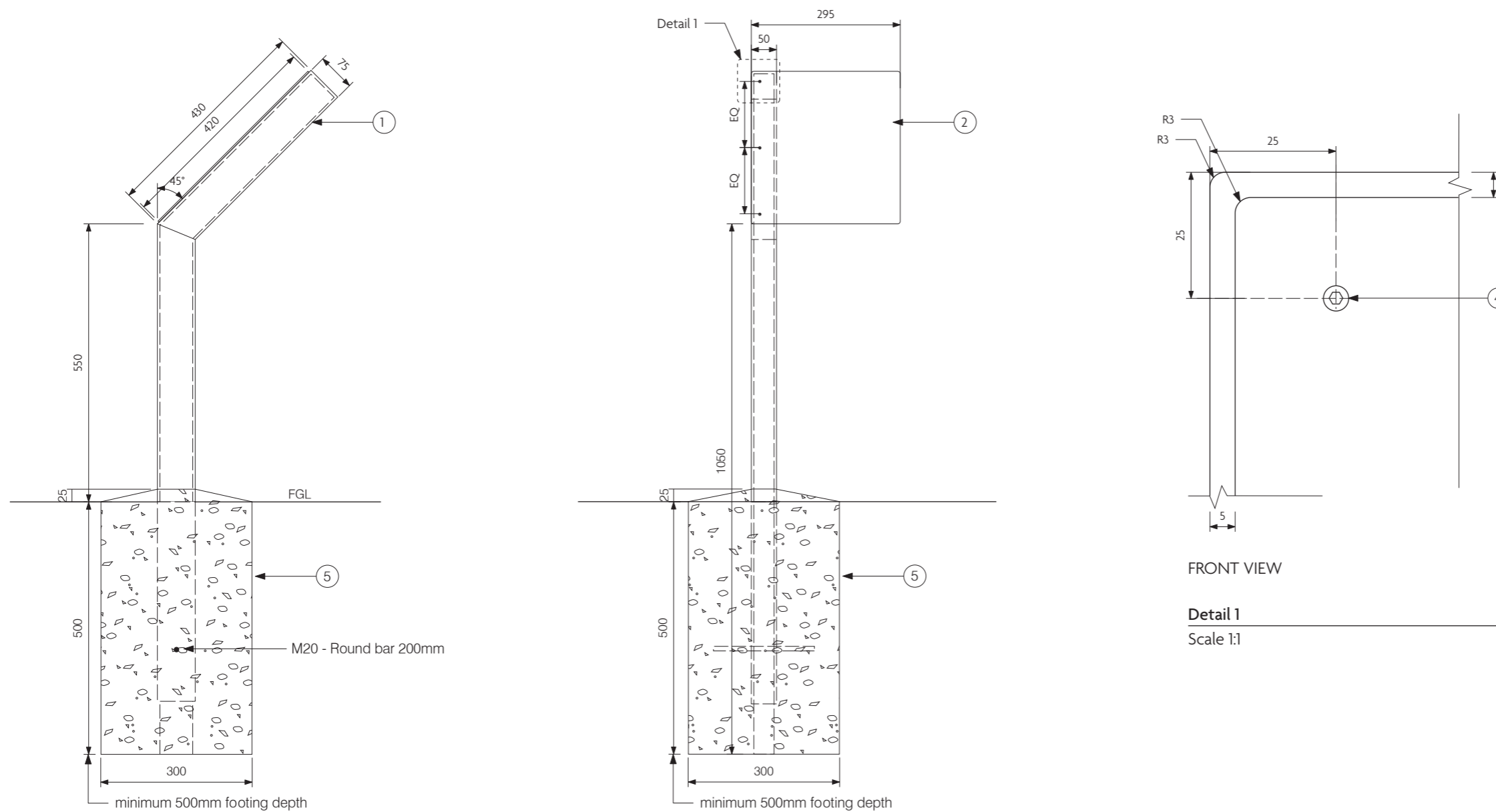

FRONT VIEW

Detail 1

Scale 1:1

Construction Details

# Appendices

## Appendix – A. General Structural Specification

Construction compliance with the structural guidelines of this document, as outlined in “Form 15 – Compliance Certificate for Building Design or Specifications” shall be deemed to comply with design solutions, with no further structural design review required.

A written statement of as built compliance with this brief from a responsible person shall be a condition of practical completion.

The following scope limitations apply to signs covered by this manual:

1. The maximum ultimate strength limit state wind for the signage is 42 meters per second. In terms of AS 1170 this equates to region B terrain category 2 and 3.
2. The signs are not to be sited on hilltops, the edge of escarpments or attached to other structures such as roofs or retaining walls.
3. Fixings and materials are to have a design life without maintenance of at least 25 years.
4. The signs are not designed to sustain flood or vehicle impact loads.
5. The signs are not designed with the aim of minimising the effects of wilful vandalism.
6. Columns are not to be routinely in a wet environment- i.e. wetlands or water course.
7. Signage structure shall not form any part of a balustrade or safety barrier.
8. The documented footings are not suitable for sandy sites.
9. The assumed depth of topsoil for footing design is 100mm. Where deeper topsoil is encountered, deepen the footing by a similar amount.

The minimum thickness for steel sections shall be three millimetres. All steelwork shall be hot dip galvanised after fabrication. Steelwork shall have no joins. Electro plated zinc coatings (Duragal or similar) shall not be substituted for galvanised steel.

Aluminium including holes in aluminium sheet are to be electrically isolated from zinc or stainless steel fixings. Use over sized or plastic sleeved holes and plastic washers. Fixings in treated timber are to be coated, hot dip galvanised bolts are to be greased before installation. The minimum size of screw to be used is 4.8mm diameter.

All timber used shall be a select grade, arried and well seasoned. Timber splitting and warping within 12 months of installation shall be replaced at the contractor's expense. Pressure treated timber shall not be used until the moisture content is less than 20%. Only H grade treated timber or durability class 1 natural timber shall be used..

Footings shall be cast insitu concrete of minimum grade N 20 installed into natural ground or controlled fill.





<p><b>5. Building certifier reference number</b></p>	<p>Building certifier reference number</p> <div style="border: 1px solid black; height: 20px; width: 100%;"></div>
<p><b>6. Competent person details</b>                  A competent person for building work, means a person who is assessed by the building certifier for the work as competent to practise in an aspect of the building and specification design, of the building work because of the individual's skill, experience and qualifications in the aspect. The competent person must also be registered or licensed under a law applying in the State to practice the aspect.                   If no relevant law requires the individual to be licensed or registered to be able to give the help, the certifier must assess the individual as having appropriate experience, qualifications or skills to be able to give the help.                   If the chief executive issues any guidelines for assessing a competent person, the building certifier must use the guidelines when assessing the person.</p>	<p>Name (in full)</p> <div style="border: 1px solid black; height: 20px; width: 100%;"></div> <p>Company name (if applicable)</p> <div style="border: 1px solid black; height: 20px; width: 100%;"></div> <p>GHD P/I</p> <div style="border: 1px solid black; height: 20px; width: 100%;"></div> <p>Phone no. business hours</p> <div style="border: 1px solid black; height: 20px; width: 100%;"></div> <p>Mobile no.</p> <div style="border: 1px solid black; height: 20px; width: 100%;"></div> <p>Fax no.</p> <div style="border: 1px solid black; height: 20px; width: 100%;"></div> <p>Email address</p> <div style="border: 1px solid black; height: 20px; width: 100%;"></div> <p>Alan.wolski@ghd.com</p> <p>Postal address</p> <div style="border: 1px solid black; height: 20px; width: 100%;"></div> <p>GPO Box 668 Brisbane 4001</p> <p>Licence or registration number (if applicable)</p> <div style="border: 1px solid black; height: 20px; width: 100%;"></div> <p>RPEQ 02676</p>
<p><b>7. Signature of competent person</b>                  This certificate must be signed by the individual assessed by the building certifier as competent.</p>	<p>Signature</p> <div style="border: 1px solid black; height: 80px; width: 100%; text-align: center;">  </div> <p>Date</p> <div style="border: 1px solid black; height: 20px; width: 100%;"></div> <p>23 May 2016</p>

The *Building Act 1975* is administered by the Department of Housing and Public Works



