

## SCHEDULE 2—CHARACTER PLACES

### Part 1—Historic and Miscellaneous Places

Address/Site Name	Street No.	Suburb	RPD	Description	Extent of Significance
Albert Street	15	North Ipswich	L31 RP14724	Dwelling	Whole Lot
Alice Street	28-28A	Goodna	L4-5 RP22565	Dwelling	Whole Lot
Alice Street 'St. Alban's Anglican Church'	69	Goodna	L1 RP2461	Church	Whole Lot excluding post 1946 buildings & structures
Bailey Street 'Westfalen Colliery No. 3'	27	Collingwood Park	L1 RP22440	Colliery Complex	Colliery facilities of the 1970's
Barclay Street	76-78	Bundamba	L44-45 RP22527	Dwelling	Whole Site
Barclay Street	82	Bundamba	L46 RP22527	Dwelling	House only
Bell Street	1	Ipswich	L3 RP2654	Shop	Whole Lot
Bell Street	1	Ipswich	L4 RP2654	Shop	Whole Lot
Bell Street	1	Ipswich	L5 RP2654	Shop	Whole Lot
Berlins Road 'Muller private cemetery'	223	Tallegalla	L1 RP66966	Cemetery	Fenced area containing one headstone for the Muller family
Blackall Street	100	Basin Pocket	L31 RP23986	Dwelling	Whole Lot
Blackstone Road	9	Eastern Heights	L16 RP24157	Shops	Whole Lot
Booval Street 'Violetville'	16	Booval	L22 RP23755	Dwelling	Whole Lot
Boyles Rd 'The Boghole'		Pine Mountain	Part of road reserve	Parkland	Area outlined on attached Plan No. 1
Bremer River Barry Street Road Reserve 'Stone retaining wall'		Ipswich		Stone retaining wall supporting the banks of the Bremer River in the area known as the Swing Basin	To the extent of the remains of the stone retaining wall
Bremer Street 'First Queensland Railway Centenary Memorial'		Ipswich	Road Reserve	Memorial	The extent of its concrete foundations in the Bremer Bridge pier
Bremer Street 'Railway Bridge'		Ipswich	Railway Reserve	Bridge	Area outlined on attached Plan No. 2
Bremer Street 'Sesqui-Centenary Discovery Memorial Cairn within Transit Centre Carpark'	10	Ipswich		Memorial	To the extent of the memorial's concrete foundations
Bremer Street 'Johnston's Brewery Site'	14	Ipswich	L1 RP54899 L1 RP812175	Archaeological site	Original sandstone foundations which can be relocated but are to remain on site



Address/Site Name	Street No.	Suburb	RPD	Description	Extent of Significance
Bridge Street	28	North Booval	L14 RP23802	Dwelling	Whole Lot
Brisbane Road Andrew Duce's House	47-49	Bundamba	L2 RP123379	Dwelling	Main House
Brisbane Road Cameron's Park 'War Memorial & Surrounds'	95A	Booval	L169 RP24111	Memorial	To the extent of the concrete apron surrounding the memorial
Brisbane Road 'Bundamba War Memorial & surrounds Memorial Park'	17	Bundamba	L10-11 B7002	Memorial	To the extent of the memorial's concrete apron
Brisbane Road 'Bundamba Methodist Church Hall'	20	Bundamba	L1 RP170587	Church Hall	Whole Lot excluding post 1946 buildings & structures
Brisbane Road	73	Bundamba	L2-3 RP22506	Dwelling	Whole Site
Brisbane Road 'Duce House and Pergola'	88 and 90	East Ipswich	L10 RP53682 & L3 RP71500	Dwelling	Whole Lot including boundary fences, internal stone retaining walls
Brisbane Road Rotary Park: 'Old Ipswich Railway Bridge Memorial'	258	Bundamba	L507 SL6935	Memorial	To the extent of the concrete apron surrounding the memorial
Brisbane Road 'Dinmore Murri Baptist Church'	38 and 38a	Dinmore	L78 and L79 RP22376	Church	Church building
Brisbane Road	44	Dinmore	L121 SP130149	Dinmore Railway Station	Passenger Station Building, Footbridge and northern Timber Platform Shelter.
Brisbane Road		Ebbw Vale	L131 SP130151	Ebbw Vale Railway Station	Rail Passenger Station Building, Timber Platform Shelters and Footbridge
Brisbane Road 'Ebbw Vale War Memorial & surrounds'	11	Ebbw Vale	L1 RP40461	Memorial	To the extent of the memorial's concrete apron
Brisbane Road 'Sandhurst'	35	Ebbw Vale	L2 RP83652	Dwelling	Whole Lot
Brisbane Road Redbank Railway Station		Redbank	Railway Reserve	Railway Station	To the extent of the original railway station building
Brisbane Road 'Ipswich – Brisbane Road Distance Marker'		Redbank	Outside the Redbank Railway Station, opposite 93 Brisbane Road	Road Distance Marker	Area outlined on attached Plan No. 3
Brisbane Road 'Stone Kerbing and Gutters'		Redbank	Road Reserve	Stone kerbing and gutters	Area outlined on attached Plan No. 4
Brisbane Road 'Redbank State School'	7 & 9	Redbank	L8 RP22523 L390 SL6661	School building & annexe	Whole Site excluding all post 1960's buildings and structures
Brisbane Road	34	Redbank	L2 RP59354	Shop	Whole Lot
Brisbane Road 'Commercial Hotel'	70	Redbank	L30 RP803123	Hotel	Whole Lot excluding all post 1946 buildings & structures



Address/Site Name	Street No.	Suburb	RPD	Description	Extent of Significance
Brisbane Road 'Redbank School of Arts'	71	Redbank	L13-14 RP22316	School of Arts	Whole Site and street awnings
Brisbane Road	89	Riverview	L10 RP87341	Dwelling	Whole Lot
Brisbane Street 'QCWA Girls' Hostel'	5	Ipswich	L2 RP61206	Dwelling	Whole Lot
Brisbane Street 'Ulster Hotel'	25	Ipswich	L10 I122412	Hotel	Whole Lot and the street awning
Brisbane Street 'Suva House'	38	Ipswich	L1 RP75715	Shop	Whole Lot and the street awning
Brisbane Street	80	Ipswich	L1 RP80199	Shop	Whole Lot and the street awning
Brisbane Street	86	Ipswich	L0 BUP289 L0 BUP 104426 L8 BUP104426 L1-4 BUP289	Shops	Whole Site and the street awning
Brisbane Street 'Queensland National Bank'	89	Ipswich	L2 RP2652	Bank	Whole Lot
Brisbane Street	91	Ipswich	L1 RP2652	Shop	Whole Lot
Brisbane Street	93	Ipswich	L2 RP2653	Shop	Whole Lot
Brisbane Street	94	Ipswich	L3 RP93328	Shop	Whole Lot
Brisbane Street	96	Ipswich	L2 RP162302	Shop	Whole Lot
Brisbane Street 'Public Trustee's Office'	97	Ipswich	L203 I12241 L1 RP2653	Shop	Whole Site and the street awning
Brisbane Street	100	Ipswich	L1 RP93328	Shop	Whole Lot
Brisbane Street	102	Ipswich	L3 RP166867	Bank	Whole Lot
Brisbane Street 'Fox's Pharmacy'	106	Ipswich	L1 RP46058	Shop	Whole Lot
Brisbane Street 'Former Bank of Australasia'	112	Ipswich	L2 RP2713	Bank	Whole Lot
Brisbane Street Limestone Street 'Ipswich Post Office'	114 63 & 65	Ipswich	L9 RP68487 L24 I12244 L25 RP68487	Post Office	Whole Lot
Brisbane Street 'London Pharmacy'	114B	Ipswich	L1 RP2713	Shop	Whole Lot
Brisbane Street 'School of Arts, Town Hall, St Paul's Young Men's Club'	116	Ipswich	L12 SP103223	School of Arts Hall	Whole Lot, excluding all post 1946 buildings and structures



Address/Site Name	Street No.	Suburb	RPD	Description	Extent of Significance
Brisbane Street 'St Paul's Anglican Church'	124	Ipswich	L5 RP47364	Church, Rectory, Memorial, Gates & Walls	Whole Lot including the Church, Rectory, Memorial to Mavis Parkinson, the entry gates & all sandstone & limestone walls. Excluding all post 1946 buildings and structures
Brisbane Street	126	Ipswich	L1 RP175271	Shop	Whole Lot
Brisbane Street	130	Ipswich	L1 RP2758	Shop	Whole Lot
Brisbane Street	133	Ipswich	L1-2 RP47496	Shop	Whole Site
Brisbane Street	135	Ipswich	L3 RP112220	Shop	Whole Lot
Brisbane Street	137	Ipswich	L2 RP112220	Shop	Whole Lot
Brisbane Street 'Voglers'	138-140	Ipswich	L1 RP47528 L2 RP2760	Shop	Whole Lot and the street awning
Brisbane Street	141	Ipswich	L1 RP112220	Shop	Whole Lot and the street awning
Brisbane Street	141	Ipswich	L4 RP101770	Shop	Whole Lot
Brisbane Street	141	Ipswich	L3 RP101770	Shop	Whole Lot
Brisbane Street	142	Ipswich	L38 RP214352	Shop	Whole Lot and the street awning
Brisbane Street 'Former Motor Garage'	144	Ipswich	L2 RP74367	Shop	Whole Lot and the street awning
Brisbane Street	146	Ipswich	L2 RP48335	Shop	Whole Lot and the street awning
Brisbane Street	150	Ipswich	L3 RP2762	Shop	Whole Lot and street awning
Brisbane Street	152	Ipswich	L1 RP2762	Shop	Whole Lot and the street awning
Brisbane Street 'Big Whites'	160	Ipswich	L80 I12245	Shop	Whole Lot and the street awning, excluding all post 1946 buildings and structures
Brisbane Street 'Hoey & Platz'	164	Ipswich	L10 RP105860	Shop	Whole Lot and the street awning, excluding all post 1946 buildings and structures
Brisbane Street 'Bostock Chambers'	169	Ipswich	L0-6 BUP249	Shop	Whole Site and the street awning
Brisbane Street	178	Ipswich	L2 RP95228	Shop	Whole Lot
Brisbane Street	183	Ipswich	L1 RP2720	Shop	Whole Lot and the street awning
Brisbane Street 'Lutvey's shop'	185	Ipswich	L2 RP2717	Shop	Shop front only including display windows
Brisbane Street	187	Ipswich	L1 RP2717	Shop	Whole Lot and the street awning
Brisbane Street 'Baptist Church'	188	Ipswich	L5 SP234330	Church & Memorial Gates	Whole Site including the retaining wall to Brisbane Street and memorial gates, excluding all post 1946 buildings and structures
Brisbane Street	189	Ipswich	L1 RP2738	Shop	Whole Lot and the street awning
Brisbane Street	196	Ipswich	L818 I12245	Shop	Whole Lot



Address/Site Name	Street No.	Suburb	RPD	Description	Extent of Significance
Brisbane Street	197	Ipswich	L197 SP134638	Shop	Whole Lot and the street awning
Brisbane Street	199	Ipswich	L199 SP134638	Shop	Whole Lot and the street awning
Brisbane Street	203	Ipswich	L2 RP106090	Shop	Whole Lot and the street awning
Brisbane Street 'Emporium'	205	Ipswich	L714 I12246	Shop	Whole Lot and the street awning
Brisbane Street	208	Ipswich	L5 I1642	Shop	Whole Lot
Brisbane Street	211	Ipswich	L2 RP93097	Shop	Whole Lot
Brisbane Street 'Federal Hotel'	214	Ipswich	L1 RP167693	Hotel	Whole Lot excluding all post 1946 buildings and structures
Brisbane Street 'Settlers Inn'	215	Ipswich	L2 RP2752	Hotel	Whole Lot and the street awning
Brisbane Street	219	Ipswich	L2 RP43941	Shop	Whole Lot
Brisbane Street	221	Ipswich	L1 RP43941	Shop	Whole Lot
Brisbane Street	223	Ipswich	L2 RP91888	Shop	Whole Lot including the Loetzschs Cycle and Motorcycle House Signage located above the main entrance and shop front windows facing Brisbane Street.
Brisbane Street 'Ipswich Flour Milling Co.'	227	Ipswich	L1-2 RP2751	Flour mill building, shops	Whole Lot and the street awning
Brisbane Street	233	Ipswich	L2 RP2749	Shop	Whole Lot
Brisbane Street	235	Ipswich	L4 RP41451	Shop	Whole Lot
Brisbane Street	237	Ipswich	L3 RP41451	Shop	Whole Lot
Brisbane Street	239	Ipswich	L3 RP71848	Shop	Whole Lot
Brisbane Street	241	Ipswich	L2 RP71848	Shop	Whole Lot
Brisbane Street 'Prince of Wales'	243	Ipswich	L2 RP2747	Hotel	Whole Lot
Brisbane Street 'Metropole Hotel'	253	Ipswich	L1 CP896413	Hotel	Whole Lot and the street awning
Brisbane Street 'City View Hotel'	277	West Ipswich	L3 RP24063	Hotel	Whole Lot and the street awning, excluding all post 1946 buildings and structures
Brisbane Terrace	84	Goodna	L11 RP2452	Dwelling	Main House
Brisbane Terrace	91	Goodna	L3 RP2450	Dwelling	Main House
Brisbane Terrace 'Royal Mail Hotel'	92	Goodna	L915 G152	Hotel	Whole Lot and the street awning
Brisbane Terrace	93	Goodna	L2 RP2450	Dwelling	Main House
Brisbane Terrace	95	Goodna	L1 RP2450	Dwelling	Main House
Brisbane Terrace	97	Goodna	L1 RP2449	Dwelling	Main House
Brisbane Terrace	99	Goodna	L2 RP2449	Dwelling	Main House
Brisbane Valley Highway	315–333	Pine Mountain	L250 CH3113	Dwelling	Main house in fenced house yard
Brisbane Valley Highway	335–355	Pine Mountain	L247 CH3113	Dwelling	Main house in fenced house yard



Address/Site Name	Street No.	Suburb	RPD	Description	Extent of Significance
Brittains Road 'Oakleigh'	11	Augustine Heights	L3 RP210082	Dwelling	Main house
Burnett Street 'Blair State School'	22	Sadliers Crossing	L398 SL4745	School	Blocks B, C & D
Byrne Street 'Byrneville'	8	Bundamba	L8 RP868820	Dwelling	Whole Lot
Cairns Road 'Ebbw Vale Triassic Fossil Locality'	41	Ebbw Vale	L1 RP819367	Triassic fossil localities	Whole Lot
Carara Avenue	59-63	Thagoona	L33 RP138870	Dwelling	Main house
Cemetery Road Manson Park – 'American War Cemetery Memorial'	19	Raceview	L21 I16249	Memorial	Whole Lot
Chelmsford Avenue 'Blackall Memorial Drinking Fountain'		Ipswich	Road Reserve	Memorial	To the extent of the memorial's concrete apron
Chelmsford Avenue	7	Ipswich	L38 I16270	Dwelling	The main house excluding all post 1946 buildings & structures
Chelmsford Avenue 'Denmark Hill Fossil Insect Beds' Denmark Hill Environmental Park'	20	Ipswich	L23 I16262	Fossil insect beds	The extent of the fossil beds as outlined on attached Plan No. 5
Chelmsford Avenue 'Denmark Hill Coal Workings'. Denmark Hill Environmental park'	20	Ipswich	L23 I16262	Disused quarry/mine site	To the extent of the coal workings included in the area outlined on attached Plan No. 6
Chelmsford Avenue 'Water reservoir'	22	Ipswich	L24 I6262	Water reservoir	1928 domed reservoir
Chermside Road 'Cribb & Foote Centenary Memorial Gates'	133	East Ipswich	L2 RP66535	Memorial	The land 2 metres around the base of the gates
Chermside Road 'Ipswich Girls Grammar School'	82	Ipswich	L167 SP139377	School	Whole Lot excluding all post 1946 buildings and structures
Chermside Road 'Gwennap'	68	Newtown	L22 RP883000	Gwennap Historic Dwelling	Whole Lot excluding all post 1946 buildings and structures
Church Street 'Goodna War Memorial & surrounds'		Goodna	Road Reserve Corner of Queen and Church Streets	Memorial	To the extent of the memorial's concrete apron
Church Street 'St Francis Xavier Church'	6	Goodna	L552 G153	Church	Whole Lot excluding all post 1946 buildings & structures
Church Street 'Police Complex'	14	Goodna	L189 SL5041	Police Complex	Former police barracks, cells and residence
Church Street 'Police Complex'	75	Harrisville	L75 CC2699	Police complex	Whole Lot



Address/Site Name	Street No.	Suburb	RPD	Description	Extent of Significance
Church Street 'Tivoli Congregational Church Hall'	42	Tivoli	L21 SP175186	Hall	Whole Lot excluding all post 1946 buildings & structures
Clifton Street	32	Booval	L64 RP23818	Dwelling	Whole Lot, including the pressed metal ceiling in its original paint scheme, and the front door, fan lights and side lights set in a cedar frame.
Clifton Street 'Buttonsville'	40A	Booval	L1 RP88852	Dwelling	Whole Lot
Kruger Parade 'Redbank Rifle Range'	2-74 100	Redbank	L2 SP229584 L1 SL11262	Rifle Range	Whole Site
Collingwood Drive 'Queensland's First Labour Strike Memorial' Namatjira Park	2A	Collingwood Park	L184 RP147247	Memorial	To the extent of the memorial's foundations
Cothill Road 'Booval House'	14	Booval	L146 SP138166	Dwelling	Whole Lot
Cothill Road 'Sacred Heart Church and School'	19	Booval	L20 RP211510	Church Presbytery School	Whole Lot including the Church, Presbytery and fence fronting Cothill Road and excluding all post 1946 buildings & structures
Cunningham Highway	2673	Willowbank	L2 RP213075	Dwelling	Main house excluding all other buildings & structures
Cyprus Street	22	North Ipswich	L123 RP14651	Dwelling	Whole Lot
D'arcy Doyle Place 'Ipswich City Mall Historical Obelisk'		Ipswich	Road Reserve	Memorial	To the extent of the memorial's concrete apron
Darling Street East 'family home of d'Arcy Doyle'	39	Woodend	L2 RP40364	Dwelling	Whole Lot
Dinmore Railway Pedestrian Overpass Bridge		Dinmore	Railway Reserve	Bridge	Wooden railway pedestrian overpass bridge including the three sets of steps leading to the platforms
Dinmore Street	1A	Dinmore	L2 RP99844	Dwelling	Whole Lot
Downs Street 'Hotel Cecil'	15	North Ipswich	L1 RP213980	Hotel	Whole Site and the street awning
Downs Street 'Sangster Memorial'	29	North Ipswich	L1 RP99677	Memorial	The Sangster Memorial located in Browns Park to the extent of the memorial's concrete apron



Address/Site Name	Street No.	Suburb	RPD	Description	Extent of Significance
Downs Street 'Downs Street Newsagency'	39	North Ipswich	L1 RP62228	Shop	Whole Lot and the street awning
Downs Street	72	North Ipswich	L1 RP43440	Shop	Whole Lot and the street awning
Downs Street 'Salvation Army'	80	North Ipswich	L78 I1626	Church	Whole Lot excluding all post 1946 buildings and structures
Downs Street	101	North Ipswich	L1 RP66039	Shop	Whole Lot and the street awning
Dudleigh Street	51	North Booval	L1 RP75163	Dwelling	Whole Lot
Dunns Avenue 'Royal Hotel'	Lot 1	Harrisville	L1 RP209502	Hotel	Whole Lot
Earls Road 'Kickbush Farmhouse'	47	Marburg	L2 SP269084	Dwelling	Fenced house yard
East Owen Street 'Aberdere Extended No. 1 Colliery' Former General Manager's Office		Raceview	L1 RP180890	Former General Manager's Office	Area outlined on attached Plan No. 29
East Street 'Ipswich & West Moreton Building Society'	45	Ipswich	L1 I12244	Office building	Whole Lot
East Street 'Ipswich Court House'	75	Ipswich	L527 CP893588	Court house	Whole Lot
East Street 'Ipswich Police Station'	77	Ipswich	L528 CP883325	Police Station	Whole Lot, excluding all post 1946 buildings & structures
East Street 'Ipswich General Hospital'	81	Ipswich	L410 SL8088	A.E. Wilcox School of nursing building	To the extent of the A.E. Wilcox School of nursing building plus the area outlined on attached Plan No. 8
East Street 'R.A.C.Q. Building'	82	Ipswich	L51 I122421	Office building	Whole Lot, excluding all post 1946 buildings & structures
East Street Church & former 'Central Congregational Sunday School Hall'	86	Ipswich	L1 RP104836	Sunday School Hall and New Church	Whole Lot including 'new' 1960 Church building and excluding all other post 1946 buildings & structures
Ebenezer Road 'Spring Hill'		Ebenezer	L1 RP176308	Farm	House yard and outbuildings in the area outlined on attached Plan No. 9
Edmond Street	7-17	Marburg	L1 RP35855	Former Manse	Whole Lot excluding all post 1946 buildings and structures
Edmond Street 'Marburg Trinity Evangelical Lutheran Church'	19-29	Marburg	L1 CH312443	Church	Whole Lot excluding all post 1946 buildings and structures





Address/Site Name	Street No.	Suburb	RPD	Description	Extent of Significance
Edmond Street 'Marburg Village Antique Shop'	60	Marburg	L2 RP88701	Shop	Shop and the street awning
Edmond Street 'Shop and Post Office'	64-66	Marburg	L1 RP197092	Shop	Whole Lot and the street awning
Edmond Street 'Rosewood Lowood Blue Nursing Service'	67	Marburg	L1 RP51101	Shop	Shop and the street awning
Edmond Street 'Marburg Hotel'	69	Marburg	L2 RP52509	Hotel	Whole Lot excluding all post 1946 buildings & structures
Edmond Street 'Former National Bank & War Memorials (Marburg Community Centre)'	71	Marburg	L1 RP72529	Former bank	5 metre wide area surrounding the former bank building and to the extent of the memorials' concrete aprons
Edmond Street 'Former Walloon Shire Council Hall'	73	Marburg	L388 CC693	Public Hall	5 metre wide area surrounding the Rosewood Scrub Historical Society Hall
Elizabeth Street 'St Mary's'	1B	Woodend	L10 C730291 L4 RP192946 L54 SP116137	Church & ancillary buildings	Whole Site including Church, Presbytery, Parish Hall, Convent, Infant School, Primary School & Music Room, excluding all 1946 buildings & structures. The locations of the listed buildings with shading are shown on attached Plan No. 10
Elizabeth Street 'Hitching Rail'	2A	Woodend	L1 RP2798	Hitching Rail	Area outlined on attached Plan No. 11
Ella Street Winding Engine 'Jessie Brown'	10	Blackstone	L3 RP22475	Historic Mining Site	To the extent of the Winding Engine's foundations and the surrounding structure
Ellenborough Street 'Halley's Bakery'	1/11	Woodend	L1 SP172855	Bakery	Bakery Building
Ellenborough Street	15	Ipswich	L2RP2723	Shop	Whole Lot
Ellenborough Street	17	Ipswich	L2 RP2722	Shop	Whole Lot
Ellenborough Street 'Commercial Hotel'	7	Woodend	L628 I122419	Hotel	Whole Lot
Embrey's Road	41-101	Tallegalla	L1 RP143151	Farm	Main house
F. Holts Road	21	Pine Mountain	L317 CH3124	Dwelling	Main house and slab barn
Fassifern Street	23	Peak Crossing	L5 RP21401	Dwelling	Whole Lot
Fassifern Street	25	Peak Crossing	L1 RP175268	Dwelling	Whole Lot
Fassifern Street 'Catholic Church'	28-30	Peak Crossing	L1 RP21397	Church	Whole Lot
Fassifern Street	33-35	Peak Crossing	L16-17 RP21401	Hall	Whole Lot
Flinders Dolomite Road	Lot 1	Peak Crossing	L1 RP21476	Dwelling	Whole Lot



Address/Site Name	Street No.	Suburb	RPD	Description	Extent of Significance
Freeman Road 'Rosewood Railway Museum'		Ashwell	L5 RP35934 L2 RP35744 L2 RP35867 L2 RP35849 L8 RP35934 L2 RP35745 L29-30 CP827087 L31-32 CP827307 L727 CC3542 L11 RP210771	Historic steam railway	Area outlined on attached Plan No. 12
French Street 'Sacred Heart Primary School'	23	Booval	L1 RP48729	School	Whole Lot excluding all post 1946 buildings & structures
Galah Street	9	Churchill	L28 RP30080	Dwelling	Whole Lot
George Street 'St Peter's Catholic Church'	7	Grandchester	L2 CC3579	Church	Church + 10 metres
George Street	8	Grandchester	L6 G12521	Dwelling	Whole Lot
George Street	18	Grandchester	L1 RP162965	Dwelling	Whole Lot
George Street	11-23	Marburg	L1 RP188001	Farmhouse	Main house
Gimpels Road	257	Mutdapilly	L18 RP893146	Farmhouse	Main house
Gladstone Road	92	Coalfalls	L68 I120729	Dwelling	Whole Lot
Gladstone Road 'Sadliers Crossing Railway Bridge'	22-22A	Sadliers Crossing	L1/2 RP146583	Bridge	To the extent of the railway bridge
Glebe Road	32	Newtown	L27 RP24096	Shop	Whole Lot
Glebe Road	69	Silkstone	L1 RP54621	Shop	Whole Lot
Glebe Road	81	Silkstone	L1 RP113901	Shop	Whole Lot
Glebe Road 'Silkstone State School'	95	Silkstone	L15 RP24241	School building & residence	E-shaped 1915 school building and principal's residence as outlined with shading on attached Plan No. 13
Goebels Road 'Calais Park Stud'	270	Mt Forbes	L194 CC2606	Farm	Main house
Gordon Road 'Bigge's Camp'	Lot 1	Grandchester	L1 SP142791	Monument	To the extent of the Monument's concrete apron
Grandchester-Mt Mort Road 'Franklyn Vale'	Lot 2	Grandchester	L2 CC1246	Homestead	The main house & outbuildings outlined on attached Plan No. 14
Grandchester-Mt Mort Road	Lot 10	Grandchester	L10 CC3471	Dwelling	Main house and detached kitchen
Grandchester-Mt Mort Road 'Old Hidden Vale'	617	Grandchester	L1 SP107980	Homestead complex	The main house & the buildings outlined on attached Plan No. 15
Grandchester-Mt Mort Road 'Mt Mort Historical Cemetery'	Lot 18	Mt Mort	L18 CC933	Cemetery	Whole Lot



Address/Site Name	Street No.	Suburb	RPD	Description	Extent of Significance
Grandchester-Mt Mort Road 'Cardross'	1560-1580	Mt Mort	L29 RP46754	Homestead	The main house & outbuildings outlined on attached Plan No. 16
Gray Street	11	Ipswich	L1 RP82341	Dwelling	Whole Lot
Gray Street 'Ipswich Club'	14	Ipswich	L147-148 I1615	Club	Whole Site
Grenville Street	9	Basin Pocket	L159 RP24005	Dwelling	Whole Lot
Haigslea Cemetery Road 'Haigslea Cemetery'	Lot 1	Haigslea	L1 CH31319	Cemetery	Whole Lot
Haigslea-Malabar Road	Lot 397	Marburg	L1 RP168155	Farmhouse	Fenced House Lot
Haigslea-Amberley Road 'Station View'	426	Walloon	L2 SP248933	Farmhouse	Main house
Haigslea – Amberley Road 'Babies of Walloon' Drowning Site	470-488	Walloon	L22 CC2597	Waterhole	Waterhole and surrounding area measured five metres from the edge of the waterhole as outlined on attached Plan No. 57
Hall Street 'Uniting Church'	2-6	Harrisville	L1 RP166440	Church	Whole Lot
Hall Street 'Harrisville State School'	9-21	Harrisville	L80 CC2715	School	The earliest remaining school building on the right-hand end of main block as outlined with shading on attached Plan No.17
Hallett's Road	Lot 300	Redbank Plains	L300 RP853941	Dwelling	Whole Lot
Harrison Street Parker Lane 'Klondyke Coke Ovens'		North Ipswich	L5 AP3320	Coke oven battery remains	Area outlined on attached Plan No. 18
Harvey Street	6 & 6A	Churchill	L7/8 RP30084	Dwelling	Whole Site
Hayes Street	8/10	Raceview	L44/45 RP67693	Dwelling	Whole Site
Heiner Road 'Heiner Road Bridge'		North Ipswich	Road Reserve	Bridge Abutments	Area outlined on attached Plan No. 19
High Street 'Haig Street Quarry'	39	Brassall	L695 CC2872	Triassic fossil beds	The Triassic fossil bed located in the northeast face of the quarry where a steeply dipping shale surface is exposed, as outlined on attached Plan No. 20
High Street	54	Blackstone	L226 S312269	Former Principal's Residence	Main House
Hill Street	11	Blackstone	L1 RP2433	Dwelling	Whole Lot
Hill Street 'Blackstone State School'	14	Blackstone	L25 SP161915	School	Whole Site, excluding post 1946 buildings and structures
Holdsworth Road	80	North Ipswich	L24 RP3260	Dwelling	Whole Lot
Holmes Street	9	North Ipswich	L3 RP90515	Dwelling	Main house, including internal pressed metal ceilings, walls and fittings



Address/Site Name	Street No.	Suburb	RPD	Description	Extent of Significance
Hospital Road	68-102	Rosewood	L2 RP35765	Dwelling	Whole Lot
Hunter Street	17	Brassall	L1 SP136551	Dwelling	Whole Lot
Ipswich City Mall	38	Ipswich	L6 RP101770	Shop	Whole Lot
Ipswich City Mall	40	Ipswich	L5 RP101770	Shop	Whole Lot
Ipswich City Mall	42	Ipswich	L4 RP101770	Shop	Whole Lot
Ipswich City Mall	46	Ipswich	L2 RP101770	Shop	Whole Lot
Ipswich Road 'Grandchester Railway Station & Station Master's Residence'	62-116	Grandchester	L205 CC3570	Railway Station & Station Master's residence	Whole Lot including the station, station master's residence & associated outbuildings & structures, excluding all post 1946 buildings & structures
Ipswich-Boonah Road	Lot 2	Goolman	L2 RP145493	Farmhouse	Main house
Ipswich-Boonah Road	1137	Peak Crossing	L3 RP851801	Dwelling	Main house
Ipswich-Boonah Road 'Rockton'	1166	Peak Crossing	L2 RP187329	Farmhouse	Main house
Ipswich-Boonah Road	1231-1269	Peak Crossing	L25 SP109181	Dwelling	Main house
Ipswich-Boonah Road	1318	Peak Crossing	L1 RP199602	Dwelling	Whole Lot excluding all post 1946 extensions & outbuildings
Ipswich-Boonah Road 'Peak Crossing State School & residence'	1323	Peak Crossing	L69 CC3224	School & Principal's Residence	Buildings outlined with shading on attached Plan No. 21
Ipswich-Boonah Road	Lot 53	Purga	L53 C155913	Farmhouse	Main house
Ipswich-Boonah Road 'Bullion Park'	83	Purga	L2 RP106091	Farmhouse	Main house
'Ipswich to Walloon Original Railway Line'		Brassall & Wulkuraka	L34 SL4200 L1 RP146565 L13 RP146570 L14 RP146571 L15 RP146566 L1 RP8267 L1 RP146567 L2 RP146568 L23 CC3448 L618 & 719 CC2646 L3 RP899866 L723 CP903644 L14 CC1343 L688 SP103906	Original rail line	Railway track remnants as outlined on attached Plan No. 22
Ivan Lane	64-82	Ironbark	L103 CH3116	Dwelling	Main farm house
John Street 'Rosewood Court House'	1A	Rosewood	L7 CP898268	Court House	Whole Lot excluding all post 1946 buildings and structures



Address/Site Name	Street No.	Suburb	RPD	Description	Extent of Significance
John Street 'CWA Building'	4	Rosewood	L6 SP145185	Community Hall	Street awning and the fenced area around the CWA building
John Street 'Rosewood Realty'	5	Rosewood	L2 RP35583	Shop	Whole Lot and the street awning
John Street 'Rosewood Hotel'	6	Rosewood	L 4 RP45262	Hotel	Whole Lot and the street awning
John Street 'Franklin's Store'	8-10	Rosewood	L2 RP45262	General store & residence	Whole Lot and the street awning
John Street	12	Rosewood	L1 RP144461	Store & residence	Whole Lot and the street awning
John Street 'Rosewood Post Office'	17	Rosewood	L20 RP 179450	Post Office	Whole Lot
John Street 'Rosewood Uniting Church Precinct'	19-23	Rosewood	L2 RP35567	Church	Whole of property excluding all post 1946 buildings and structures
John Street 'Royal George Hotel'	24	Rosewood	L1 RP35514	Hotel	Whole Lot, including the main two storey section, excluding the flat roofed northern annexe and excluding other post 1946 extensions and buildings
John Street 'Rosewood Farmers Hall'	25	Rosewood	L1 RP35585	Hall	Whole of site excluding all post 1946 buildings and structures
John Street 'Rosewood Quality Meats'	40	Rosewood	L2 RP35512	Shop	Whole Lot including the front parapet and street awning
John Street 'Cross & Embrey Real Estate Office & Blue Nurses Office'	42	Rosewood	L2 RP35511	Shop & residence	Whole Lot and the street awning
John Street	50	Rosewood	L13 RP35508	Dwelling	Whole Lot
John Street	58	Rosewood	L2 RP159816	Dwelling	Whole Lot
John Street	66	Rosewood	L61 RP35509	Dwelling	Whole Lot
John Street	68	Rosewood	L2 RP55227	Dwelling	Whole Lot
John Street 'Anglican Church of St Luke'	72-74	Rosewood	L22 RP35497 & L2 RP35517	Church & hall	Whole Site excluding all post 1946 buildings and structures
Johnston Street 'Langley'	83	Bellbird Park	L12 SP238494	Farmhouse	Main house
Jones Road 'Redbank Plains Fossil Site'		Bellbird Park	L171 RP904872	Fossil Site	Whole Site
Karrabin-Rosewood Road 'Walloon State School'	Lot 442	Walloon	L442 SP131788	School	To the extent of the Administration Building only
Karrabin-Rosewood Road 'Walloon Community Hall'	534	Walloon	L604 CC1818	Hall	Whole Lot
Kells Road	Lot 114	Walloon	L114 CC3523	Dwelling	Whole Lot



Address/Site Name	Street No.	Suburb	RPD	Description	Extent of Significance
Kennedy Street	8	Marburg	L31 RP35810	Dwelling	Whole Lot
Kerwick Street 'Kerwick Hotel'	1	Redbank	L61 RP163040	Hotel	Whole Lot excluding all post 1946 buildings & structures
Kerwick Street	10	Redbank	L1 SP204710	Dwelling and former 'lock-up'	Police residence and 'lock-up'
Kingsmill Road 'Coalfalls/Brassall Bridge Memorial'		Coalfalls	Road Reserve	Memorial	To the extent of the memorial's concrete apron
Lanefield Road 'Daisy Park'	39-79	Rosewood	L380 CH31320	Dwelling	Main house
Lawrence Street 'North Ipswich State School'	10	North Ipswich	L13 I16254	School and Principal's residence	Whole Lot, including classrooms and Principal's residence and excluding all post 1946 buildings and structures
Lawrence Street Lennon Lane 'St. Thomas' Anglican Church'	15-17 12-14	North Ipswich	L1 RP3204 L28-30 RP3206	Church	Whole Site, excluding post 1946 buildings and structures
Lees Road	23	Ebenezer	L23 RP123059	Dwelling	House and rear wing
Limestone Street 'St Stephens Presbyterian Church'	22	Ipswich	L9-10 C730571 L72 I122417	Church & Hall	Whole Site
Limestone Street Ellenborough St 'Uniting Church Central Mission'	77 27	Ipswich	L32-34 RP159290	Church & Hall	Whole Site, excluding post 1946 buildings and structures
Limestone Street 'Liberty Hall'/ 'Mary Tregaer Hostel'	84	Ipswich	L2 RP100150	Dwelling	Whole Lot excluding post 1946 buildings and structures
Limestone Street 'Queen Victoria Silver Jubilee Memorial Technical College'	88	Ipswich	L1 I16237	College	Whole Lot excluding post 1946 buildings and structures
Limestone Street 'Villa Maria' Fence/ Wall	98	Ipswich	L1 RP43916	Fence/ Wall	To the extent of the fence/wall's foundations along Limestone Street and Wilson's Lane
Limestone Street Baines Park 'Western Suburbs War Memorial'	112	Ipswich	L108 I16120	Memorial	To the extent of the memorial's concrete apron
Lindsay Street 'Brethren Hall'	14-14A	Bundamba	L15/16 RP438	Church Hall	Whole Lot
Linnings Road	145-147	Haigslea	L1 RP187839	Dwelling	Whole Lot
Lloyd George Street 'Doyle House'	6	Eastern Heights	L20 RP24430	Dwelling	Whole Lot
Long Gully Road 'Railway dam and weir'		Grandchester	L1 RP 22822 L224, 226-227 CC3466	Dam	Whole Site



Address/Site Name	Street No.	Suburb	RPD	Description	Extent of Significance
Lowry Street 'Vietnam War Memorial'	5	North Ipswich	L2 RP150632	Memorial	To the extent of the memorial's concrete apron
Lowry Street 'Queenslands First Railway Memorial'	5	North Ipswich	L21 SP175186	Memorial	To the extent of the memorial's concrete apron
Grandchester Mt Mort Road 'Macadam Constructed Road and Stone Culverts'		Grandchester		Historic road and stone culverts	Coordinates: 1. -27.70126, 152.47112 road 2. -27.70763, 152.47123 road 3. -27.71639, 152.46955 culvert 4. -27.73554, 152.46516 culvert 5. -27.73985, 152.46079 culvert 6. -27.74216, 152.45610 culvert 7. -27.76981, 152.43491 road
Main Street 'Former Proudlocks Drapery'	1	Marburg	L2 RP85007	Shop & residence	Whole Lot and street awning
Maitland Street	13	Churchill	L75 RP30071	Dwelling	Whole Lot
Marian Street 'Hebron Gospel Hall'	5	Booval	L57 & L58 RP23757	Church Hall	Whole Lot excluding all post 1946 buildings & structures
Mary Street 'Blackstone Congregational Church'	14	Blackstone	L1 RP184263	Church	Whole Lot
Mary Street	7	Bundamba	L4 RP22411	Dwelling	Whole Lot
Mary Street 'St Edmunds College'	16	Woodend	L3 RP889302	Christian Brothers' residence & Pender House	Christian Brothers' Residence', Pender House & Mary St Garden as outlined within the shaded areas on attached Plan No. 23
Matthew Street Railway Street 'St Brigid's Catholic Church'	8, 10, 14A, 9A-9C, 11	Rosewood	L5-6 RP35576 L14-18 RP35575	Church	Whole Site, including Presbytery, Church, Hall and School and excluding all post 1946 buildings & structures except the Presbytery.
Matthew Street	28	Rosewood	Lot 1 SP263258	Former Convent	Whole Lot
Matthew Street 'St Matthews Lutheran Church'	63	Rosewood	L29 RP35593	Church	Whole Lot
McGill Street 'Villa Esrum'	13	Basin Pocket	L92 RP24005	Dwelling	Whole Lot
McGrath Lane 'Melrose'	20	Booval	L1 RP49167	Dwelling	Whole Lot
Meier Street	17	Peak Crossing	L36 RP21401	Dwelling	Whole Lot
Merton Street		East Ipswich	L144 SP130156	East Ipswich Railway Station	Rail Footbridge and Timber Platform Shelters
Middle Road	Lot 1	Purga	L1 RP168958	Farmhouse	Main house



Address/Site Name	Street No.	Suburb	RPD	Description	Extent of Significance
Milford Street 'Queen's Park'		Ipswich	L1 SP135011	Park & Incinerator Complex	Whole Lot excluding all post 1946 buildings and structures
Milford Street 'Claremont'	1A	Ipswich	L11 RP56444	Dwelling	Whole Site
Milford Street 'Oakdale Hospital – Matron's and Nurses' Quarters'	4	Ipswich	L1 RP899865	Dwelling	Whole Lot
Milford Street 'Oakdale Private Hospital'	6	Ipswich	L1 RP2951 L2 RP59551 L1 RP61206	Hospital	Whole Site
Milford Street 'Ipswich Kindergarten'	12	Ipswich	L428 SL3424	Kindergarten	Whole Lot
Milford Street 'Ipswich Drill Hall'	29	Ipswich	L2 RP99201	Hall	Drill Hall
Mill Street 'Goodna Presbyterian Church'	2A	Goodna	L5 RP809250	Church	Whole Lot including the Church and excluding the manse and hall.
Mill Street 'Rising Sun Hotel'	25-31	Rosewood	L11 SP118185	Hotel	Whole of Lot
Mine Street 'Queensland Potteries kiln'	11	Redbank	L28 RP222102	Industrial Complex	5 metre wide area surrounding the 'Double Chambered Brick Kiln'
Mining Street		Bundamba	L476 SP130152	Bundamba Railway Station	Rail Passenger Station Building and Timber Platform Shelters
Monash Street 'World War II Pistol Range'	5	Redbank	L93 M311	Pistol Range	Area outlined on attached Plan No. 24
Moore's Pocket Road	5	Tivoli	L1 RP 87568	Dwelling	Whole Lot
Morris Street	12	Silkstone	L2 RP24364 & L2 RP24365	Dwelling	Whole Lot
Morris Street	14	Silkstone	L5 RP107212	Dwelling	Whole Lot
Mt Mort Road 'St Anne's Anglican Church'	798-800	Grandchester	L1 RP53891	Church	Whole Lot
Mt Walker West Road 'Ruhland's Farm'		Mt Walker	L12 CH3154	Farm complex	The main house and outbuildings as outlined on attached Plan No. 26
Mutdapilly-Churchbank Weir Road 'Mutdapilly Cemetery'		Mutdapilly	L135 MAR611	Cemetery	Whole Lot
Mutdapilly-Churchbank Weir Road 'Mutdapilly State School'	4	Mutdapilly	L1 RP28488	School	Whole Lot excluding all post 1946 buildings and structures
Neumann Road	Lot 21	Calvert	L21 CH312056	Dwelling	Main house
Neundorff's Road	1-67	Tallegalla	L3 RP127117	Farmhouse	Main house
New Chum Road 'St Matthew's Anglican Church'	8	Dinmore	L33 RP810679	Church	Whole Lot excluding all post 1946 buildings and structures
Nicholas Street 'Ipswich Soldier's Memorial Hall R.S.L.A'	63	Ipswich	Lot 4 I16193	Memorial Hall	Whole Lot





Address/Site Name	Street No.	Suburb	RPD	Description	Extent of Significance
Nicholas Street 'Masonic Temple'	82	Ipswich	L32 I122421 L2 RP2872	Masonic Temple	Whole Lot excluding all post 1946 buildings & structures
North Street 'St Matthew's Lutheran Church'	14	Harrisville	L3 RP160253	Church	Whole Lot excluding all post 1946 buildings & structures
North Street 'Mihi Line'	1A	North Ipswich	L233 RP807126	Original Rail Line	Area outlined with shading on attached Plan No. 27
North Street 'Ipswich Railway Workshops & Memorial'	3B, 10A, 19A	North Ipswich	L52 SP222487 L35 SP175172 L32 SP151433	Railway workshops complex including Memorial	Area outlined on attached Plan No. 28. Historic buildings are shaded
Old Logan Road	11	Gailes	L1 RP36907	Dwelling	Whole Lot
Old Logan Road	40	Gailes	L1/2 RP36910	Dwelling	Whole Lot
Old Toowoomba Road 'West Ipswich & One Mile War Memorial'	1A	One Mile	402 CC895	Memorial	To the extent of the memorial's concrete apron
Old Toowoomba Road	13	One Mile	L23 RP8332	Shop	Whole Lot including the street awning and excluding all post 1946 buildings & structures
Omar Street 'West Ipswich State School'	12	West Ipswich	L522 SL8755	School	Whole Lot excluding all post 1946 buildings & structures
Palaszczuk Avenue 'Verrall Family Pioneer Graves'	7	Collingwood Park	L900 SP266991	Cemetery	Area outlined on attached Plan No. 7
Pine Mountain Road 'Brassall State School'	130 and 132A	Brassall	L212 SP127608	School	Blocks A, B & C
Pine Mountain Road 'Boody's Store'	145	Brassall	L21 RP14755	Shop and residence	Shop (excluding side extensions) and attached residence (excluding extensions)
Pine Mountain Road 'Anglican Cemetery'	841-863	Pine Mountain	L1 & L2 SP103268	Cemetery	Fenced Cemetery
Pine Mountain Road 'Pine Mountain Public Hall'	840	Pine Mountain	L1 RP50699	Hall	Whole Lot
Pine Mountain Road 'St Michaels Catholic Church'	850 – 856	Pine Mountain	L1 RP8351 L2 RP50699	Church & graveyard	Whole Site
Pine Mountain Road 'Congregational Cemetery'	875-891	Pine Mountain	L501 SP243525	Cemetery	Whole Site
Pine Mountain Road 'Ipswich – Gatton Road Distance Marker'		North Ipswich	On the footpath outside the property at 48 Pine Mountain Road	Road Distance Marker	Area outlined on attached Plan No. 30
Pine Mountain Road	Lot 315	Pine Mountain	L315 CH3124	Dwelling	Main house
Pine Mountain Road	11	North Ipswich	L90 SP165973	Shops	Whole Lot
Pine Mountain Road 'St Joseph's Primary School Fence balusters'	42	North Ipswich	L1 SL837992	Fence	Balusters only (four bays). Excluding rendered masonry fence along the Pine Mountain Road boundary
Pine Mountain Road	899-931	Pine Mountain	L104 RP163025	Dwelling	Main house
Pine Mountain Road 'Watercross Creek'	978	Pine Mountain	L2 RP198973	Dwelling	Main house



Address/Site Name	Street No.	Suburb	RPD	Description	Extent of Significance
Pine Mountain Road	1023-1049	Pine Mountain	L316 CH3124	Dwelling	Main house and detached kitchen wing
Pine Mountain Road	1166	Pine Mountain	L184 CH311658	Dwelling	Main house
Pommer Street 'Brassall Methodist Church Buildings'	2	Brassall	L170 I16155	Church buildings	Whole Lot excluding all post 1946 buildings & structures
Poppy Lane	9	Tivoli	L8/9 RP119035	Dwelling	Whole Site
Post Office Lane	4	Harrisville	L2 RP63088	Dwelling	Whole Lot excluding all post 1946 buildings & structures
Purga School Road	68	Purga	L52 CP868789	Church	Fenced area within lot, excluding all post 1946 buildings & structures
Purga School Road 'Anna Bauer House' (Purga State School)	72	Purga	L25 CP868789	Former School	Main house excluding all post 1946 buildings & structures
Queen Street	6 & 6a	Goodna	L3 RP2466 L2 RP223781	Sisters of Mercy Building	Whole Lot excluding all post 1946 buildings & structures
Queen Street 'Goodna Neighbourhood House'	33	Goodna	L2 RP2464	Dwelling	Whole Lot excluding all post 1946 buildings & structures
Queen Street 'The Meaney's House'	51	Goodna	L8 RP142973	Dwelling	Whole Lot
Queen Street 'Harrisville Butchery'	28	Harrisville	L3 RP21439	Shop	Whole Lot and the street awning
Queen Street 'Former Pugsleys Store'	30	Harrisville	L2 RP21439	Shop	Whole Lot and the street awning
Queen Street 'Commercial Hotel'	32-34	Harrisville	L1 RP21439	Hotel	Whole Lot and the street awning
Queen Street 'Jenny's Country Cottage'	33	Harrisville	L16 RP21418	Shop	Whole Lot and the street awning
Queen Street	35	Harrisville	L17 RP21418	Bank	Whole Lot
Queen Street 'Newsagency'	37	Harrisville	L1 RP21462	Shop	Whole Lot and the street awning
Queen Street 'Faulkners Store'	39-41	Harrisville	L2 RP21463	Shop	Whole Lot and the street awning
Queen Street 'Memorial Park'	43-47	Harrisville	L2 RP48583	Entrance Gate & memorials	Entrance Gate, Brick wall with sundial, flagpole and centenary plaque
Queen Street 'Harrisville School of Arts'	49	Harrisville	L4 RP21456	Hall	Whole Lot
Queen Street 'Elanda House'	52	Harrisville	L26 RP21439	Dwelling	5 metre wide area surrounding Elanda House
Queen Street 'Sacred Heart Catholic Church'	54	Harrisville	L36-37 RP21437	Church	Whole Lot
Queen Street 'Former Baptist Church (All Things Country)'	89-93	Marburg	L1 RP35808	Church	Whole Lot excluding all post 1946 buildings & structures



Address/Site Name	Street No.	Suburb	RPD	Description	Extent of Significance
Queen Street 'All Saints Anglican Church & Hall'	111	Marburg	L1 RP51100	Church	Whole of allotment excluding all post 1946 buildings & structures
Queen Street 'Marburg Court House Precinct'	113-117	Marburg	L551 CH31440	Court House Residence Lockup	Whole Lot
Queen Street 'Walloon Saloon'	1-3	Walloon	L1 RP42876	Hotel	Whole Lot excluding all post 1946 buildings and structures
Queen Street	7	Walloon	L3 RP35551	Dwelling	Whole Lot
Queen Street	16	Walloon	L8 RP35547	Dwelling	Whole Lot
Queen Street	17	Walloon	L5 RP35552	Dwelling	Whole Lot
Queen Street	18-20	Walloon	L9-10 RP35547	Dwelling	Whole Lot
Queen Street 'St Andrews Catholic Church'	40	Walloon	L4 RP168771	Church	Whole Lot
Queen Victoria Parade Milford Street 'Former Ipswich Central State School'	1 2A	Ipswich	L1 RP24380 L407 N25605	School	Whole Site Excluding all post 1946 buildings and structures
Queen Victoria Parade 'Cunningham's Knoll'	1A	Ipswich	L409 CP911396	Historic Lime Kiln Site, monuments	Whole Site including lime kilns, monuments and stone walls
Rafters Road 'Grandchester Cemetery'	Lot 7-8	Grandchester	Part of Lots 7 & 8 CC3502	Cemetery	Whole Site
Railway Street 'Crossing keeper's cottage'	1	Grandchester	L1 G12520	Dwelling	Whole Lot
Railway Street 'Rosewood Railway Station Complex'		Rosewood	L231 M333225	Rosewood Railway Station	Area including main station, south platform shelter, overhead footbridge, Bondwood Hut and turntable as outlined on attached Plan 31.
Railway Street 'Rosewood Police Residence & Stables'	1A	Rosewood	L734 CP898268	Police Station	Whole Lot, excluding all post 1946 buildings and structures
Railway Terrace 'The Cross House'	11	Goodna	L9 RP846606	Dwelling	Whole Lot
Redbank Plains Road 'Cooneana'	1041	New Chum	L1 RP147956	Dwelling	Whole Lot
Redbank Plains Road 'Rhondda Office and Carport'	1041	New Chum	L1 RP147956	Office building	Office building and carport
Redbank Plains Road 'Turf Farm House'	639	Redbank Plains	L1 RP102884	Dwelling	Main house
Reinke Road 'Ashwell Primary School Precinct'	33-37	Ashwell	L1 RP35846 L1 RP35761	School	Whole Site
Riverside Drive	63	Muirlea	L243 SL3149	Reservoir Precinct	1906 Reservoir, Steel



Address/Site Name	Street No.	Suburb	RPD	Description	Extent of Significance
					Surge Tower, Water Officer's House within the area as outlined on attached Plan No. 32
Richards Street	7	North Ipswich	L114 RP75591	Dwelling	Whole Lot
Riverside Drive 'Blythe Villa'		Muirlea	L3 RP103828	Dwelling	Whole Lot
Riverview Road 'Canaan' and 'Anchorage Farm Manager's Residence'	29	Riverview	L2 RP22229	Hostel	To the extent of the 1897 fenced enclosure as outlined on attached Plan No. 33
Robertson Road 'Fairy Knoll'	2A	Eastern Heights	L1 SP139414	Dwelling	Whole Lot
Robertson Road 'Our Lady of the Miraculous Medal'	35A	Eastern Heights	L1 SP129729	Church	Church building
Robertson Road	55	Eastern Heights	L2 RP99868	Dwelling	Whole Lot
Roderick Street	8	Ipswich	L1 RP67771	Dwelling	Whole Lot
Roderick Street 'Keiraville'	20	Ipswich	L1 RP193697	Dwelling	Whole Lot
Roderick Street 'St John's Lutheran Church'	32	Ipswich	L95 I165	Church	Church building
Roma Street	1	North Booval	L4 RP23753	Dwelling	Whole Lot
Roseberry Parade 'Woodend War Memorial'		Woodend	Road Reserve	Memorial	To the extent of the memorial's concrete apron
Rosewood Road 'Amberley RAAF Base'	1A	Amberley	Various	RAAF Base	Diamond Shaped Command Precinct including parade ground & associated landscaping, Guardhouse, 301 Air Base Headquarters, The Base Medical Flight Building, Air Base support building, Hangar 76, Ap1-1 semi subterranean operations building, 745 Bellman Hangar, Riley Newsum houses - Gannett St, School House & residence, Army Helicopter & Fixed Wing training area (Silver City), Emergency Power Generator, Cinema, Airmen's Mess, Sargent's Mess, Bellman Hangars, Air Safety Building as outlined with shading on attached Plan No. 34
Rosewood-Marburg Road 'Tallegalla Cemetery'	Lot 282	Tallegalla	L282 C876	Cemetery	Whole Lot
Rosewood-Marburg Road	357-363	Tallegalla	L674 CH31976	Former shop & residence	The shop & residence including the 10 metre setback from Rosewood-Marburg Road



Address/Site Name	Street No.	Suburb	RPD	Description	Extent of Significance
Rosewood-Marburg Road	568-660	Tallegalla	L5 RP856385	Farmhouse	Main house
Rosewood-Marburg Road	670-676	Tallegalla	L5 RP841163	Farmhouse	Whole Lot
Rosewood-Warrill View Road	2-4	Rosewood	L1 RP128580	Dwelling	Whole Lot
Rosewood-Warrill View Road	14-16	Rosewood	L1 RP50227	Dwelling	Whole Lot
Ross Llewellyn Drive 'Mines Rescue Station'	2	Booval	L402 SP183032	Mines Rescue Complex	Mines Rescue Complex excluding outbuildings
Russells Road	106	Pine Mountain	L291 CH3123	Dwelling	Main house
Salisbury Road 'University of QLD Ipswich Campus'	11	Ipswich	L506 CP883330	University 'Former Challinor Centre'	Whole Lot excluding all post 1946 buildings and structures
School Road 'Grandchester Community Hall'	Lot 216	Grandchester	L216 CC3251	Hall	Whole Lot
School Road 'Redbank Plains State School'	39-53	Redbank Plains	L466 CP891085	School	Old classroom building and play-shed as outlined with shading on attached Plan No. 35
School Road 'Yarrow Centre'	55	Redbank Plains	L1 SL8922	Former Church	Whole Lot
School Road 'Rhosmyne'	99-105	Redbank Plains	L1 RP160000	Farmhouse	Whole Lot
School Street 'Marburg State Primary School'	Lot 701	Marburg	L701 CC2239	School	Whole Lot excluding all post 1946 buildings and structures
School Street 'The Palms'	35-37	Marburg	L 2 RP152244	Dwelling	Whole Lot
School Street 'Rosewood Primary School'	Lot 365	Rosewood	L365 CC2765	School	Teaching Blocks A & B
Schultzs Road	32	Ironbark	L8 SP124708	Dwelling	Fenced house Lot
Seminary Road 'Anglican Cemetery'	Lot 1	Marburg	L1 CC3183	Cemetery	Whole Lot
Seminary Road 'Woodlands'	Lot 12	Marburg	L21 CC1898	House & Outbuildings	Whole Lot excluding all post 1946 buildings and structures
Short Street	12	Ipswich	L3 RP3006	Dwelling	Whole Lot
Short Street	2-4	Walloon	L1 RP35541	Dwelling	Whole Lot
Sloman Street 'Dun Edin'	9	Booval	L2 RP50390	Dwelling	Whole Lot
Smith Street 'World War II Ammunition magazine'	31	Redbank	L90 M311	Ammunition magazine	6 metre wide area surrounding the 'Ammunition magazine'
South Station Road	3	Booval	L2 RP64616	Shop	Whole Lot
South Station Road 'Cambrian Centre'	8	Booval	L7 RP23818	Hall	Whole Lot
South Station Road	35	Booval	L2 RP48302	Shop	Whole Lot
South Station Road 'Glenville House'	128	Silkstone	L1 RP62232	Dwelling	Whole Lot
South Station Road	129	Silkstone	L1 GTP102703	Dwelling	Whole Lot



Address/Site Name	Street No.	Suburb	RPD	Description	Extent of Significance
South Station Road	143	Silkstone	L1 RP118180	Dwelling	Whole Lot
South Station Road	145	Silkstone	L4 RP24265	Dwelling	Whole Lot
South Street 'Bowerlea'	2	Ipswich	L1 RP47224	Dwelling	Whole Lot
South Street 'Salvation Army Citadel'	62	Ipswich	L1 RP167671	Church	Whole Lot excluding all post 1946 buildings & structures
Station Lane 'Walloon Railway Station'		Walloon	L2 RP35557 & L2 RP35540	Railway Station	North side platform building and southern side platform shelter only
Station Road		Riverview	L2 RP22337 and L112 SP130148	Riverview Railway Station	Footbridge and Timber Platform Shelter
Stevens Road 'Wycombe Lodge'	173-225	Ashwell	L2 RP214351	Farm complex	Farm complex outlined on attached Plan No. 36
Stevens Road 'Stoneleigh'	271	Ashwell	L6 RP814613	Dwelling	Main house
Stevens Road	1-85	Lanefield	L2 RP217630	Farmhouse	Fenced house yard
Stevens Road	174-220	Lanefield	L2 RP22841	Farmhouse	Main house
Stocks Lane	2-4	Walloon	L23 RP35546	Dwelling	Whole Lot excluding the post 1946 additions and extensions
Stokes Road Also known as 'Lady Bowen Hill'		Grandchester	L217 CC3466	Dwelling	Main house
Stokes Road	Lot 303	Pine Mountain	L303 CH3123	Dwelling	Original house and slab hut
Stone Quarry Road	Lot 305	Jeebropilly	L305 CC3467	Cemetery	Whole Lot
Swan Street 'Jordan Village Pensioners' cottages'	27	Brassall	L20 RP234480	Dwellings	Whole Lot
Symes Street 'Grandchester Sawmill'	Lot 5	Grandchester	L407-408 CC3479	Sawmill	Whole Site
Tallegalla Road 'Former Station Master's Residence'	25-29	Tallegalla	L2 CC2670	Dwelling	Main house
Tallegalla-Two Tree Hill Road 'Pioneer Catholic Cemetery'	Lot 1	Tallegalla	L1 RP175693	Small bush cemetery with approx. 12 graves still showing with headstones	Area outlined on attached Plan No. 37
Tallegalla-Two Tree Hill Road 'Tallegalla Primary School Precinct'	2	Tallegalla	L557 CC3651	School	Whole Lot
Tallon Street	13	Sadliers Crossing	L3 RP3068	Shop	Whole Lot
Tantivy Street 'Tivoli Hill Horse Trough'		Tivoli	Road Reserve	Horse Trough	Area outlined on attached Plan No. 25
Taylor Street	7	Bundamba	L53 RP22506	Dwelling	Whole Lot
Thagoona-Haigslea Road 'Haigslea State School'	752-766	Haigslea	L263 CC2097	School	The original classrooms



Address/Site Name	Street No.	Suburb	RPD	Description	Extent of Significance
Thagoona-Haigslea Road 'Haigslea Uniting Church'	761-767	Haigslea	L1 RP 35713	Church	Whole Lot excluding all post 1946 buildings and structures
The Terrace 'Railways Store Building'	6	North Ipswich	L37 SP203402	Former Railway Workshops Administration Building & former Tarpaulin Shop	To the extent of the Railways Store Building + 10 m around building
The Terrace 'Strand Hotel'	12	North Ipswich	L107 RP846750	Hotel	Whole Lot excluding all post 1946 buildings & structures
The Terrace 'Queensland Woollen Manufacturing Company Ltd'	42-42B	North Ipswich	L1-2 RP137425	Industrial complex & 'World War II Air-Raid Shelter'	Whole Site excluding all post 1946 buildings and structures
Thomas Street 'Railway Station'		Sadliers Crossing	L152 SL1126	Railway Station	Platforms, shelter sheds and the Thomas Street Pedestrian Underpass
Thomas Street 'United Welsh Church'	6	Blackstone	L5 RP22448	Church	Whole Lot
Thorn Street 'Colthup Home'	39	Ipswich	L1 RP836941	Dwelling	Original house
Thorn Street	42	Ipswich	L4 RP2935	Dwelling	Whole Lot
Union Place Mall 'Commonwealth Hotel'	5	Ipswich	L1 RP2677	Hotel	Whole Lot
Unnamed Road off Carmichaels Road 'Purga Cemetery'	Lot 217	Purga	L217 CP858790	Aboriginal Cemetery	Whole Lot
Unnamed Road off Sams Reserve	Lot 8	Redbank Plains	L8 SP109237	Dwelling	Main house
Warrego Highway	1445	Blacksoil	L1 RP899036	Dwelling	Original house and shed
Warrego Highway	2236-2302	Haigslea	L2 CC2992	Dwelling	Main house
Warrego Highway 'Gerber's Farmhouse'		Marburg	L5 RP209497	Dwelling	Main house
Warrego Highway 'Trinity Lutheran Cemetery'	Lot 1	Marburg	L1 RP35866	Cemetery	Whole Lot
Warrego Highway 'The Hay Man'	2460-2486	Marburg	L2 RP 159831	Farmhouse	Main house
Warrego Highway 'Haighmoor Coke Ovens'		North Tivoli	L2 RP885020	Industrial Item	Area outlined on attached Plan No. 38
Warrill View-Peak Crossing Road 'The Cedars'		Harrisville	L2 RP97945	Farmhouse	Main house
Warrill View-Peak Crossing Road 'Harrisville Cemetery'	Lot 81	Harrisville	L81 C840	Cemetery	Whole Lot





Address/Site Name	Street No.	Suburb	RPD	Description	Extent of Significance
Warrill View-Peak Crossing Road 'Pump'		Peak Crossing	Road Reserve	Industrial item	Road reserve adjacent to L207 CH3165, within the area outlined on attached Plan No. 39
Warrill View-Peak Crossing Road 'Flinders Uniting Church'	Lot 1	Peak Crossing	L1 RP21474	Church	Whole Lot excluding all post 1946 buildings and structures
Warwick Road	220	Churchill	L1 RP137547	Dwelling	Whole Lot
Warwick Road 'Churchill Honour Stone' Lobley Park	243A	Churchill	L1 RP811294	Memorial	To the extent of the memorial's concrete apron
Warwick Road 'Nerita Memorial Gates, Ipswich Showgrounds'	81	Ipswich	L477 SL7290	Memorial	2 metre wide area surrounding the memorial gate
Warwick Road 'Ipswich General Cemetery'	124A	Ipswich	L543 I1683	Cemetery	Whole Lot
Waterworks Road	1	North Ipswich	L9 RP14735	Shop	Whole Lot
Waterworks Road 'North Ipswich Bible Methodist Church'	1A	North Ipswich	L10 RP14736	Church	Whole Lot excluding all post 1946 buildings and structures
Weedman Street 'Redbank Mine'	6	Redbank	L3 RP110496	Historic Mining Site	Whole Lot
Wildey Street 'Raceview State School Memorial Gateway'	96	Raceview	L460 SL8632	Gateway	2 metre wide area surrounding the 'S.J. Dunsden Esq. Gateway'
Wildey Street 'Raceview Congregational Church'	117	Raceview	L54 SP173935	Church	Church building
Wildey Street	185	Raceview	L1 RP64061	Dwelling	Whole Lot
William Street 'Penhelyg'	43	Goodna	L4 RP96169	Dwelling	Whole Lot
Williams Street 'Inglemere' and cottage	110	Coalfalls	L1 RP880167	Dwellings	Whole Lot
Woodend Road 'Ipswich Grammar School'	1A	Sadliers Crossing	L393 RP910070	Original School buildings	Whole Lot excluding all post 1946 buildings and structures
Woodend Road	66	Woodend	L2 RP3114	Shop	Whole Lot
Woodend Road	90	Woodend	L2 RP58502	Shop	Whole Lot
Woogaroo Street "Woogaroo Creek Railway Bridge" at eastern end of Woogaroo Street Goodna.		Goodna	L91 SP130140 L94 SP130139	Bridge	Bridge
World War II remains		White Rock	L246 NPW526 L4 RP217549	Ruins	10m around each site within the area outlined on attached Plan No. 40





## Part 2—Trees and Vegetation

Address/Site Name	Street No.	Suburb	RPD	Description & Significance
Alice Street	118	Goodna	L2 RP96538	<b>Port Jackson Fig (<i>Ficus rubiginosa</i>)</b> Located on the Alice Street frontage of the Lot
Alice Street and Spalding Crescent, intersection	-	Goodna	Road Reserve	<b>Gum-topped Box (<i>Eucalyptus moluccana</i>)</b> Located in the road reserve on the north western corner of the Alice Street and Spalding Crescent intersection.
Augusta Parkway	Lot 7	Springfield	L7 SP143597	<b>Ficus Species</b> 1 small leaved Moreton Bay Fig ( <i>Ficus platy poda</i> ) 1 small leaved fig ( <i>Ficus acroca</i> var <i>petiolaris</i> ) as outlined on attached Plan No. 41
Brisbane Terrace, between Short St & Lower James St 'Depression Work Relief Plantings'	Road Reserve 135	Goodna	Road Reserve L128 SP178961	<b>Depression Work Relief Plantings Precinct</b> Species include Queensland Kauri ( <i>Agathis robusta</i> ), Bunya Pines ( <i>Araucaria bidwillii</i> ), Silky Oaks ( <i>Grevillea robusta</i> ) and Jacaranda ( <i>Jacaranda mimosaeifolia</i> ). Listing boundary: the footpath and road reserve as outlined on attached Plan No. 42
Brisbane Street 'Cunningham's Knoll'		Ipswich		<b>2 Ficus Species</b> Located on the top of Cunningham's Knoll
Brisbane Street Milford Street 'Former Central State School'	1 2A	Ipswich	L1 RP24380 L407 N25605	<b>Ficus Species</b> Perimeter Plantings along the street frontages
Byrne Street	22	Bundamba	L503 CP910076	<b>Lone Bunya Pine (<i>Araucaria bidwillii</i>) &amp; stand of Grass Trees (<i>Xanthorrhoea johnstoni</i>)</b> Area outlined on attached Plan No. 43
Chermside Road 'Ipswich Girls Grammar School'	82	Ipswich	L167 SP139377	<b>Ficus Species and Hoop Pines</b> along the Chermside Road street frontage <b>Jacarandas, Pinus Species and Camphor Laurels</b> Located along the driveway between Queen Victoria Parade and Chermside Road, within the area outlined on attached Plan No. 44
Chermside Road	87	East Ipswich	L1 RP155083	<b>Weeping Fig (<i>Ficus benjamina</i>)</b> The Ficus species in the front yard
Church Street	14	Goodna	L189 SL5041	<b>Eucalyptus species</b> Large Grey Gum located on the Church Street frontage
Cunningham Highway	2673	Willowbank	L2 RP213075	<b>Avenue of bunya pines (<i>Araucaria bidwillii</i>)</b> from the highway to the main house
Cyprus Street	40	Raymonds Hill	L1 RP97883	<b>Camphor Laurel Trees (<i>Cinnamomum camphora</i>)</b> The camphor laurel trees located at the Cyprus Street frontage of the Lot



Address/Site Name	Street No.	Suburb	RPD	Description & Significance
Glebe Road	7-7A	Newtown	L24-25 RP24128	<b>Campbell Fig (Ficus species)</b> Located at the Glebe Road frontage of the Lot
Glebe Road 'Silkstone State School Plantings'	95	Silkstone	L15 RP24241	<b>Historic School Plantings</b> Perimeter plantings particularly the Ficus Species & 3 Araucaria cunninghamii near the Glebe Road frontage; the avenue of paired Figs, Camphor Laurels & Jacaranda trees extending from Glebe Road south to the school quadrangle; & the Fig species bordering the northern perimeter of the playing fields fronting Blackstone Road
Griffith Road 'Ipswich Central State School Plantings'	2	Ipswich	L442 SL4125	<b>Hoop Pines</b> Row of mature Hoop Pines situated along the Griffith Road Perimeter
Ipswich-Boonah Road 'Bullion Park'		Purga	L2 RP106091	Avenue of trees along driveway from Ipswich-Boonah Road to the house
Jacaranda Street	111	North Booval	L1 RP209454	<b>Jacaranda Trees (Jacaranda mimosifolia)</b> <b>Moreton Bay Fig Tree (Ficus macrophylla)</b> Canopy and root system to extent of 10m radius from exterior of trunk at a height of 2m of Moreton Bay Fig at 3 Roma Street. Refer Plan No. 59 and Plan No. 60
John Street	7-9	Rosewood	L9 RP906761	<b>Hoop Pine (Araucaria cunninghamii)</b> Located at the John Street frontage of the Lot
John Street	17	Rosewood		<b>Fig (Ficus species) 'Tree of Knowledge'</b> Located at the John Street frontage of the Lot
Limestone Street	88	Ipswich	L1 I16237	<b>Queen Victoria Silver Jubilee Memorial Technical College Grounds</b> Two Ficus species located at the Ellenborough Street frontage of the Lot
Mary Street 'St Edmunds College Plantings'	16	Woodend	L3 RP889302	<b>Camphor Laurel, Ficus Species and Jacaranda Species</b> Located along the Mary Street frontage of the site
Murphy Street	16-18	Ipswich	L18 RP889299	<b>Hoop Pine Trees (Araucaria cunninghamii)</b> Located along the rear alignment of the Lot
North Street 'Ipswich Railway Workshop Plantings'	1A	North Ipswich	L233 RP807126	<b>Ficus species &amp; Camphor Laurels</b> The two trees located in close proximity to the World War I digger memorial are Camphor Laurels. Two Ficus species are located to the northwesterly and southerly borders of a rectangular lawn area, divided by a concrete roadway, and situated between the administration building to the north and the tool and gauge shop to the east and the Canteen to the South. Areas outlined on attached Plan No. 46
Old Toowoomba Rd	22	One Mile	L1 RP202579	<b>Port Jackson Fig (Ficus rubiginosa)</b> Located at the Old Toowoomba Road frontage of the Lot



Address/Site Name	Street No.	Suburb	RPD	Description & Significance
Olmair Avenue		Eastern Heights	Road Reserve	<b>Former Bleak House Driveways' Plantings</b> Camphor Laurels, Ficus and Poicianas located on either side of the road reserve between Blackstone Road and Marvin Street.
O'Sullivan Street	35	Woodend	L17 RP24276	<b>Camphor Laurel (Cinnamomum camphora)</b> Located at the O'Sullivan Street frontage of the Lot
O'Sullivan Street	40	Woodend	L5 RP24280	<b>Ficus acrocarpa</b> 2 small fruited figs
Pine Mountain Road	603-623	Muirlea	L2 RP163572	<b>Moreton Bay Fig (Ficus Macrophylla)</b> Area outlined on attached Plan No. 47
Pine Mountain Road & Smith Street Intersection		North Ipswich	Road Reserve	<b>Ficus</b> Located within the Smith Street traffic island at the Pine Mountain Road intersection
Pine Street & The Terrace Intersection		North Ipswich	Road Reserve	<b>Ficus</b> 2 Figs located within the roundabout at the intersection of Pine Street & The Terrace
Pine Street	60	North Ipswich	L176 I1626	<b>Poinciana Tree (Delonix regia)</b> Located at the Pine Street frontage of the Lot
Queen Victoria Parade		Ipswich		<b>Ficus Microcarpa Var. Hilli interspaced with Jacaranda (Jacaranda Mimosafolia) and Fan Palm (Livistona Species)</b> Situated on both sides of the Queen Victoria Parade road reserve between Chermiside Road to Milford Street
Railway Street	29	Booval	L1 RP44621	<b>Johnson River Fig (Ficus acrocarpa)</b> Located at the rear of the Lot fronting Booval Street
Riverview Road	29	Riverview	L29 S151811	<b>Bunya Pines (Araucaria bidwillii)</b> Driveway avenue plantings (2 rows) from Riverview Road to the main house
Roderick Street	9	Ipswich	L3 I1686	<b>Bottle Tree (Brachychiton rupestris)</b> Located at the Roderick Street frontage of the Lot
Roma Street	1	North Booval	L4 RP23753	<b>Moreton Bay Fig Tree (Ficus macrophylla)</b> Canopy and buttress roots to extent of 10m radius from exterior of trunk at a height of 2m of Moreton Bay Fig at 3 Roma Street. Refer plan No. 60
Roma Street	3	North Booval	L5 RP23753	<b>Moreton Bay Fig Tree (Ficus macrophylla)</b> Canopy and buttress roots to extent of 10m radius from exterior of trunk at a height of 2m. Refer plan No. 60
Salisbury Road 'University of Queensland Ipswich Campus'	11	Ipswich	L506 CP883330	<b>Ficus Species and Araucaria Species</b> Located near the carpark off Parker Avenue as outlined on attached Plan No. 49



Address/Site Name	Street No.	Suburb	RPD	Description & Significance
School Street	Lot 701	Marburg	L701 CC2239	<b>Marburg State Primary School Environmental Park &amp; Perimeter/ Driveway Plantings</b> Driveway avenue plantings of Ficus Species and the Environmental Park that includes Silky Oak ( <i>Grevillea robusta</i> ) & Hoop Pines ( <i>Araucaria cunninghamii</i> ) as outlined on attached Plan No. 50
School Street 'Rosewood State Primary School'	Lot 365	Rosewood	L365 CC2765	<b>Bunya Pine (<i>Araucaria bidwillii</i>)</b>
Station Road	16-20	Riverview	L56-58 RP22329	<b>Fig Trees (<i>Ficus microcarpa</i>)</b> Two Fig Trees located at the Station Road frontage of the Lots
Thomas Street	6	Blackstone	L5 RP22448	<b>United Welsh Church Camphor Laurel (<i>Cinnamomum caphora</i>)</b> Located 20 metres along the northern boundary of the site off the Thomas Street frontage of the Lot
Thomas Street		Sadliers Crossing	Road reserve	<b>Thomas Street Railway Station</b> Plantings on the southern side of the Tallon Street road reserve between Challinor Street and Stephenson Street comprising Ficus Species, Pinus Species, Eucalyptus Species, Jacaranda mimosofli & Camphor Laurel ( <i>Cinnamomum caphora</i> ) Species
Warwick Road	81	Ipswich	L477 SL7290	<b>Ipswich Showgrounds Border Plantings</b> Various species located at the Warwick Road frontage of the Lot comprising the Bunya Pines ( <i>Araucaria</i> species), Ficus species and Camphor Laurel
Western Creek watercourse and Gipps Street road reserve	-	Calvert	-	<b>Forest Red Gum (<i>Eucalyptus tereticornis</i>)</b> Located southeast of a bridge over the Western Creek, and between the Western Creek watercourse and the Gipps Street road reserve. Refer Plan No. 58
Whitehill Road	34	Eastern Heights	L26 RP24284	<b>Weeping Fig (<i>Ficus benjamina</i>)</b> Located at the Whitehill Road frontage of the Lot
Wildey Street	102	Raceview	L3 RP96509	<b>Poinciana Tree (<i>Delonix regia</i>)</b> Located at the Wildey Street frontage of the Lot
Wildey Street	143	Raceview	L4 RP90671	<b>Fig (<i>Ficus</i> species) 'The Christmas Lights Tree'</b> Refer Plan No. 51
Woodford Street	42	Leichhardt	L1 RP123586	<b>Camphor Laurel</b> Located at the Woodford Street frontage of the Lot
Woodford Street	80A	Leichhardt	L3 RP8309	<b>Port Jackson Fig &amp; Moreton Bay Fig</b> Located at the Woodford Street frontage of the Lot



**Part 3—Indigenous**

Address/Site Name	Street No.	Suburb	RPD	Description	Extent of Significance
Kruger Parade 'Redbank Rifle Range'	2-74	Redbank	L2 SP229584	Scatter	To the extent of the scatter outlined on attached Plan No. 52
Deebing Creek Road 'Deebing Creek Mission'		Deebing Heights	L218 CC2906	Former Mission	Whole Lot
Emma Street	54	Bundamba	L2 RP163917	Scatter	To the extent of the scatter outlined on attached Plan No. 53
Flinders Peak		Peak Crossing	L166 CC3584	Geological formation	Whole Lot
Graham Street		Blackstone	Road Reserve	Scatter	To the extent of the scatter outlined on attached Plan No. 54
Ipswich-Boonah Road 'Purga Mission'	587	Purga	L60 CC1433	Former Mission	Whole Lot excluding all post 1946 buildings and structures
Ivory's Rock		Peak Crossing	L132 SP114803	Geological formation	Whole Lot
Kertes Road	Lot 101	Camira	L101 CP883328	Bora Ring	Whole Lot
Naomai Street	21	Bundamba	L162 SL5177	Scatter	To the extent of the scatter outlined on attached Plan No. 55
Unnamed Road 'Deebing Creek Cemetery'		Deebing Heights	L228 CC2905	Cemetery	Whole Lot
Unnamed Road		Mt Marrow	L1 RP102071 L2 RP130943	Stone Arrangement & Bora Ring	Whole Site
Unnamed road off Carmichael's Road 'Purga Cemetery'		Purga	L217 CP858790	Cemetery	Whole Lot
Unnamed Road		Spring Mountain	L246 NPW526	Scatters	To the extent of the scatters outlined on attached Plan No. 56
White Rock		White Rock	L246 NPW526 L1 SP130834 L211 & 219 SL5454	Geological formation	Whole Lot



Plan No. 1: 'The Boghole'

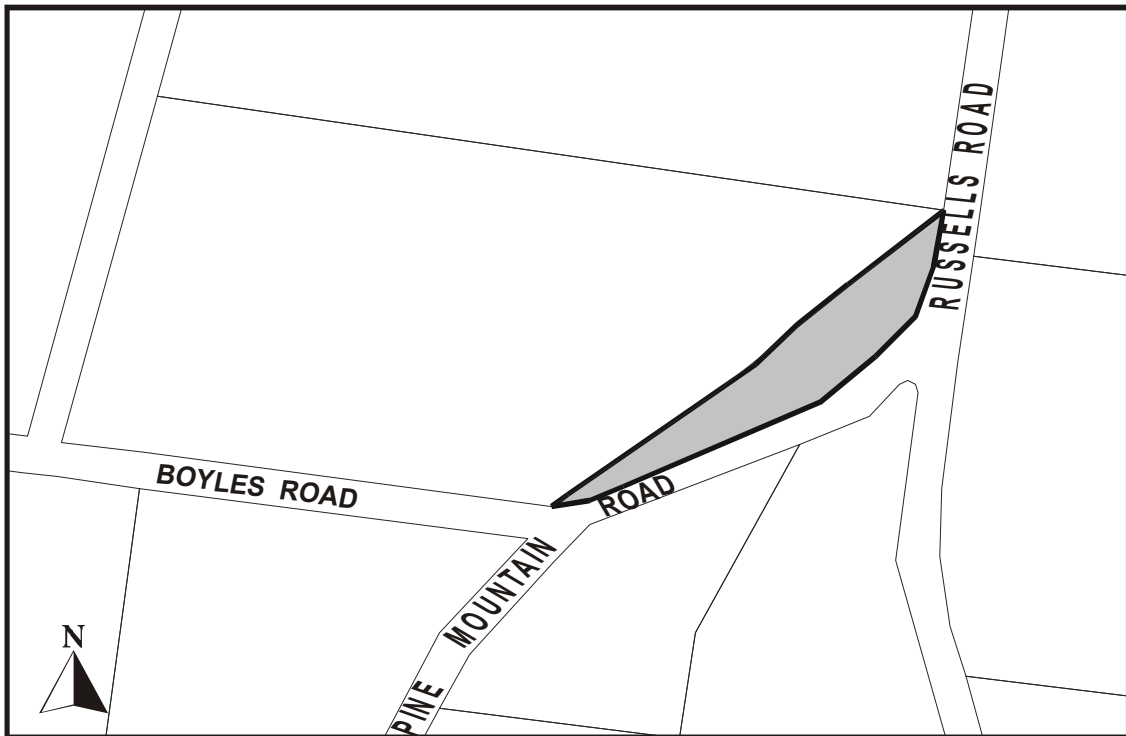

Plan No. 2: 'Bremer Road Railway Bridge'

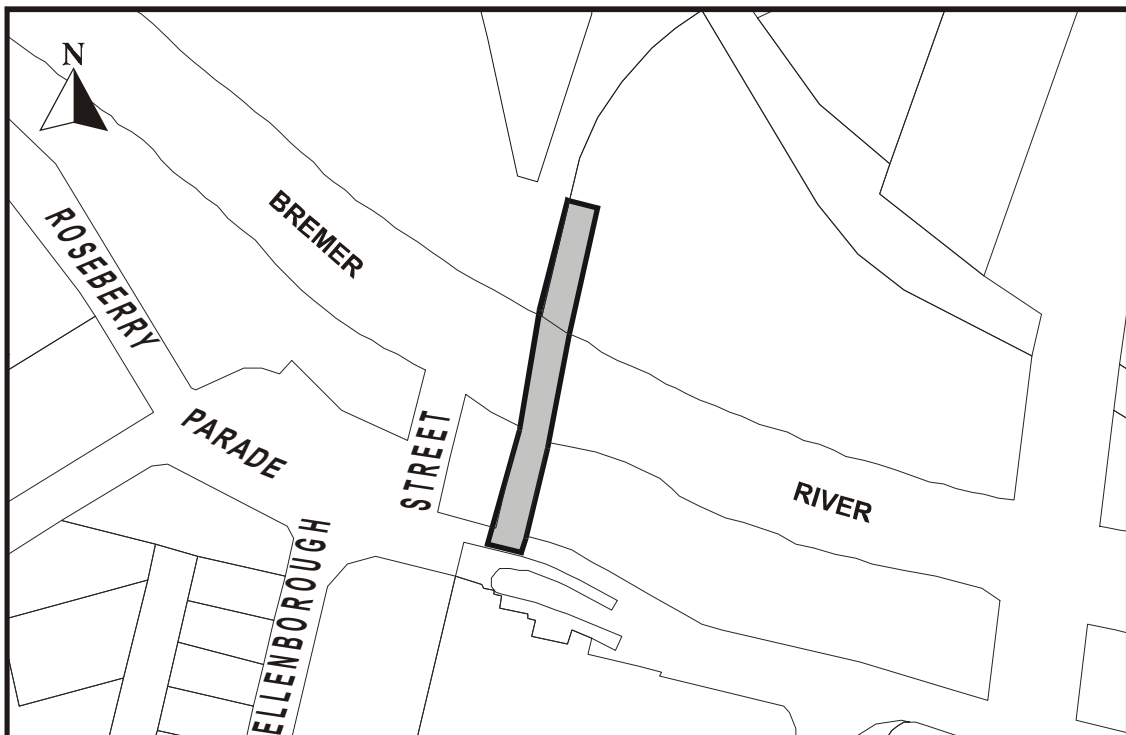

Further details in relation to each site may be obtained from the Ipswich City Council Geographic Information System



Plan No. 3: 'Ipswich – Brisbane Road Distance Marker'

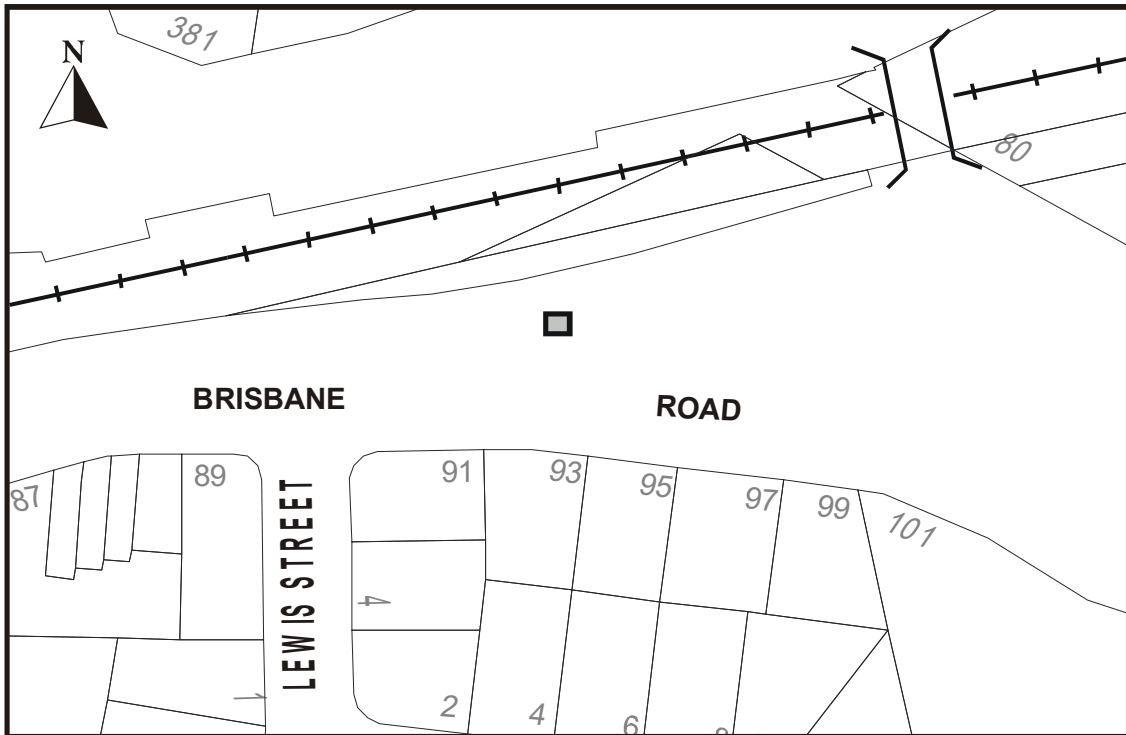

Plan No. 4: 'Stone Kerbing & Gutters'

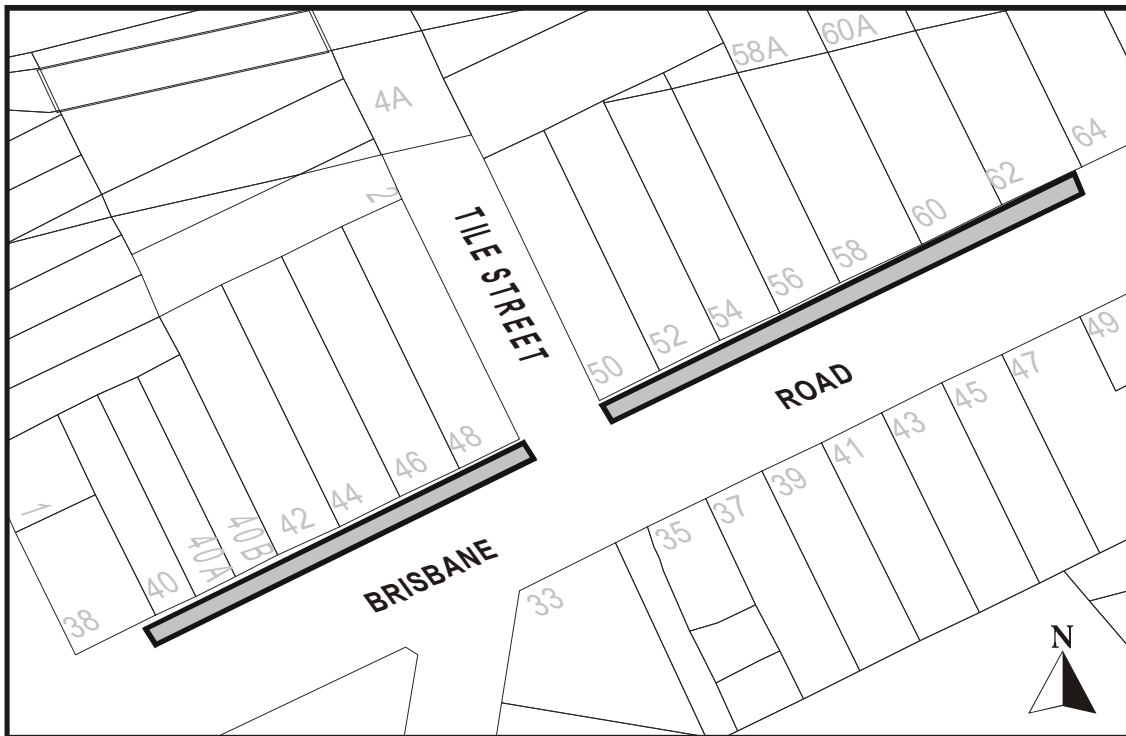

Further details in relation to each site may be obtained from the Ipswich City Council Geographic Information System





Plan No. 5: 'Denmark Hill Fossil Insect Beds'

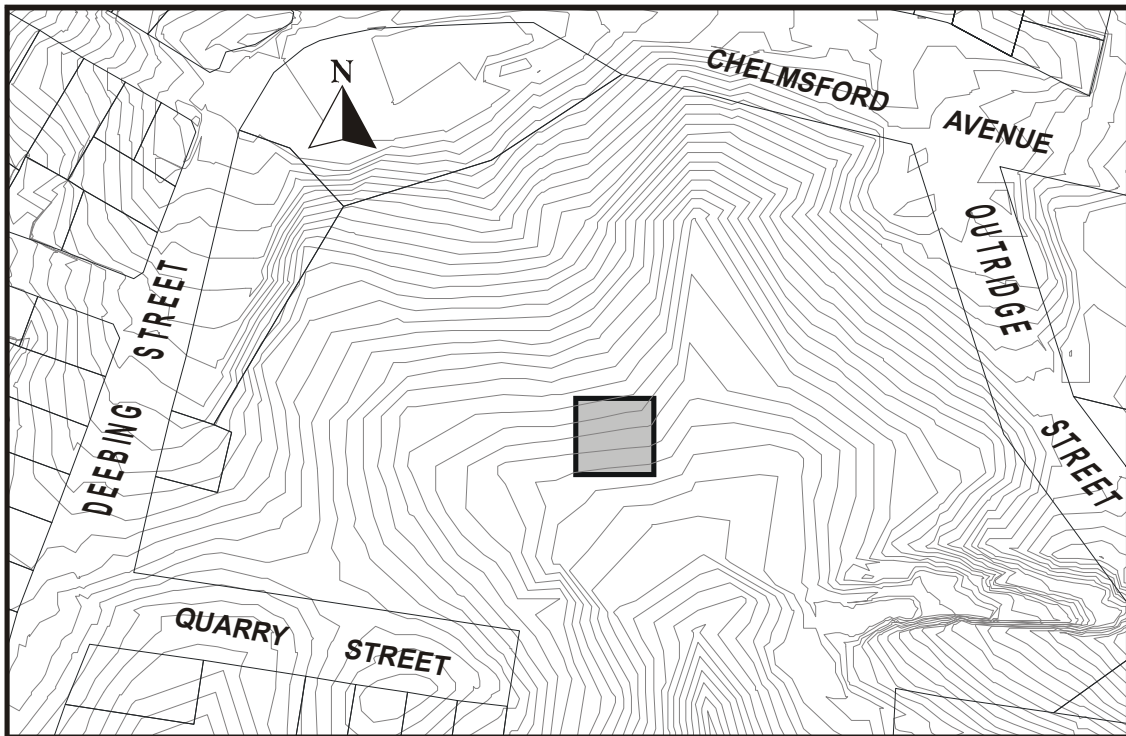

Plan No. 6: 'Denmark Hill Coal Workings'

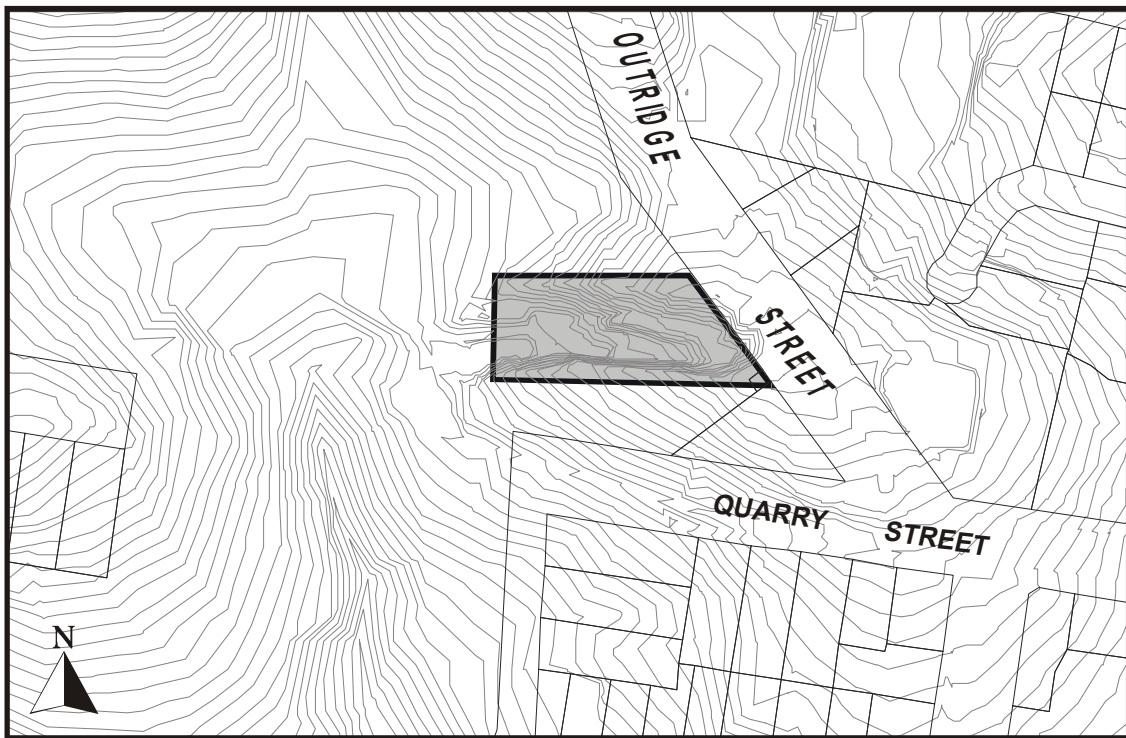

Further details in relation to each site may be obtained from the Ipswich City Council Geographic Information System





Plan No. 7: 'Verrall Family Pioneer Graves'

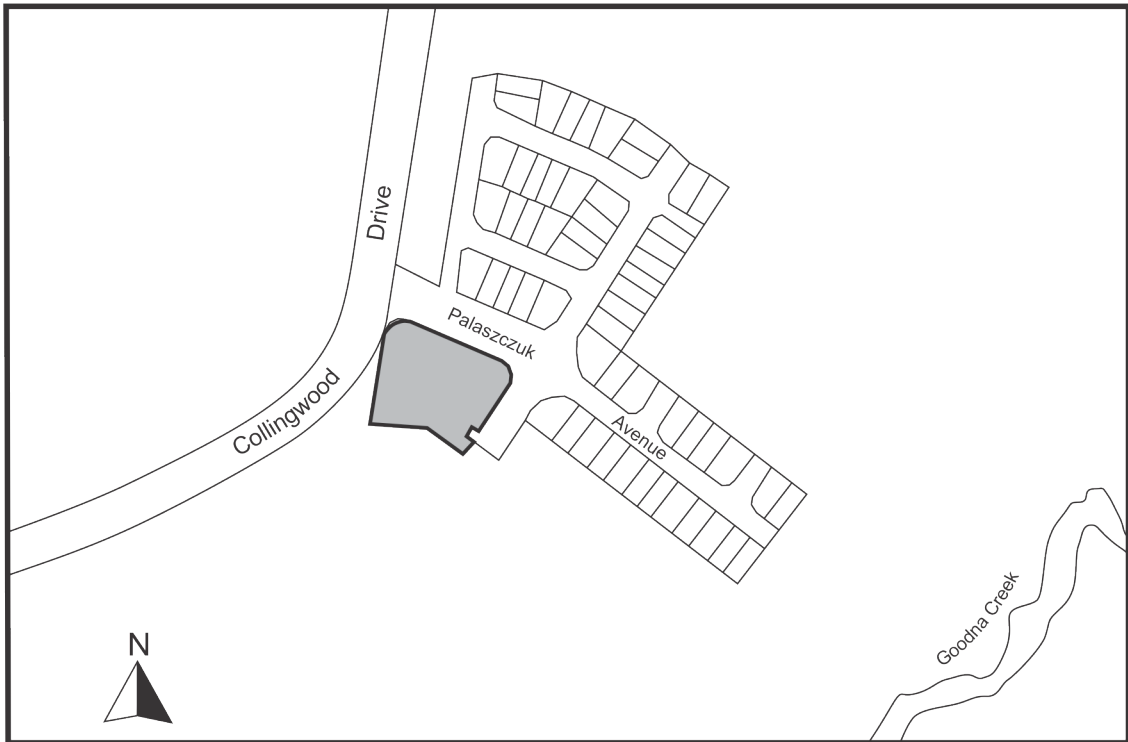

Plan No. 8: 'A.E. Wilcox School of Nursing Building'

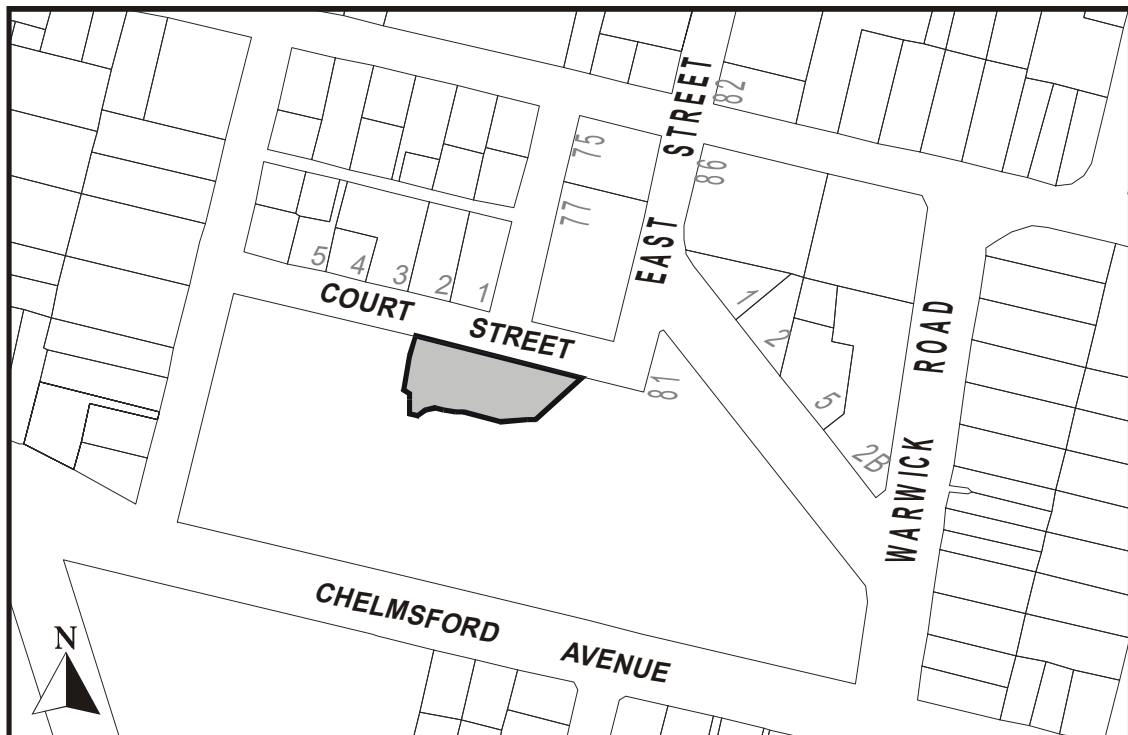

Further details in relation to each site may be obtained from the Ipswich City Council Geographic Information System



Plan No. 9: 'Spring Hill'

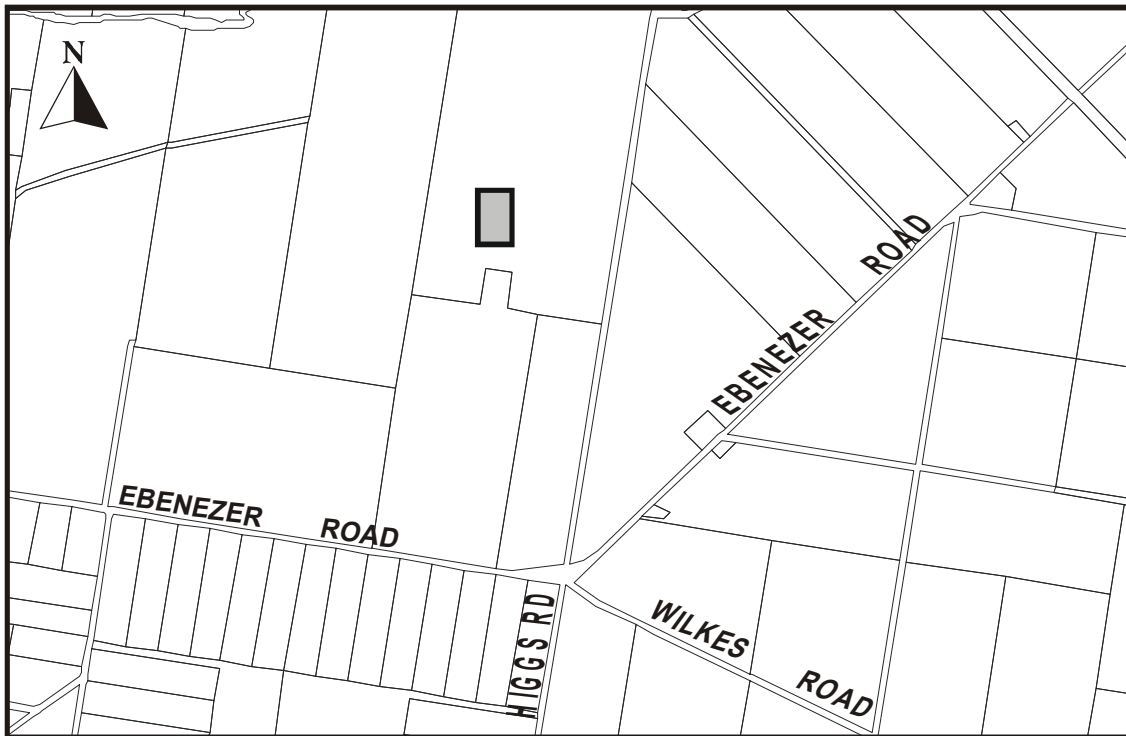

Plan No. 10: 'St Mary's'

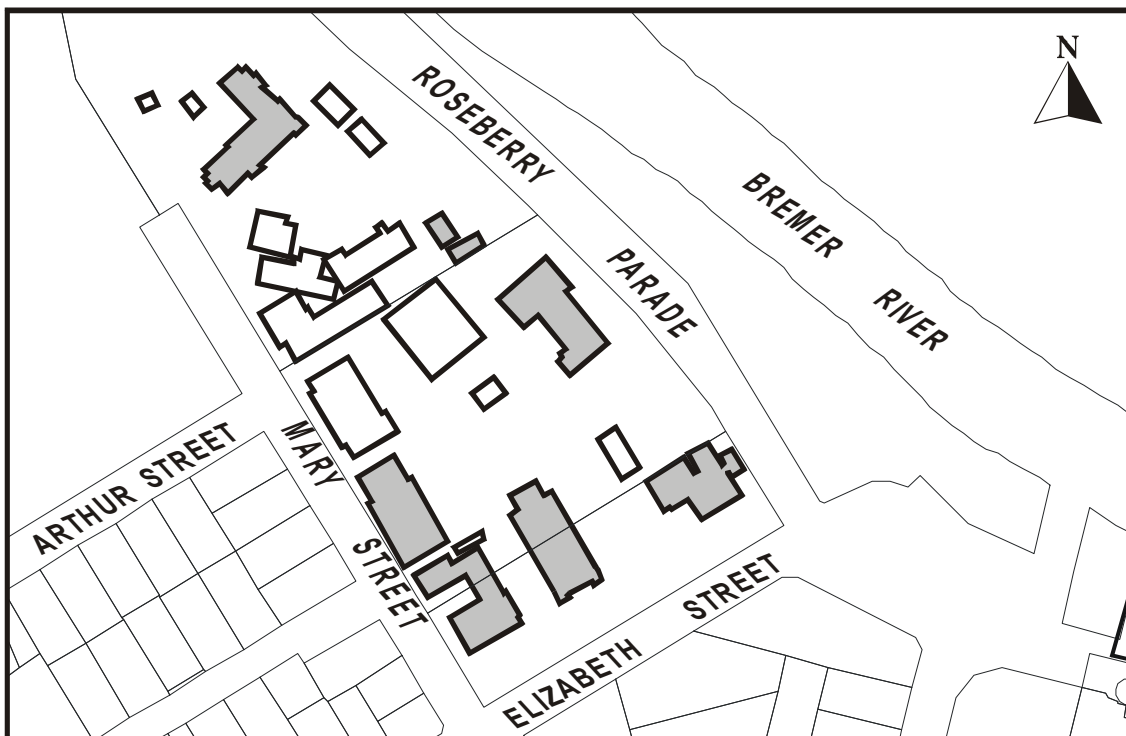

Further details in relation to each site may be obtained from the Ipswich City Council Geographic Information System



Plan No. 11: 'Hitching Rail'

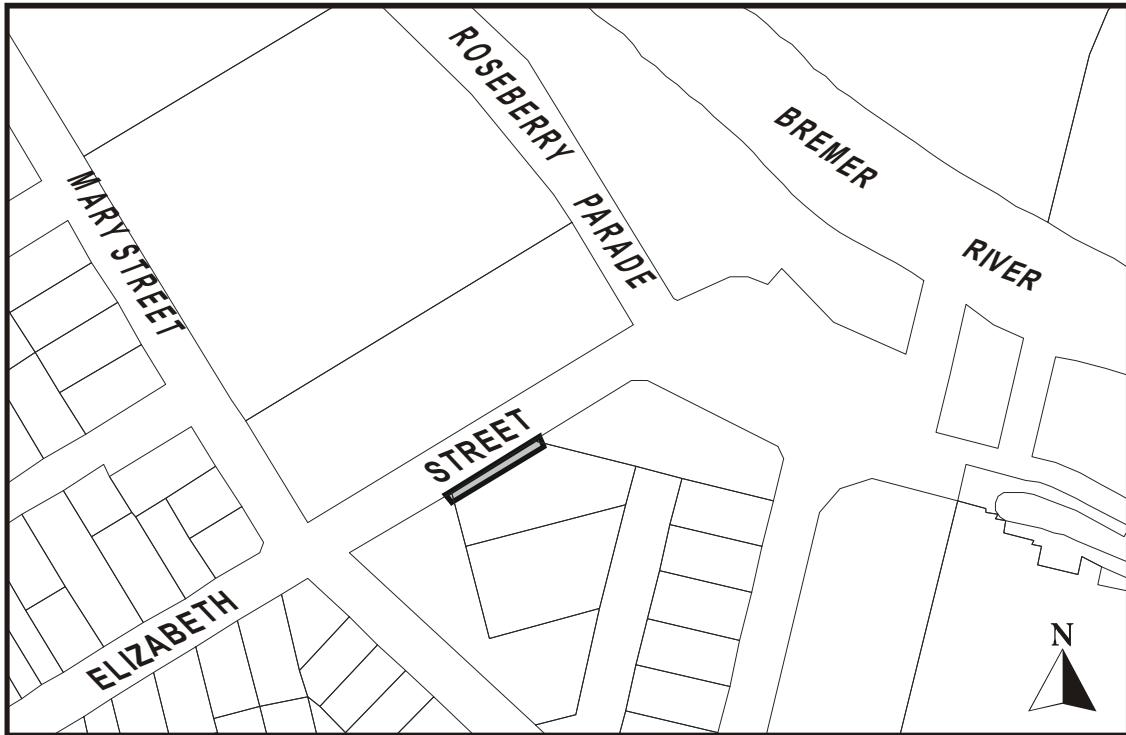

Plan No. 12: 'Rosewood Railway Museum'

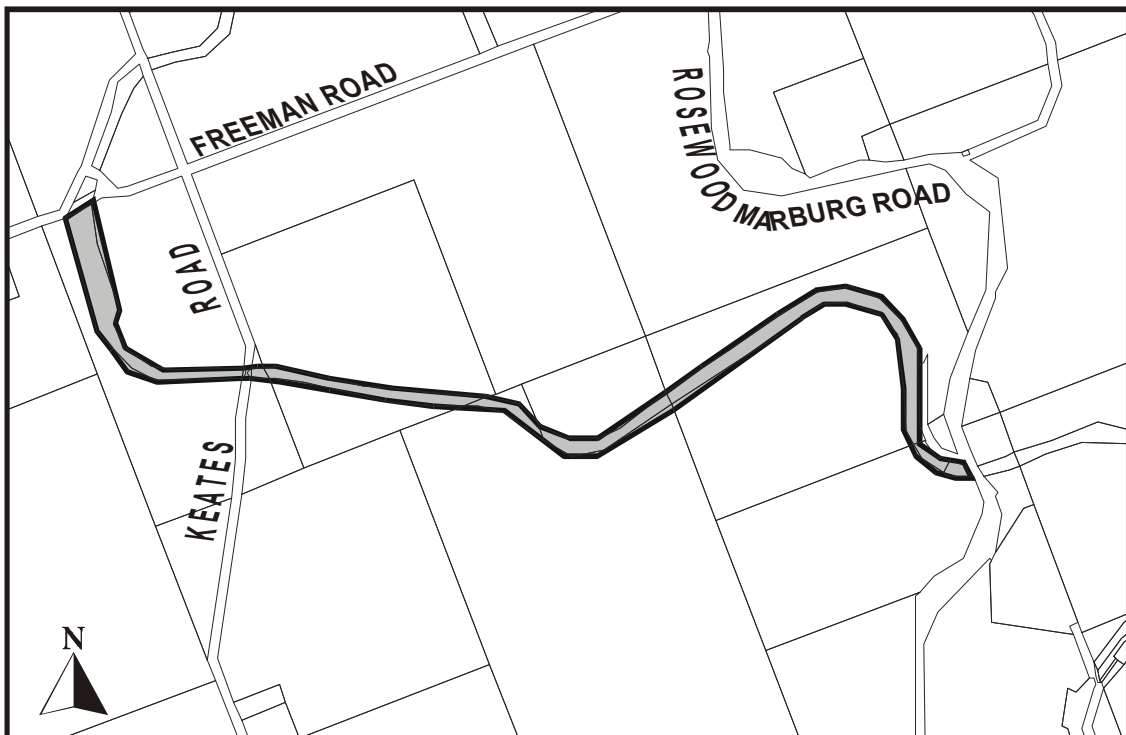

Further details in relation to each site may be obtained from the Ipswich City Council Geographic Information System



Plan No. 13: 'Silkstone State School'



Plan No. 14: 'Franklyn Vale'

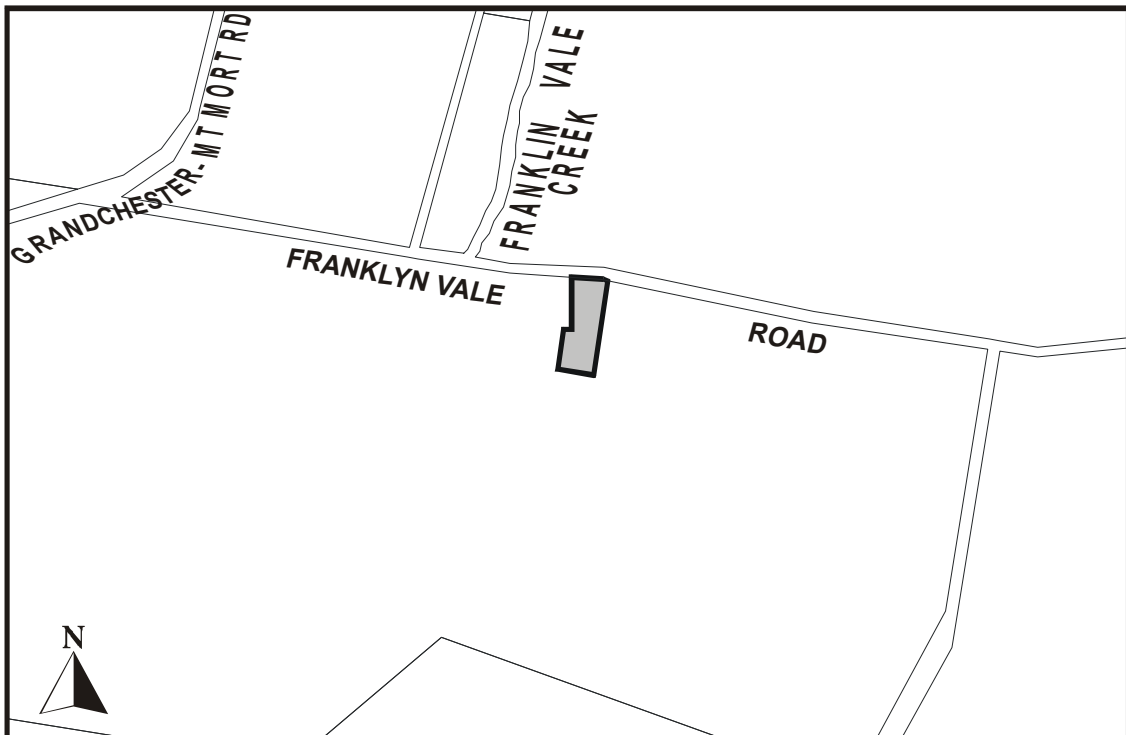

Further details in relation to each site may be obtained from the Ipswich City Council Geographic Information System



Plan No. 15: 'Old Hidden Vale'

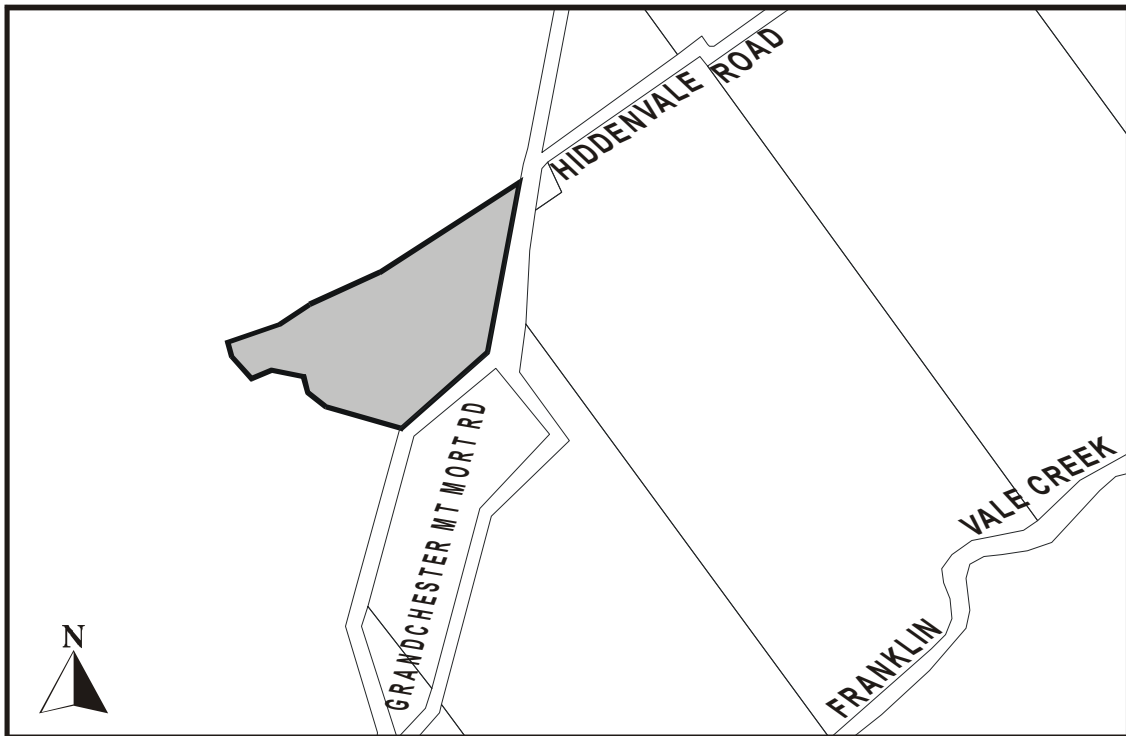

Plan No. 16: 'Cardross'

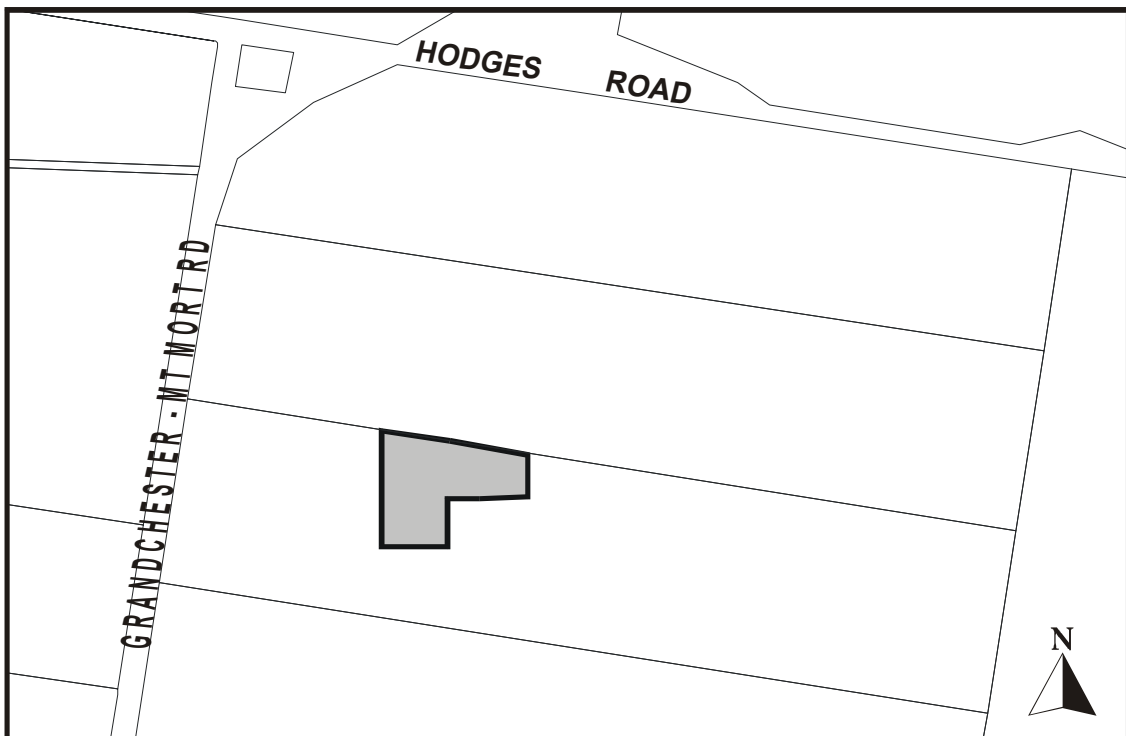

Further details in relation to each site may be obtained from the Ipswich City Council Geographic Information System



Plan No. 17: 'Harrisville State School'



Plan No. 18: 'Klondyke Coke Ovens'

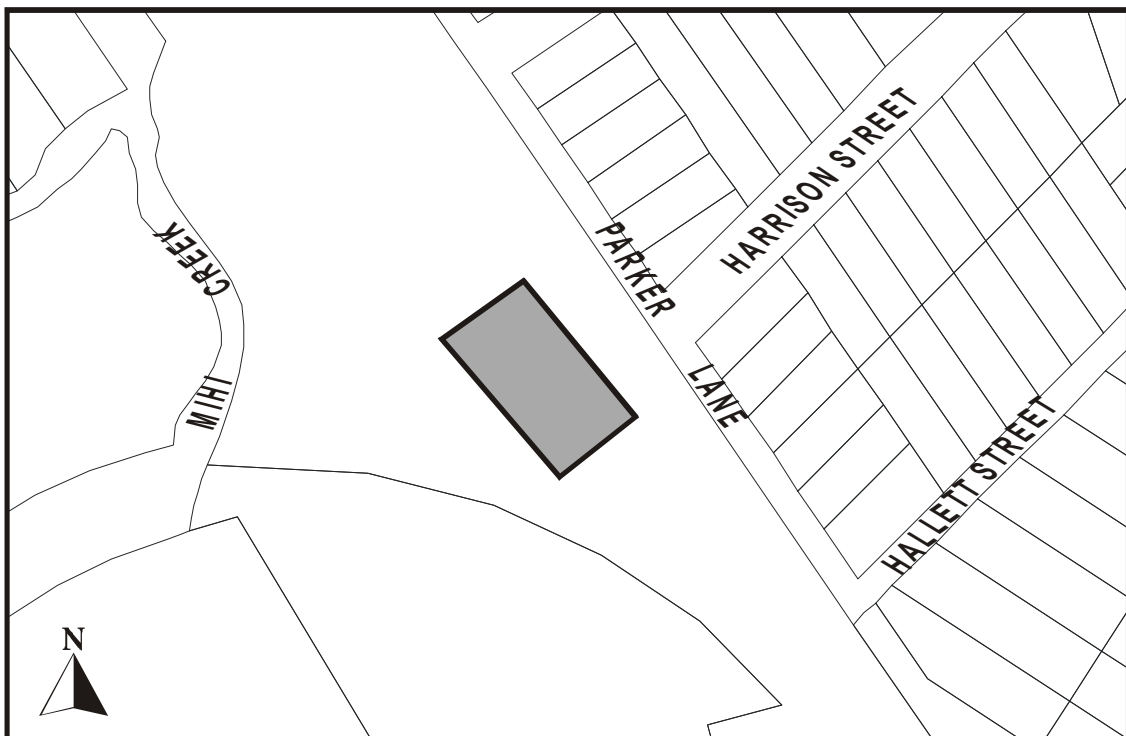

Further details in relation to each site may be obtained from the Ipswich City Council Geographic Information System



Plan No. 19: 'Heiner Road Bridge Approach'

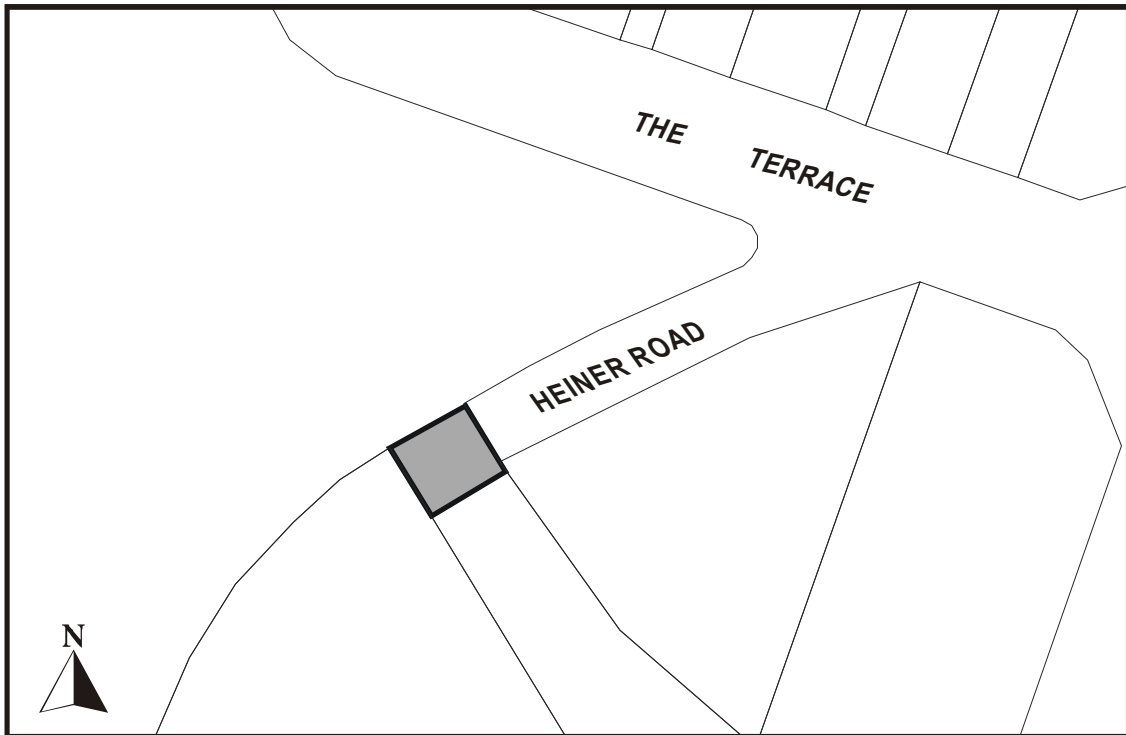

Plan No. 20: 'Haigh Street Quarry'

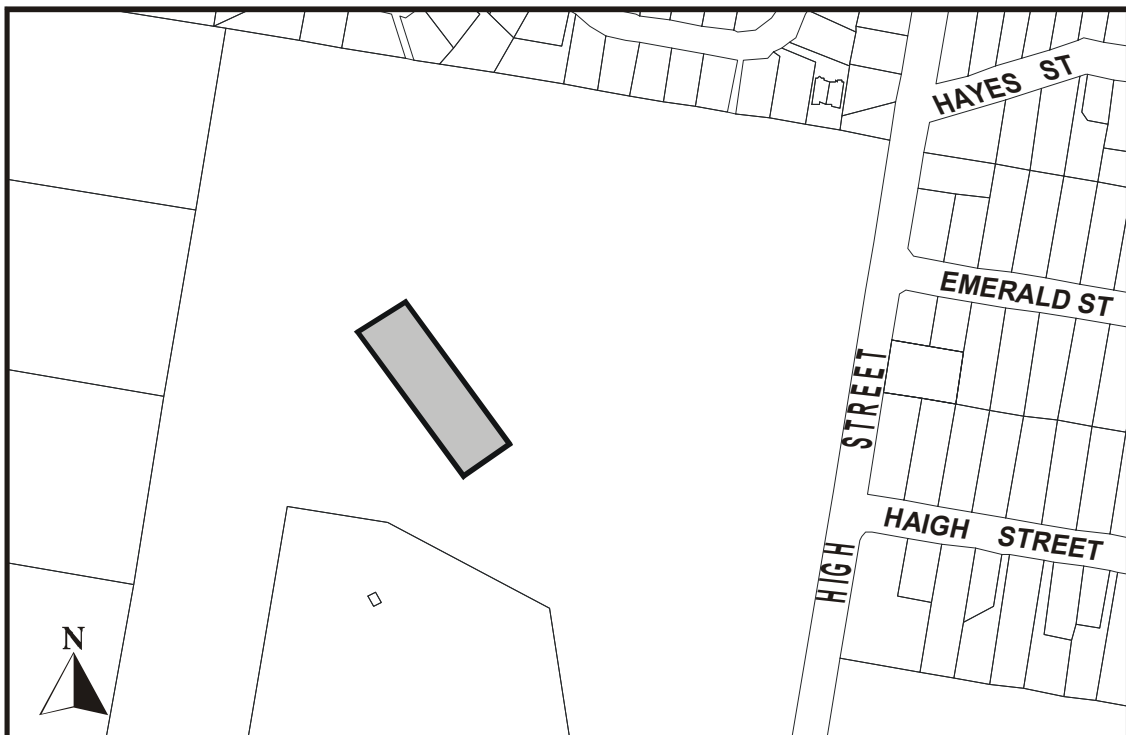

Further details in relation to each site may be obtained from the Ipswich City Council Geographic Information System



Plan No. 21: 'Peak Crossing State School & Residence'

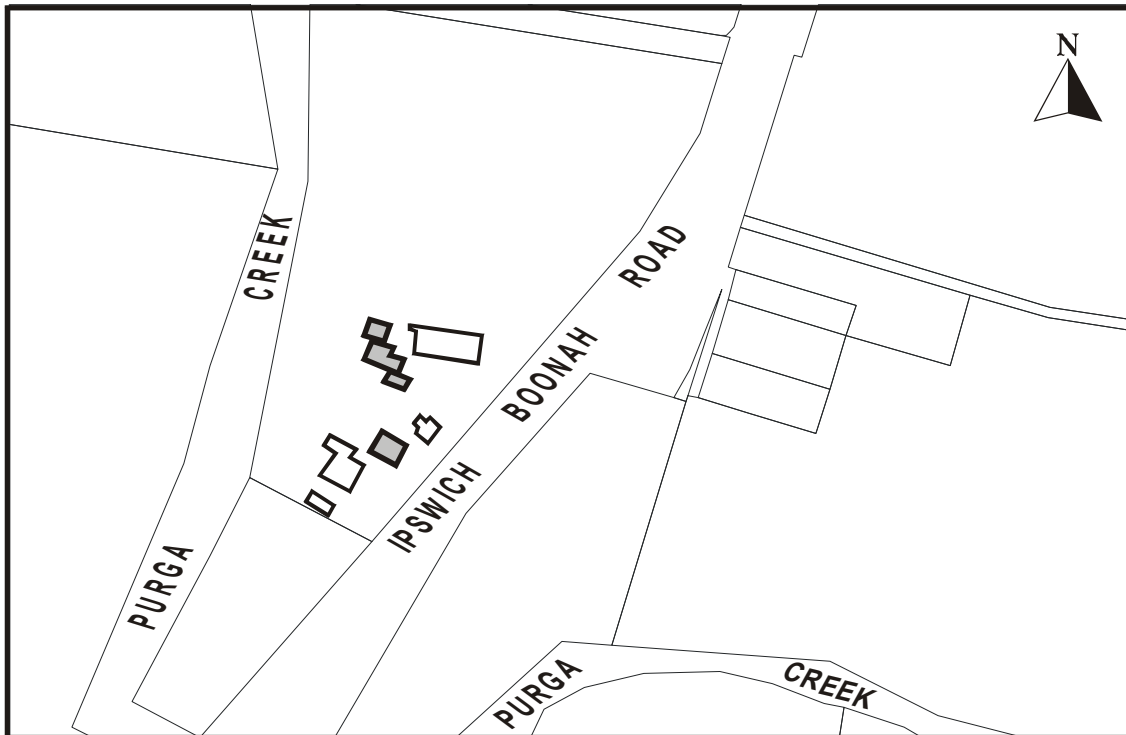

Plan No. 22: 'Ipswich to Walloon Original Railway Line'

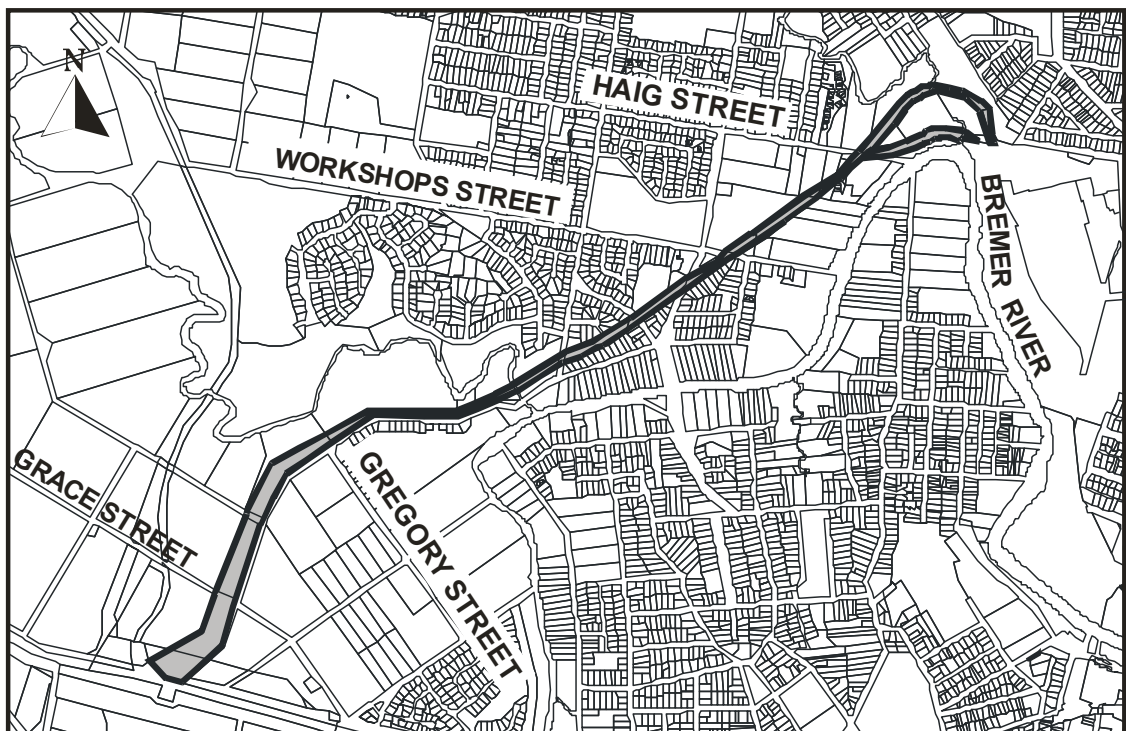

Further details in relation to each site may be obtained from the Ipswich City Council Geographic Information System





Plan No. 23: 'St Edmunds' College

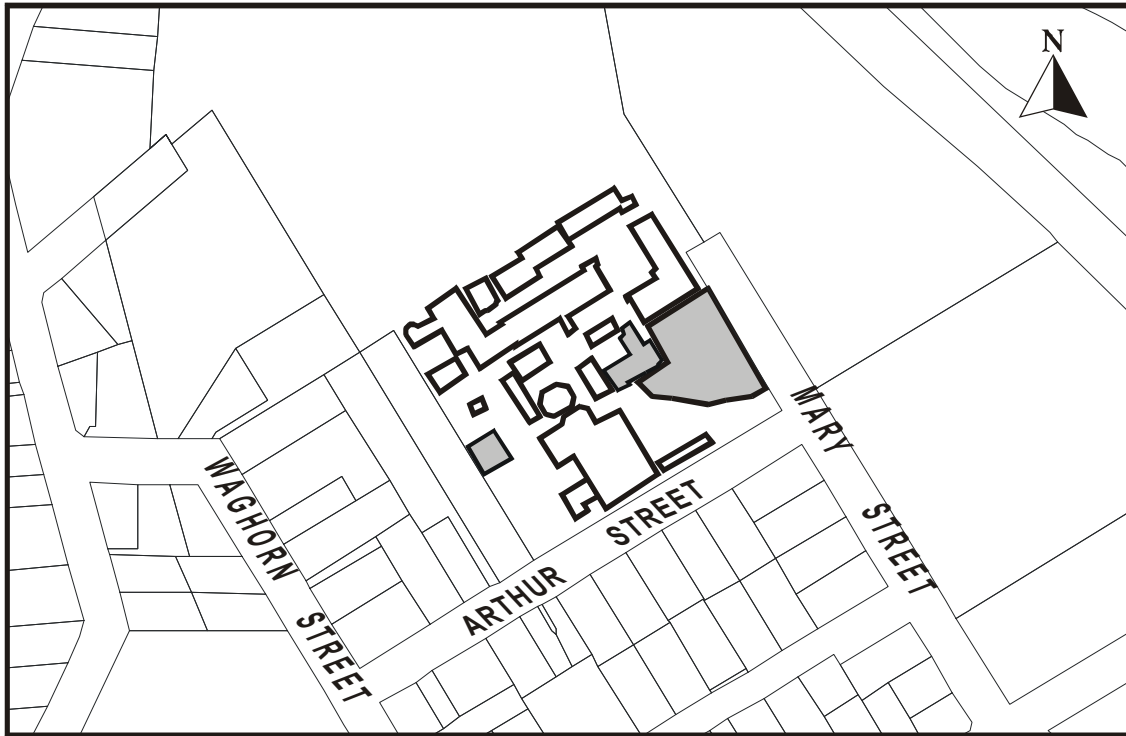

Plan No. 24: 'World War II Pistol Range Wall'

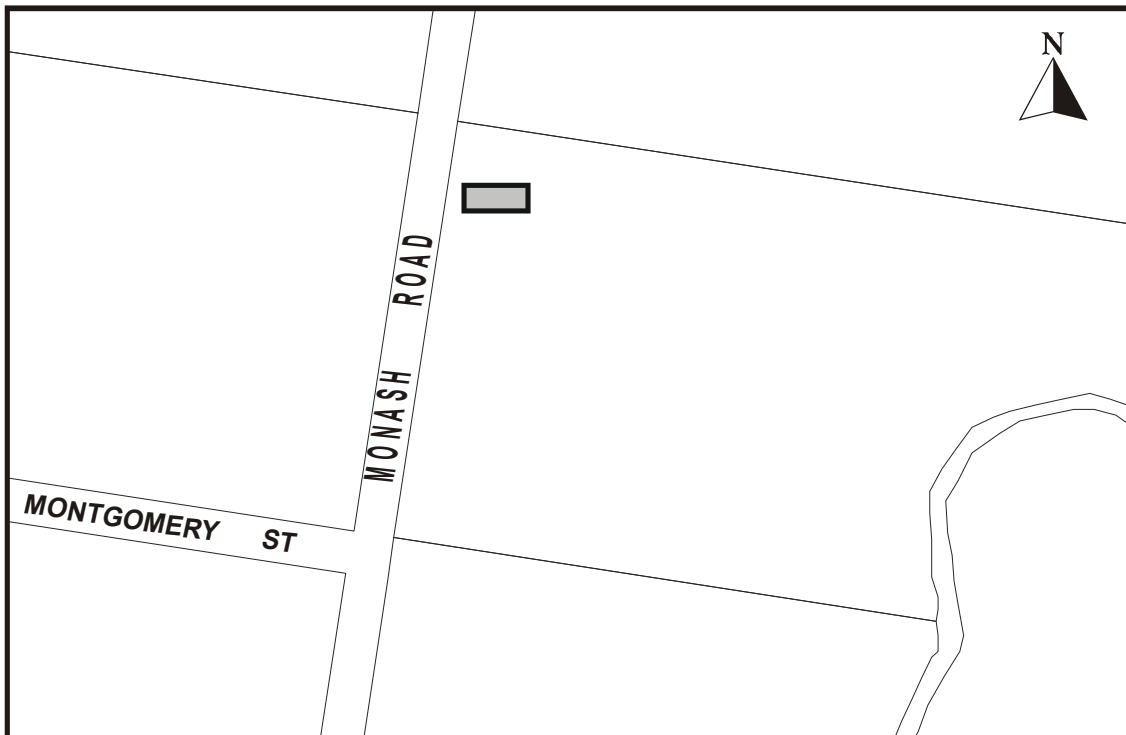

Further details in relation to each site may be obtained from the Ipswich City Council Geographic Information System



Plan No. 25: 'Tivoli Hill Horse Trough'

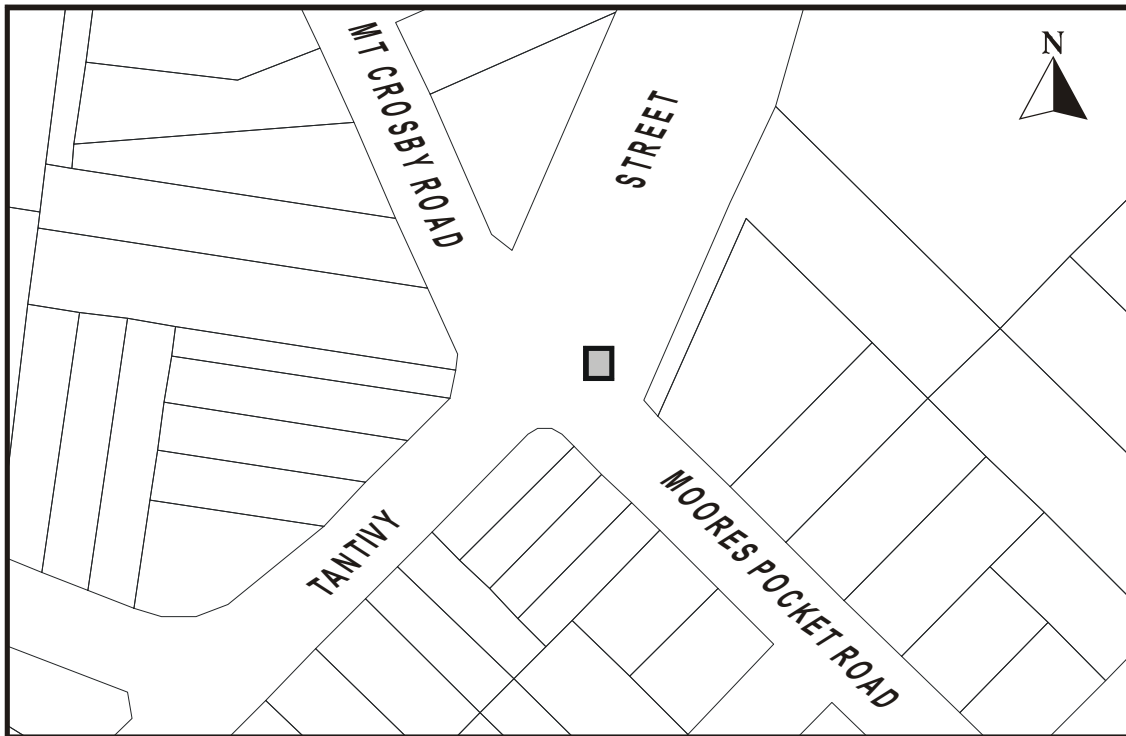

Plan No. 26: 'Ruhland's Farm'

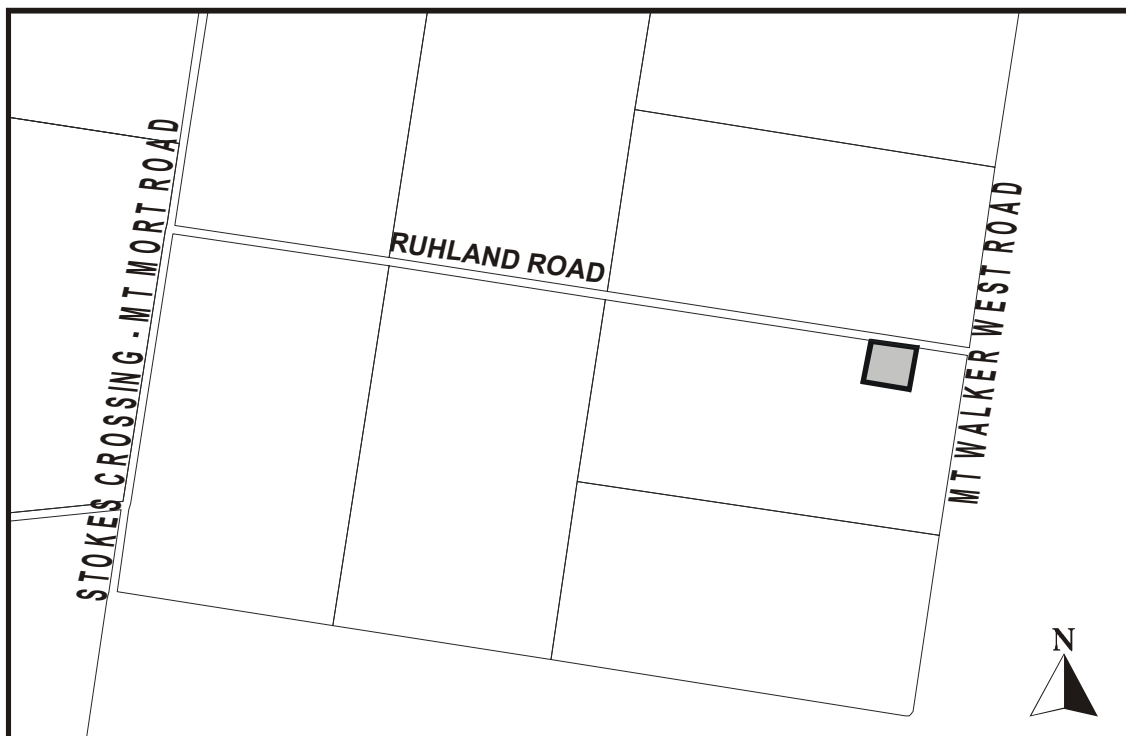

Further details in relation to each site may be obtained from the Ipswich City Council Geographic Information System



Plan No. 27: 'Mihi Line'

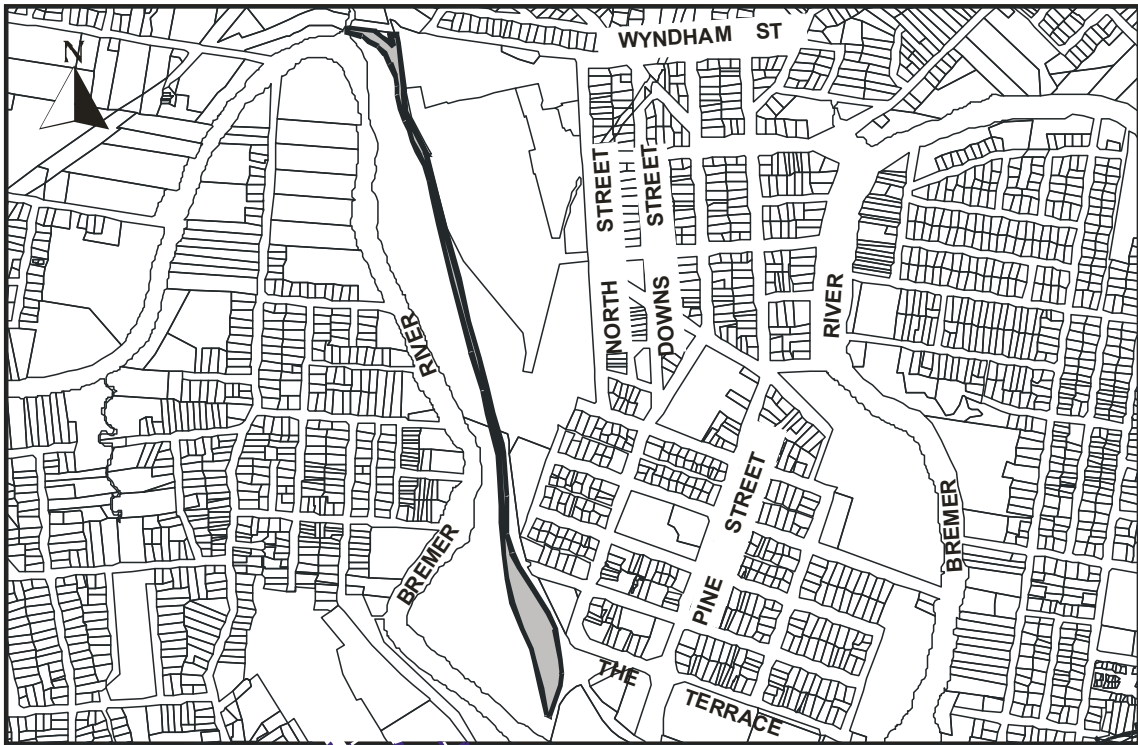

Plan No. 28: 'Ipswich Railway Workshops & Memorial'

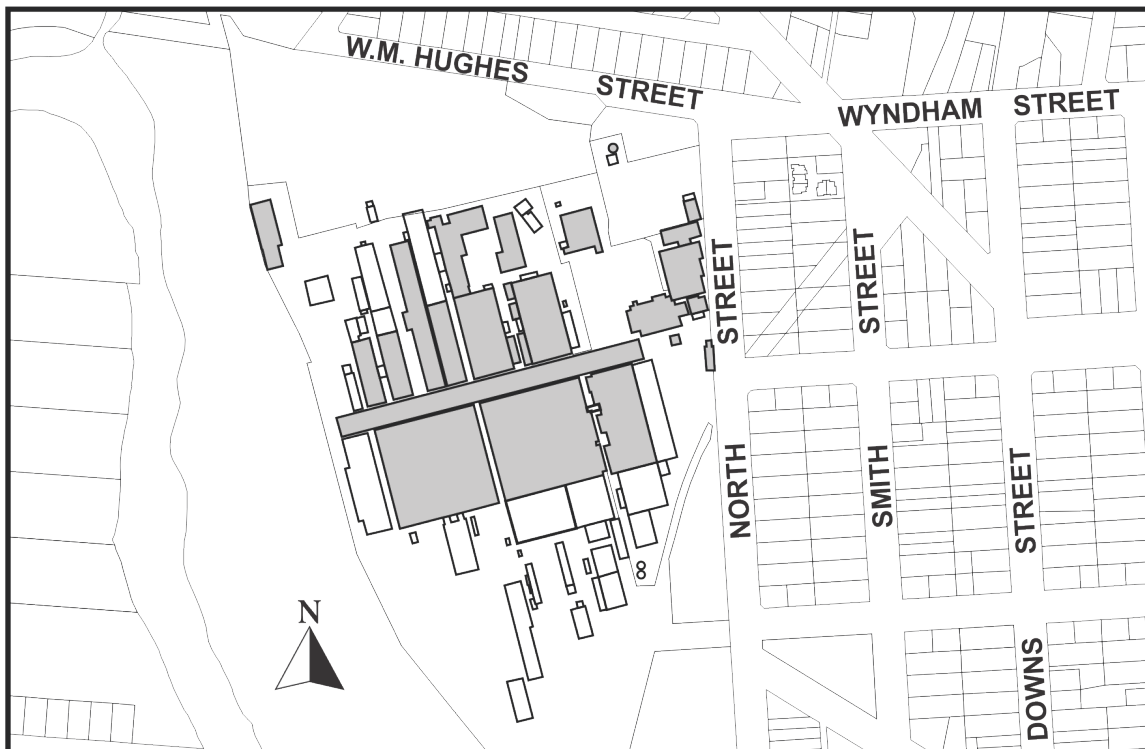

Further details in relation to each site may be obtained from the Ipswich City Council Geographic Information System



Plan No. 29: 'Aberdere Extended No.1 Colliery former General Manager's Office'

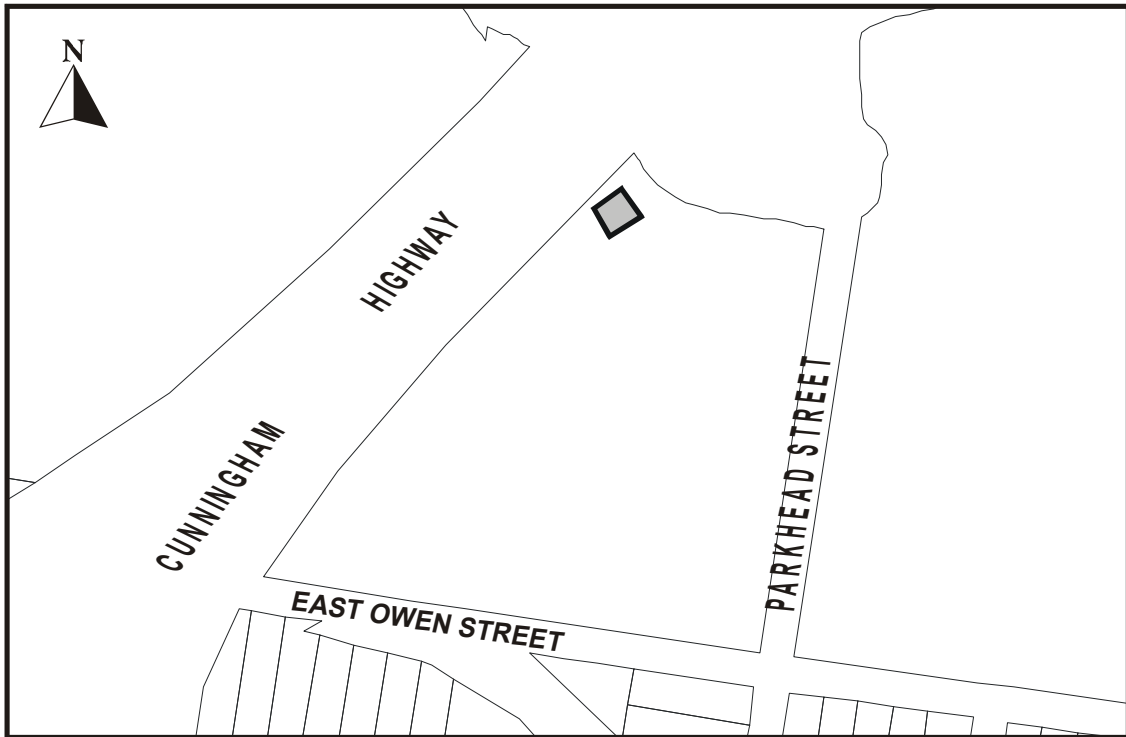

Plan No. 30: 'Ipswich – Gatton Road Distance Marker'

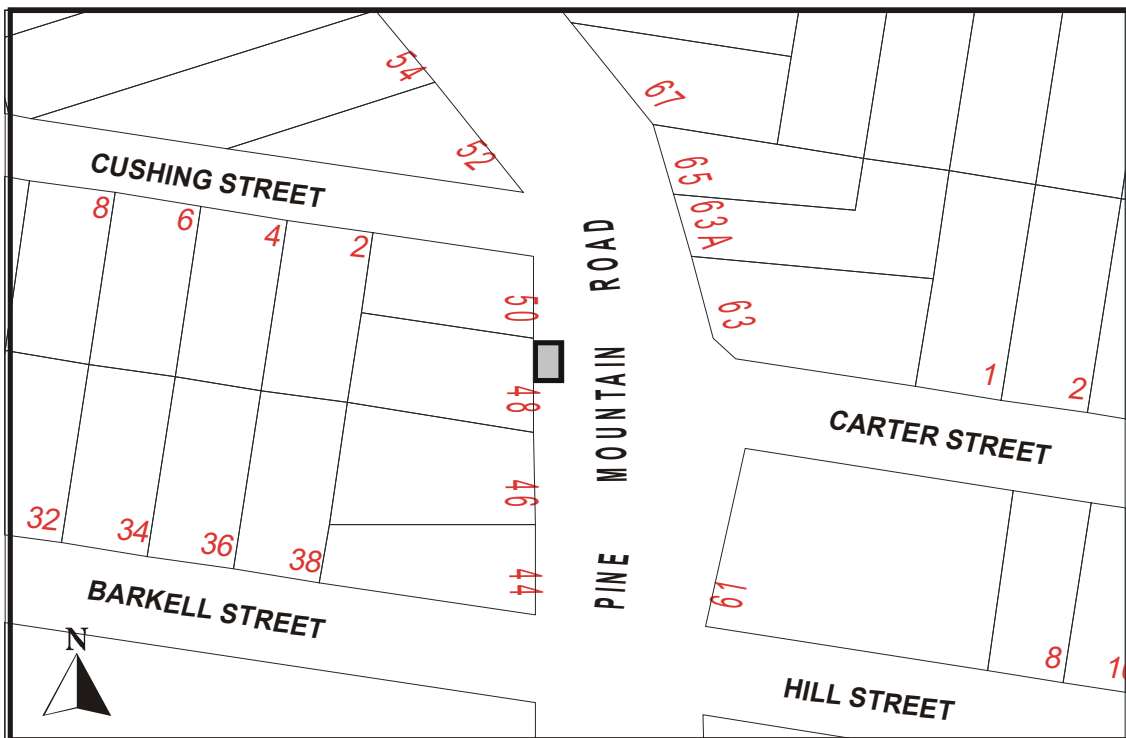

Further details in relation to each site may be obtained from the Ipswich City Council Geographic Information System



Plan No. 31: 'Rosewood Railway Station Complex'



Plan No. 32: 'Reservoir Precinct'

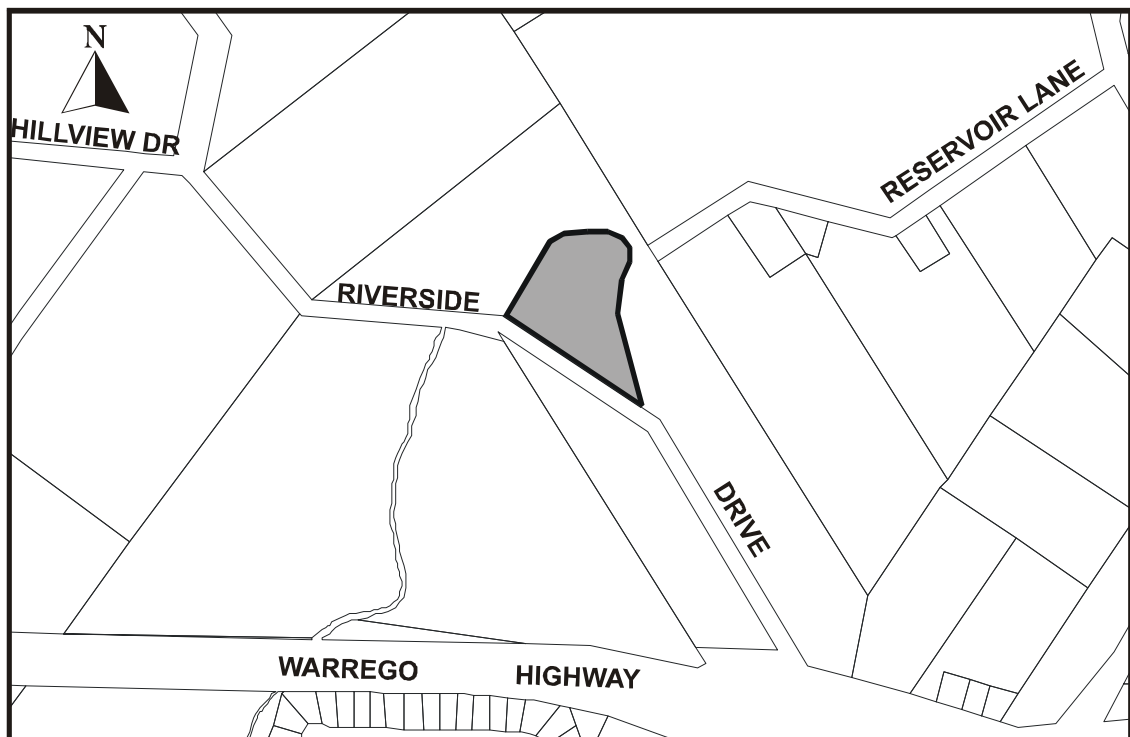

Further details in relation to each site may be obtained from the Ipswich City Council Geographic Information System



Plan No. 33: 'Canaan & Anchorage Farm Manager's Residence'

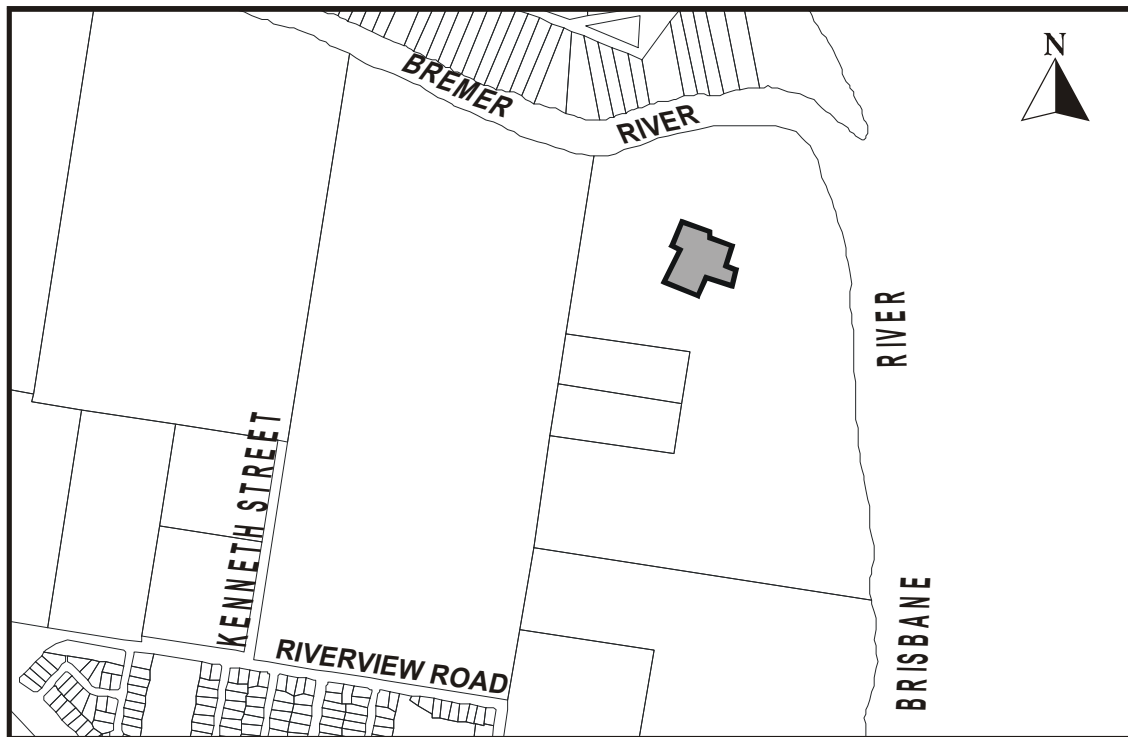

Further details in relation to each site may be obtained from the Ipswich City Council Geographic Information System



Plan No. 34: 'Amberley RAAF Base'

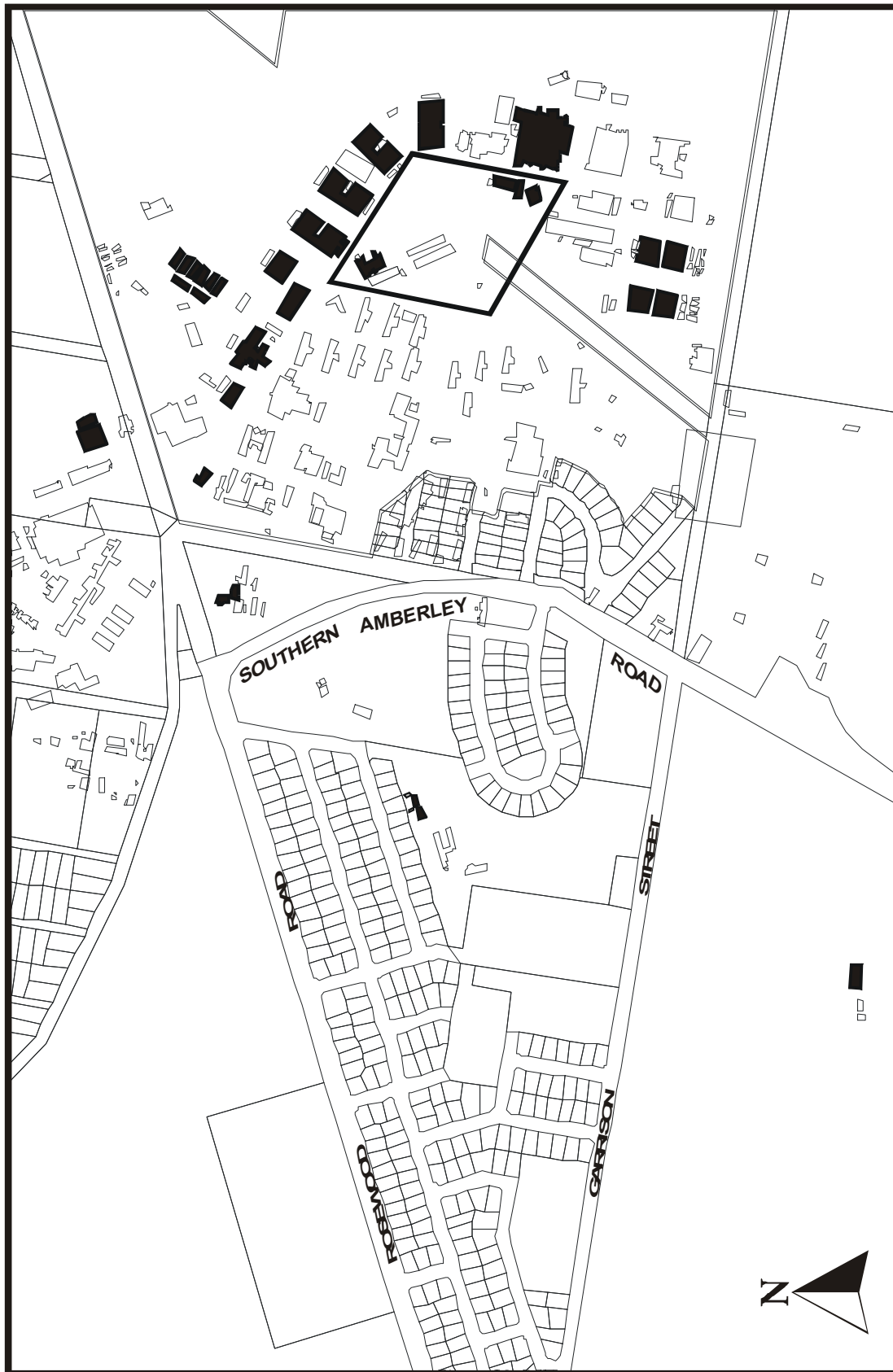

Further details in relation to each site may be obtained from the Ipswich City Council Geographic Information System





Plan No. 35: 'Redbank Plains State School'

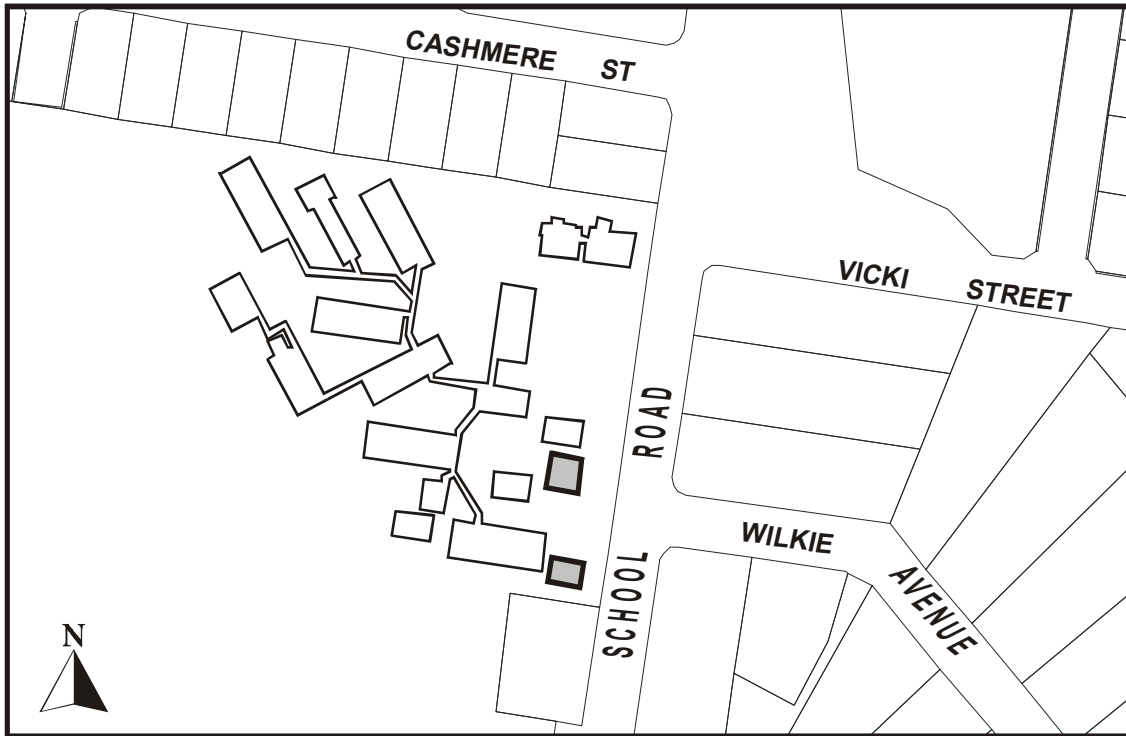

Plan No. 36: 'Wycombe Lodge'

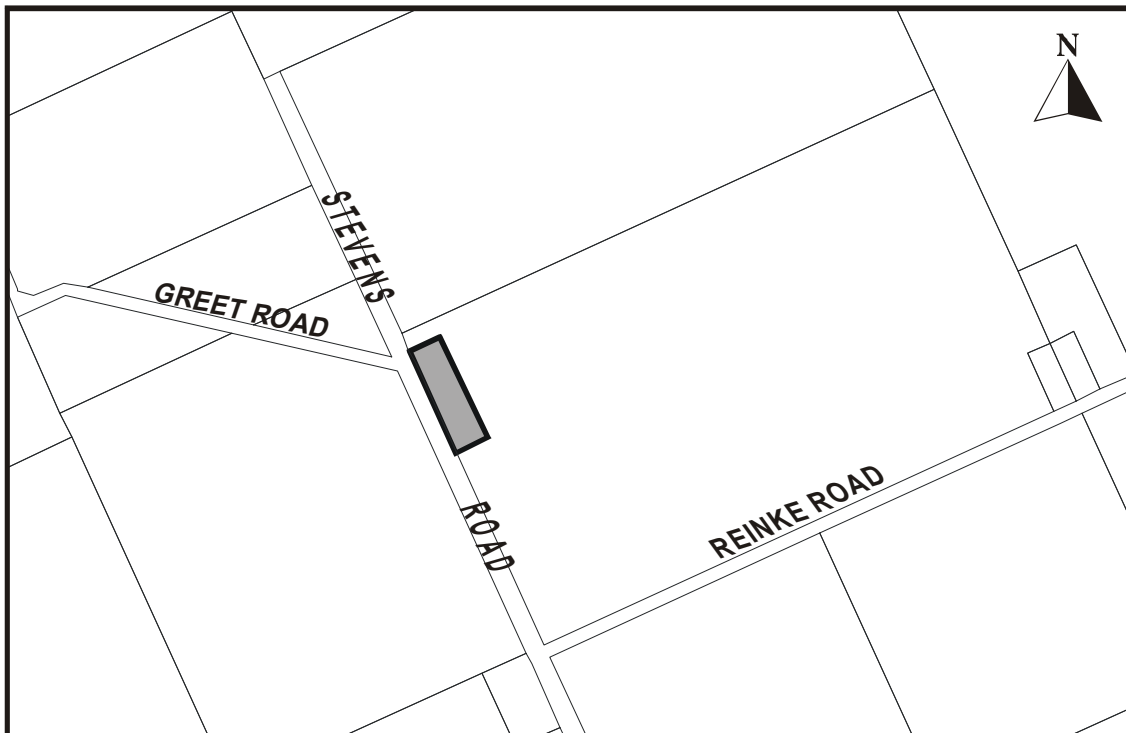

Further details in relation to each site may be obtained from the Ipswich City Council Geographic Information System



Plan No. 37: 'Pioneer Catholic Cemetery'

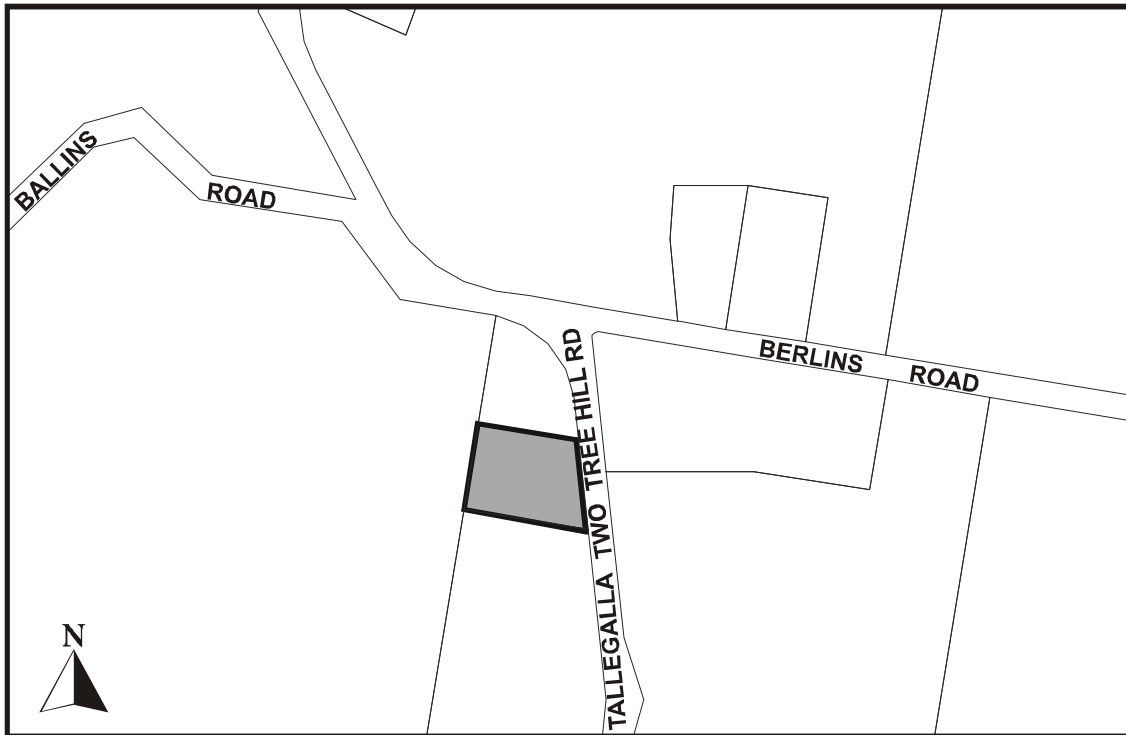

Plan No. 38: 'Haightmoor Coke Ovens'



Further details in relation to each site may be obtained from the Ipswich City Council Geographic Information System



Plan No. 39: 'Peak Crossing Pump'

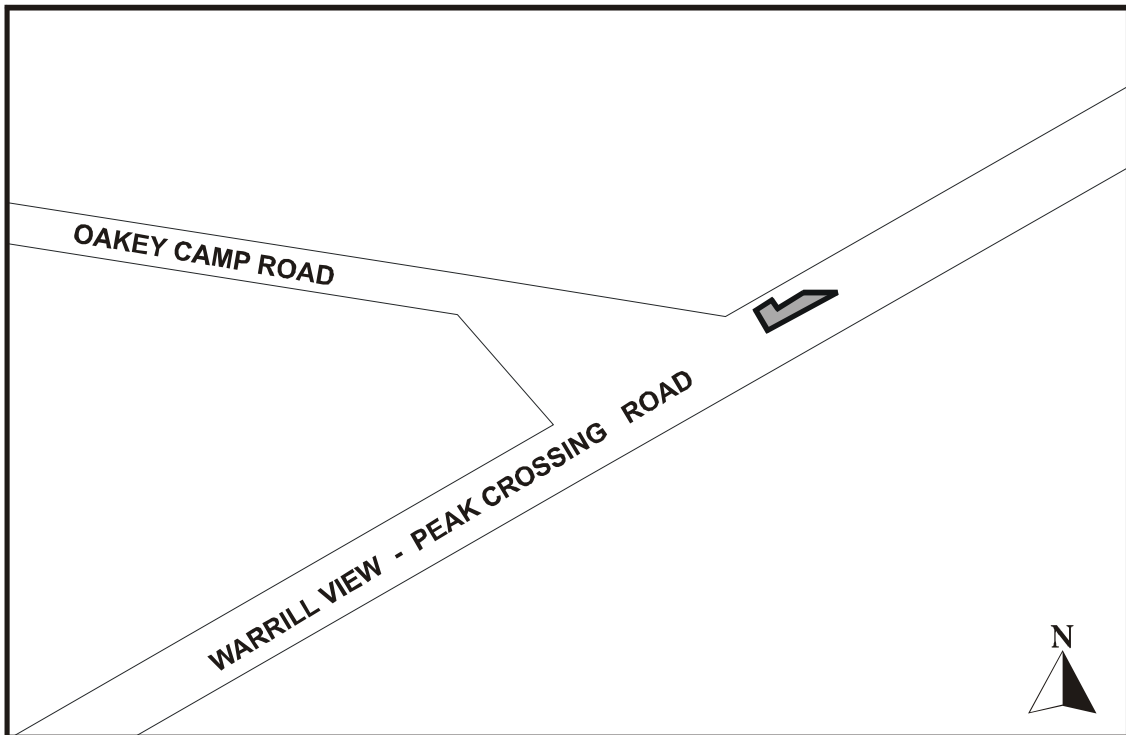

Plan No. 40: 'World War II Remains'

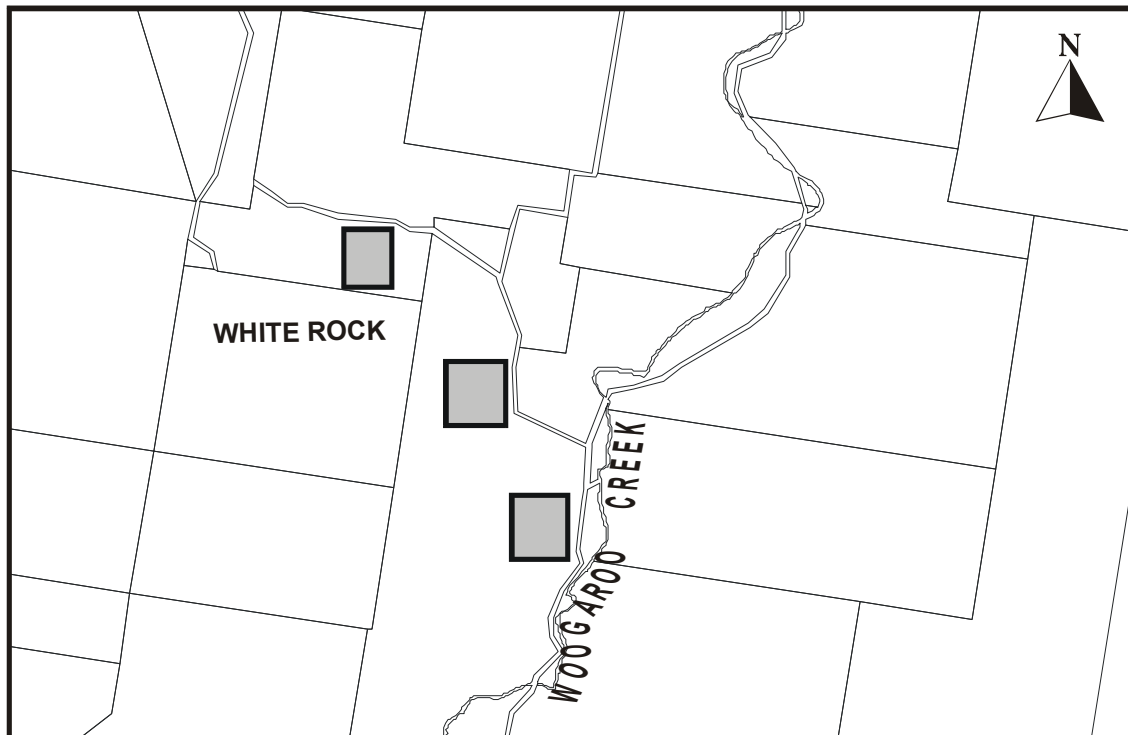

Further details in relation to each site may be obtained from the Ipswich City Council Geographic Information System



Plan No. 41: 'Eden's Homestead Plantings'

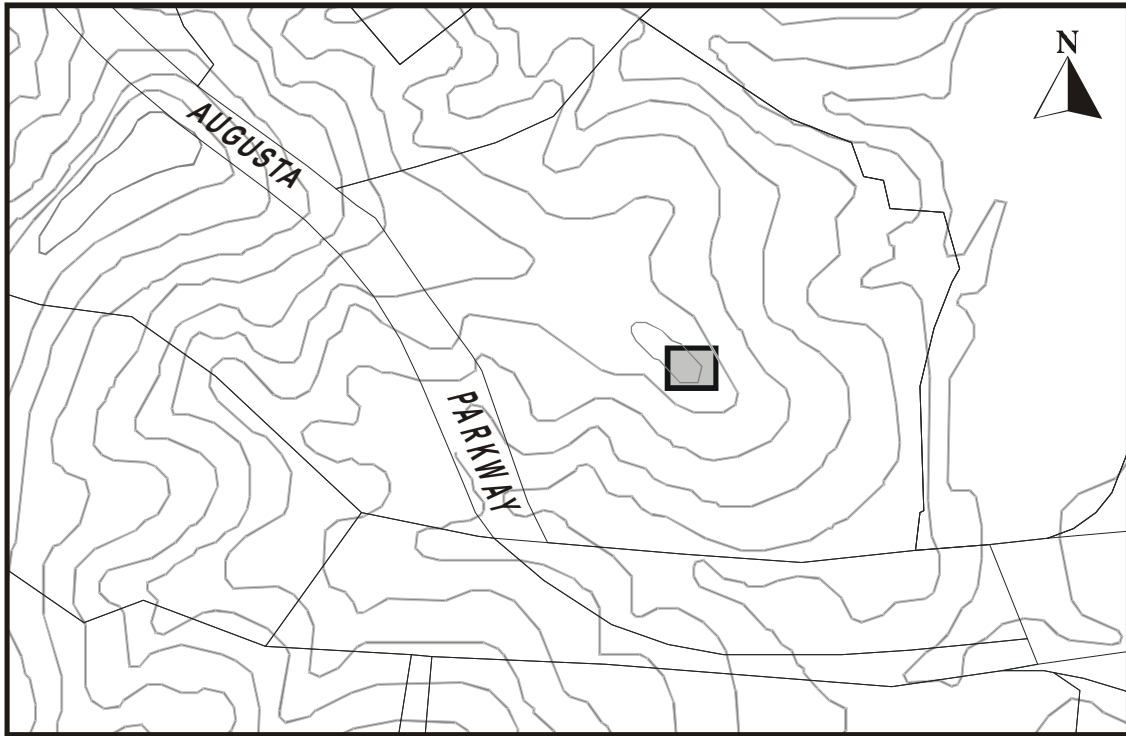

Plan No. 42: 'Depression Work Relief Plantings'

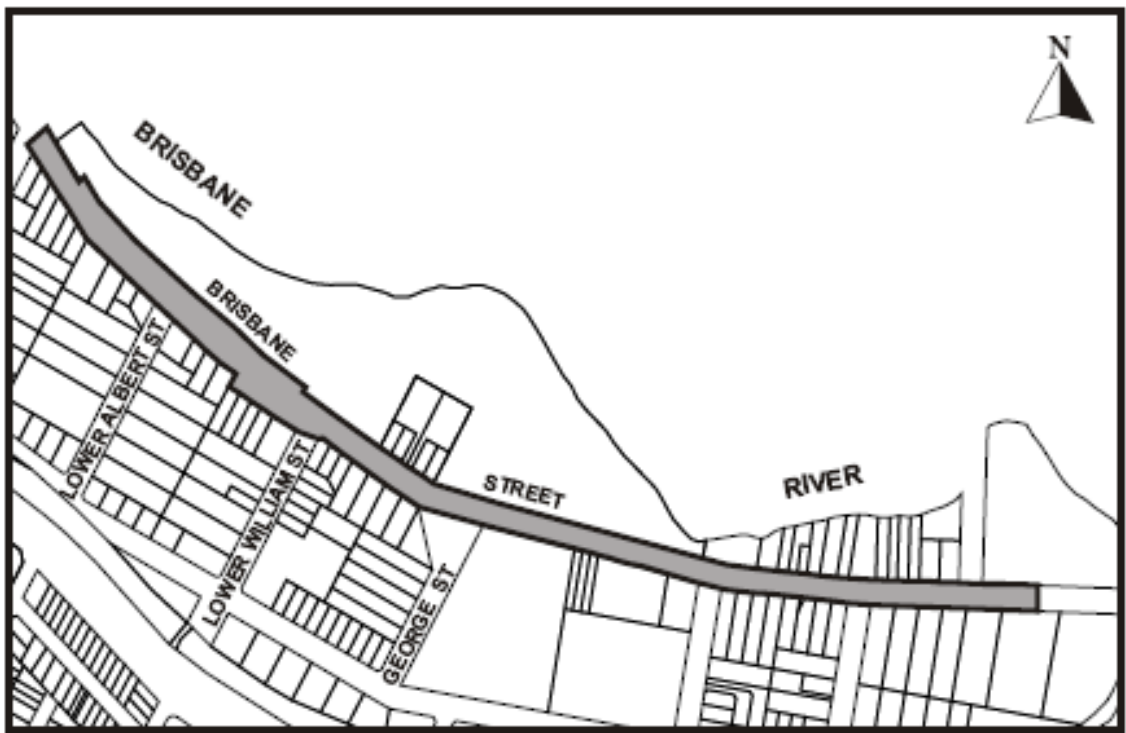

Further details in relation to each site may be obtained from the Ipswich City Council Geographic Information System



Plan No. 43: 'Lone Bunya Pine and Grass Trees – 22 Byrne Street, Bundamba'



Plan No. 44: 'Ipswich Girls Grammar School Plantings'

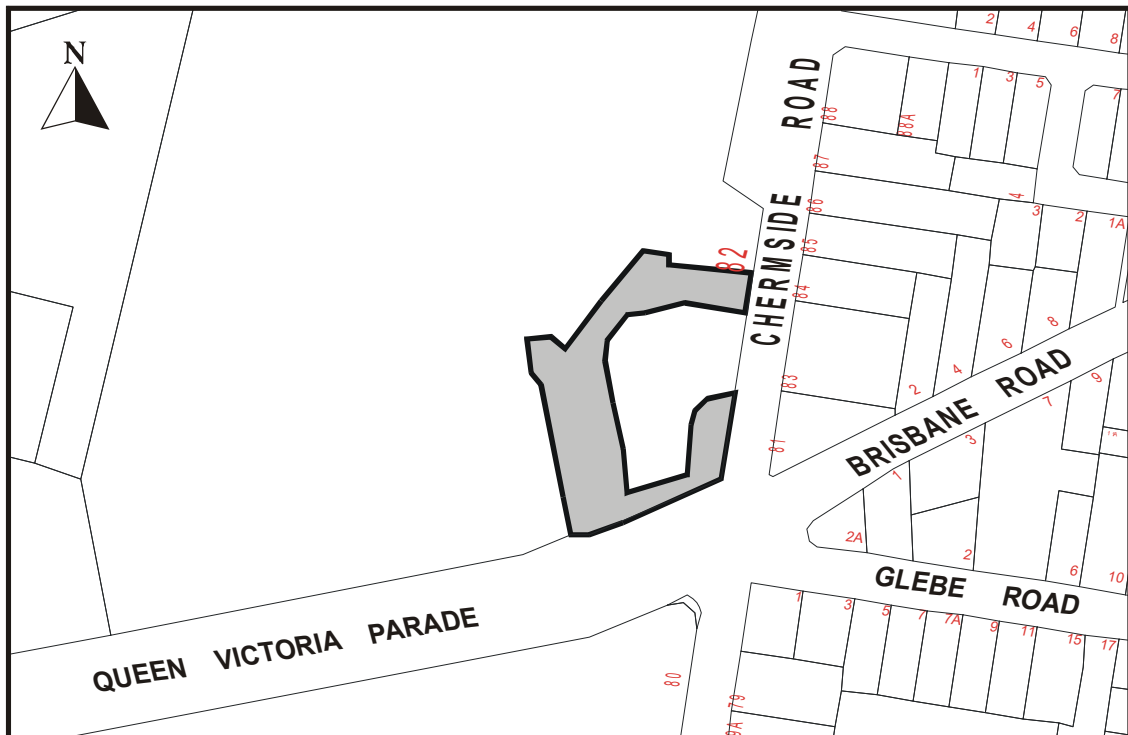

Further details in relation to each site may be obtained from the Ipswich City Council Geographic Information System



Plan No. 45: This Plan is intentionally left blank

Plan No. 46: 'Ipswich Railway Workshop Plantings'



Further details in relation to each site may be obtained from the Ipswich City Council Geographic Information System



Plan No. 47: 'Moreton Bay Fig Tree'

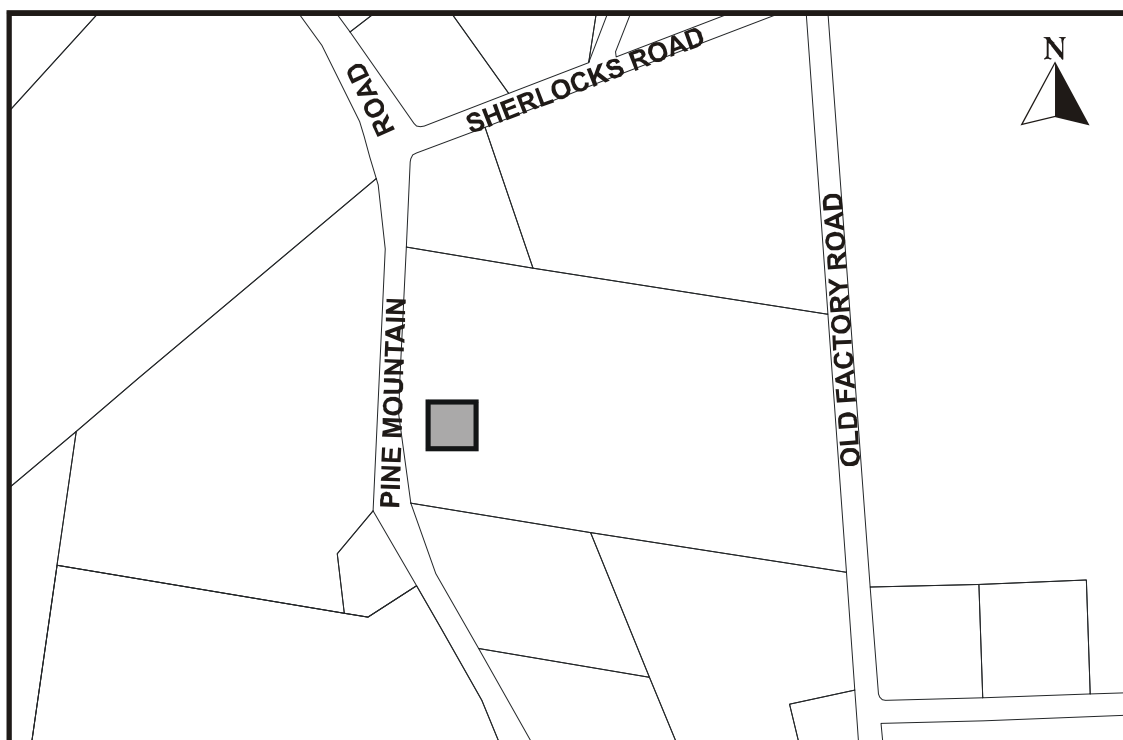

Further details in relation to each site may be obtained from the Ipswich City Council Geographic Information System

Plan No. 48: This Plan is intentionally left blank





Plan No. 49: 'University of Queensland Ipswich Campus Plantings'

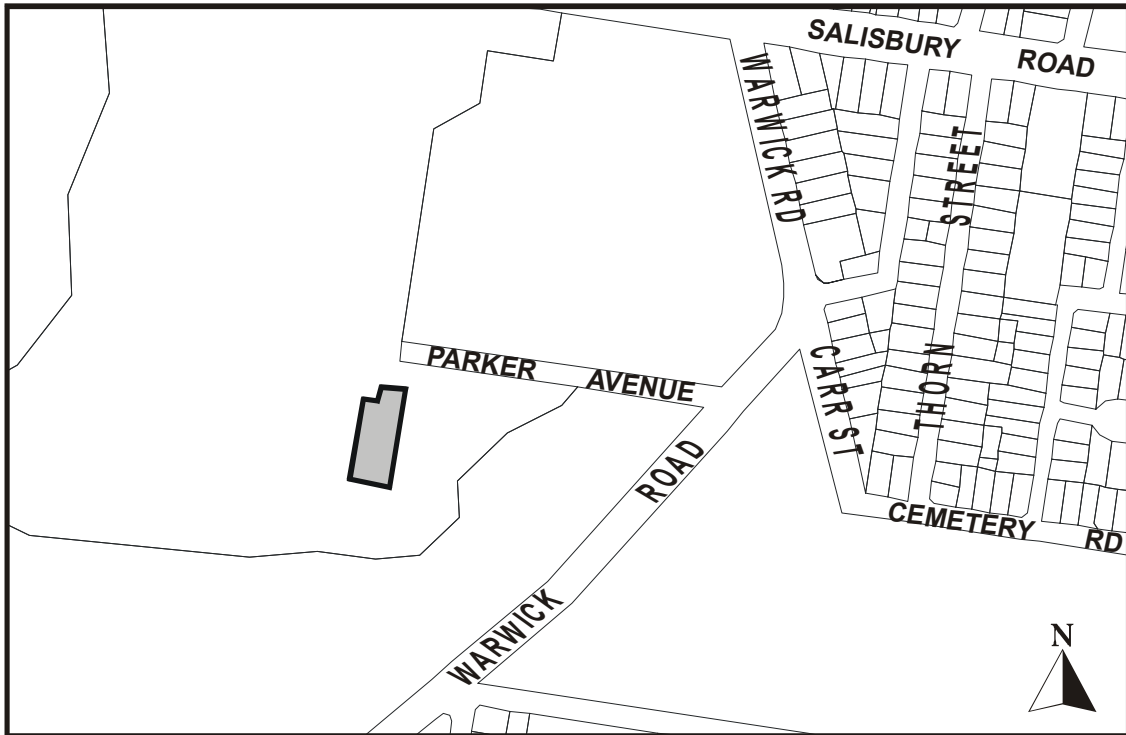

Plan No. 50: 'Marburg State Primary School Environmental Park & perimeter Driveway Plantings'

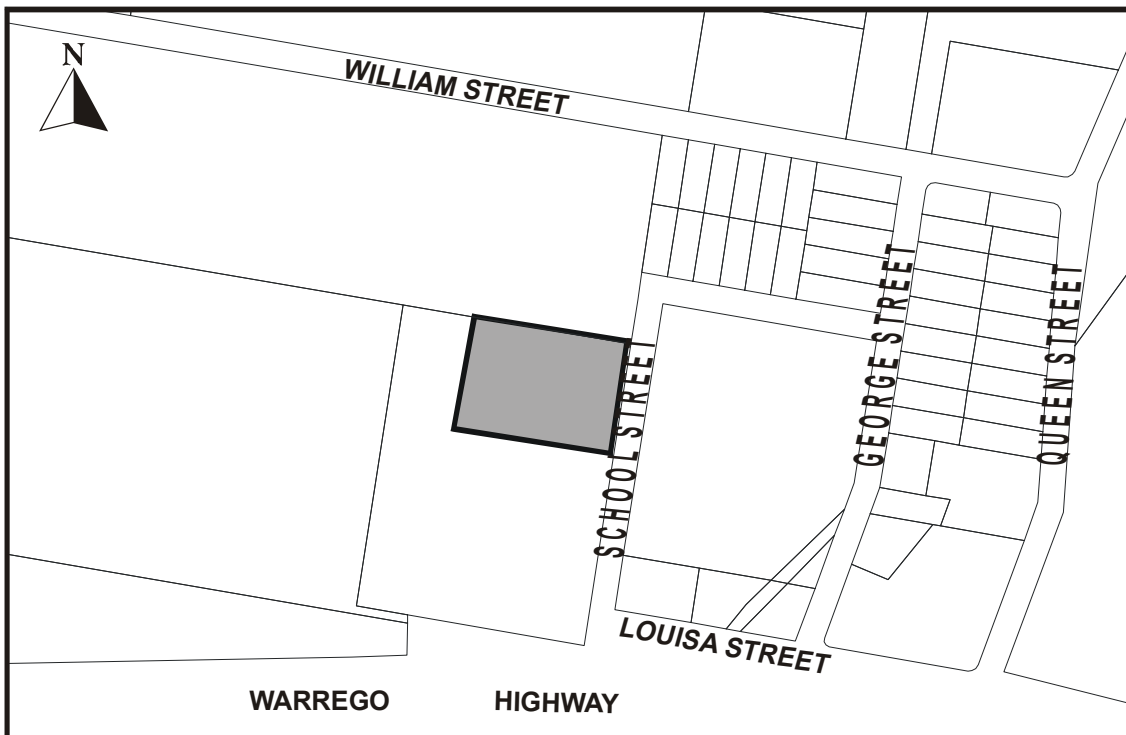

Further details in relation to each site may be obtained from the Ipswich City Council Geographic Information System



Plan No. 51: 'The Christmas Lights Tree'

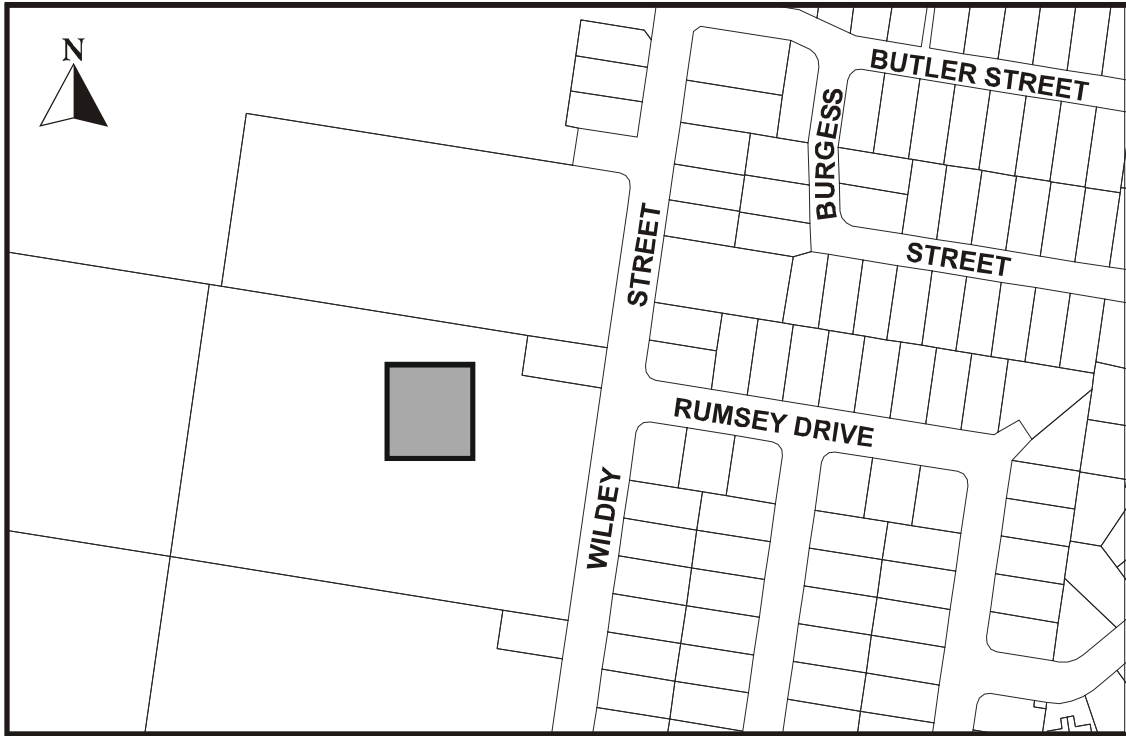

Plan No. 52: 'Indigenous Cultural Heritage Site'

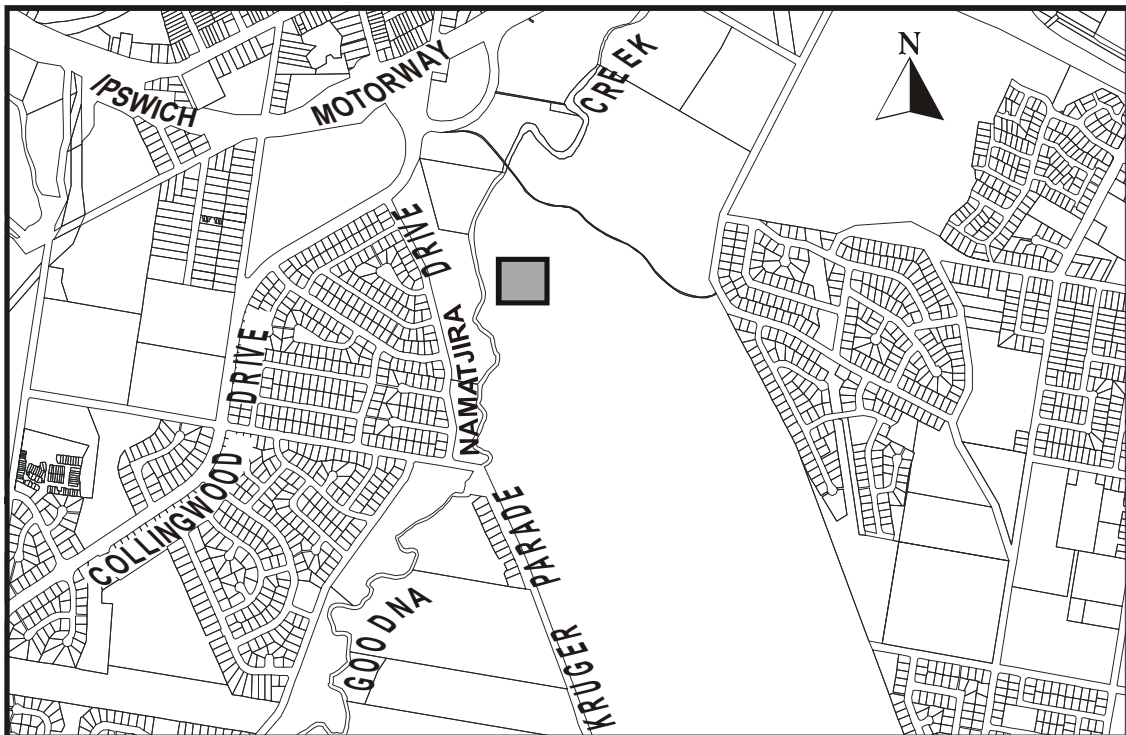

Further details in relation to each site may be obtained from the Ipswich City Council Geographic Information System



Plan No. 53: 'Indigenous Cultural Heritage Site'

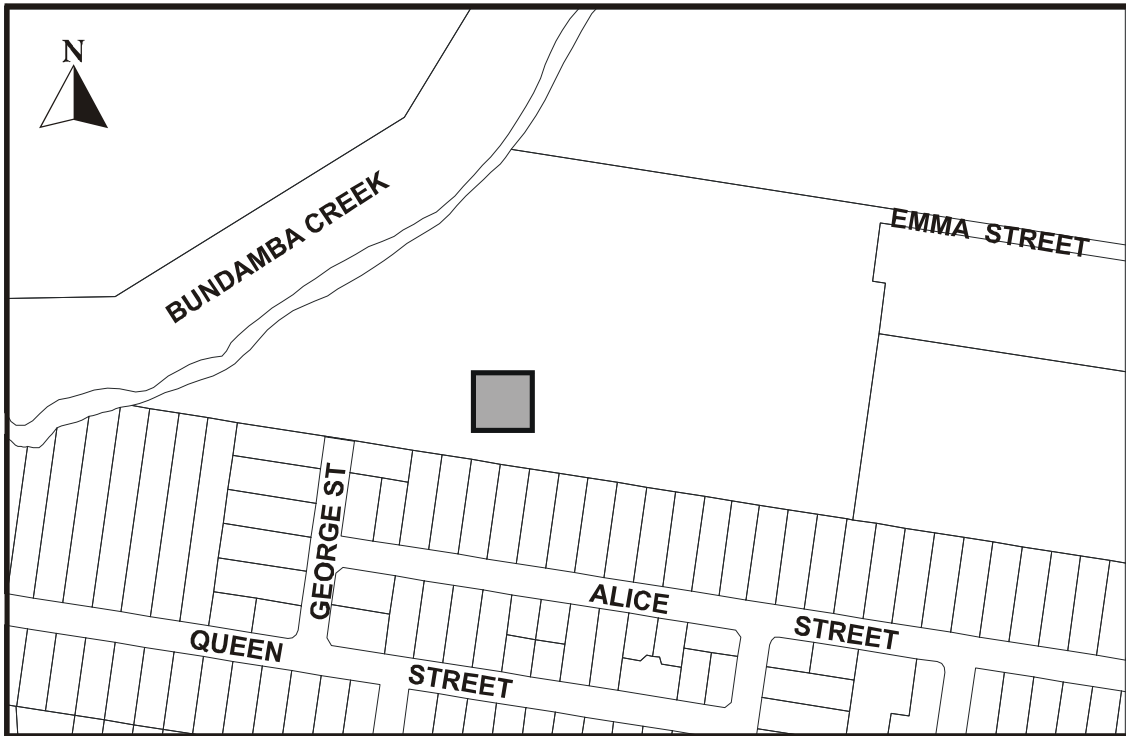

Plan No. 54: 'Indigenous Cultural Heritage Site'

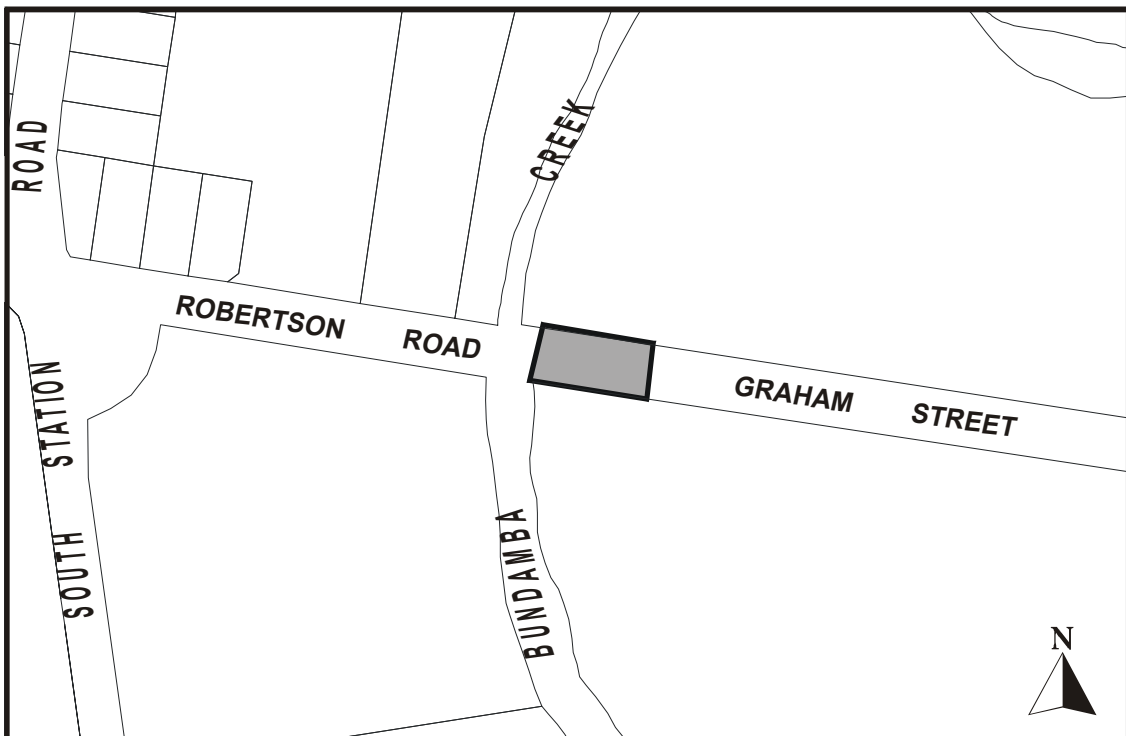

Further details in relation to each site may be obtained from the Ipswich City Council Geographic Information System



Plan No. 55: 'Indigenous Cultural Heritage Site'

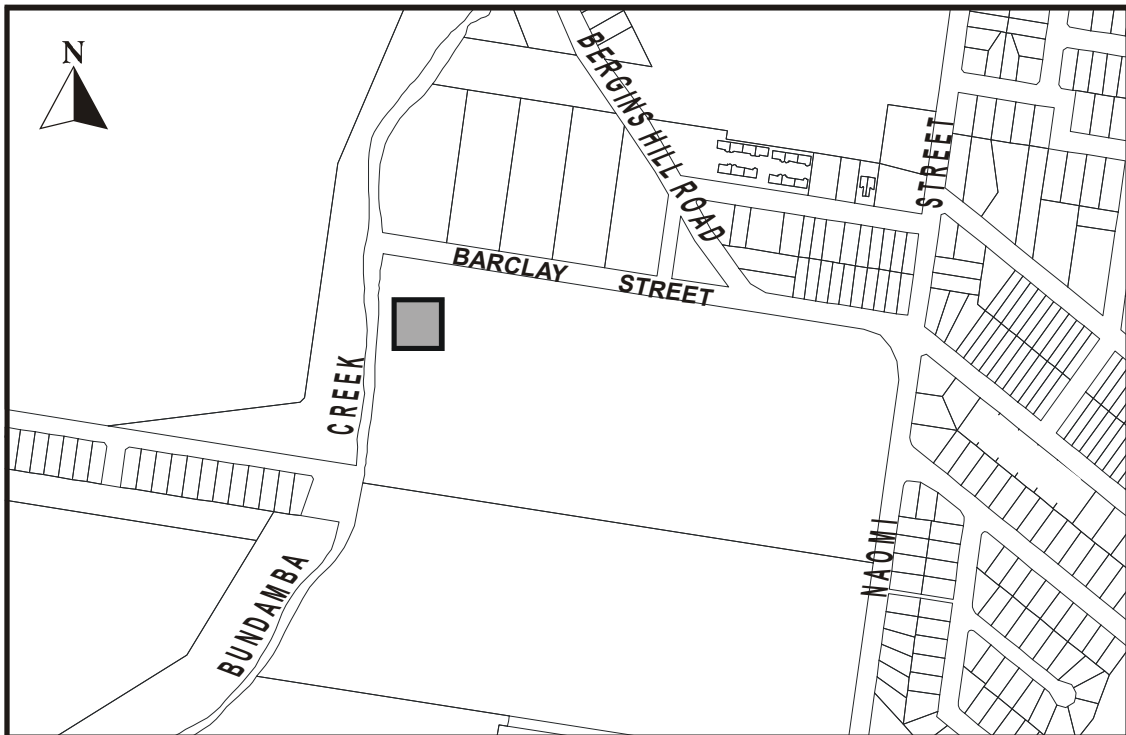

Plan No. 56: 'Indigenous Cultural Heritage Site'

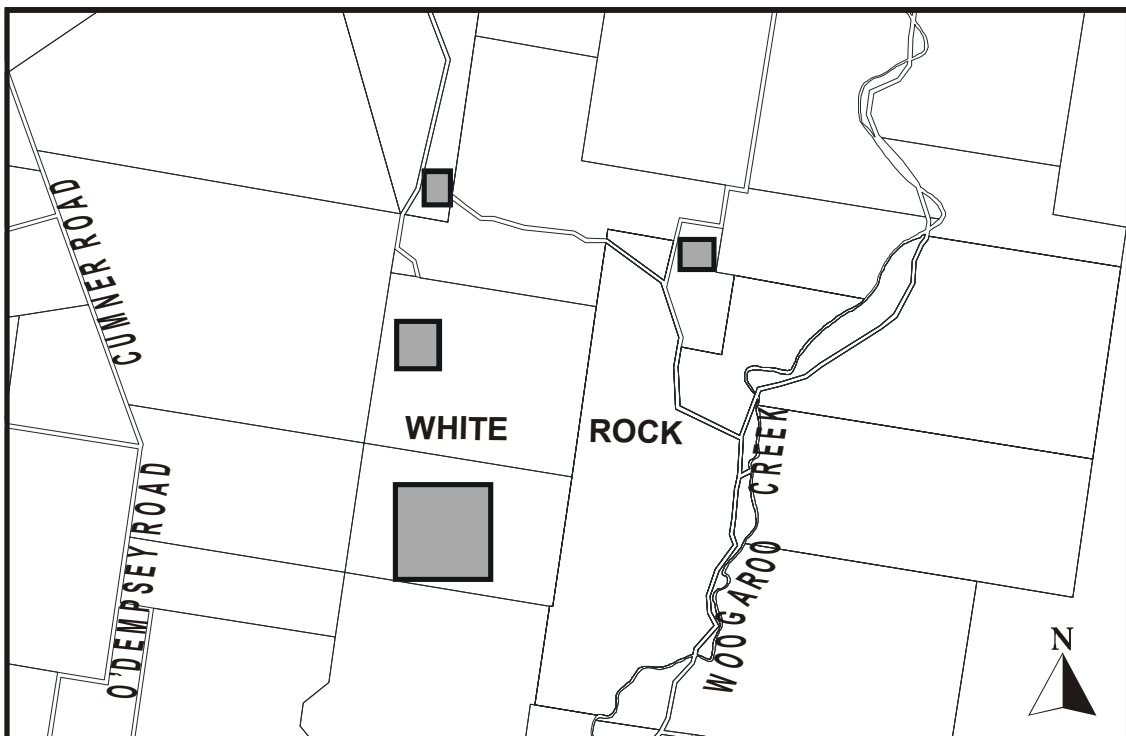

Further details in relation to each site may be obtained from the Ipswich City Council Geographic Information System



Plan No. 57: 'Babies of Walloon Drowning Site'



Further details in relation to each site may be obtained from the Ipswich City Council Geographic Information System

Plan No. 58: 'Forest Red Gum Tree'

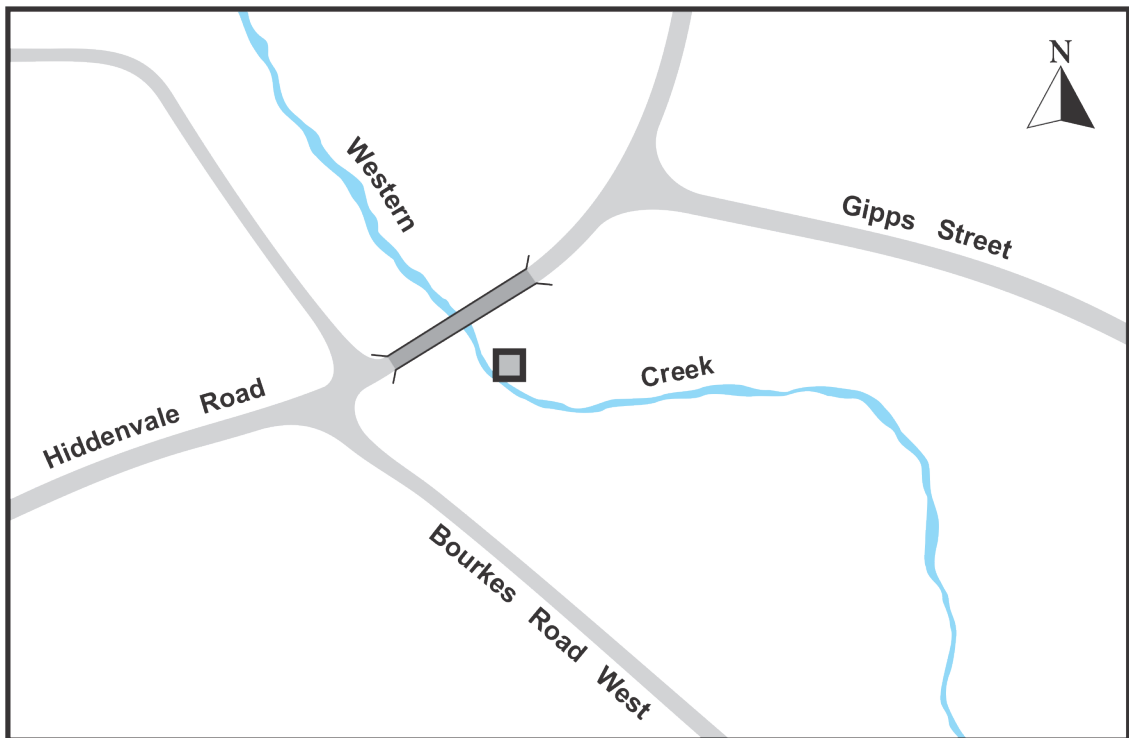

Further details in relation to each site may be obtained from the Ipswich City Council Geographic Information System



Plan No. 59: 'Jacaranda Trees'



Further details in relation to each site may be obtained from the Ipswich City Council Geographic Information System

Plan No. 60: 'Moreton Bay Fig Tree'



Further details in relation to each site may be obtained from the Ipswich City Council Geographic Information System

